

Cage Code: 704Q7

RevNo	Revision note	Date	Signature	Checked
-------	---------------	------	-----------	---------

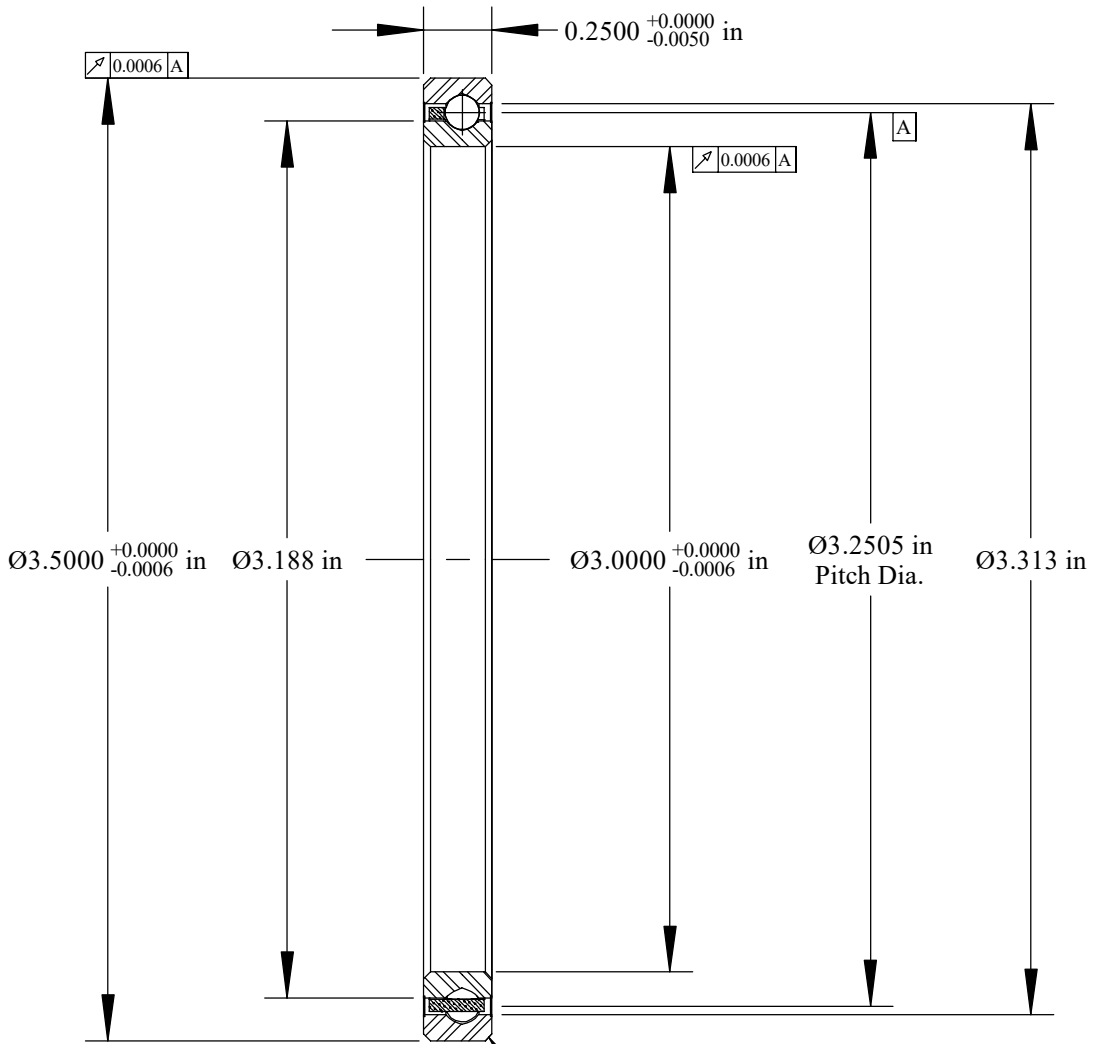

Scale: 1.5:1 Will Clear 0.025
Max. Fillet Radius
4 Exterior Corners

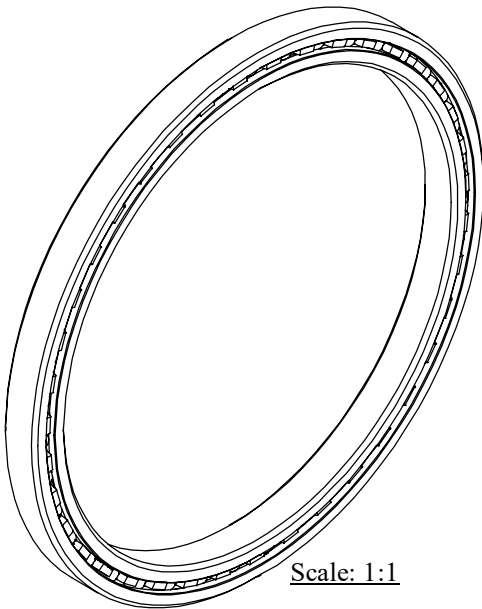

Scale: 1:1

	OUTER	INNER	SEPARATOR	BALL
MATERIAL	52100	52100	BRASS	52100
HARDNESS	Re 59-62	Re 59-62		
RACE RUN-OUT	OUTER	INNER		
ABEC RATING	PRELOAD		ROLLING ELEMENT	
1	N/A		QUANTITY	SIZE
			39	1/8
RADIAL LOAD	THRUST LOAD		MOMENT LOAD	
DYNAMIC: 643 Lbs. STATIC: 990 Lbs.	DYNAMIC: 1010 Lbs. STATIC: 2470 Lbs.		DYNAMIC: 785 Lbs. STATIC: 1600 Lbs.	
RADIAL PLAY	CONTACT ANGLE		LIMITING SPEED	
0.0012 0.0022	N/A		3,300 RPM	
LUBRICATION	SEAL		BEARING WEIGHT	
LIGHT OIL PRESERVATIVE	N/A		0.15 Lbs.	

UNLESS OTHERWISE SPECIFIED ALL DIMENSIONS IN INCHES

Designed by ML	Checked by ML	This drawing and the information contained herein are proprietary and the property of Ritbearing Corporation.
-------------------	------------------	---

RA030XP0

Radial Thin Section
Ball Bearing

File name RA030XP0	Date February 28, 2017	REVISION A	Sheet 1 of 1
-----------------------	---------------------------	---------------	-----------------



Corporate Headquarters
15151 Prater Drive
Covington, GA 30014
(800) 431-1980
www.ritbearing.com