

Cage Code: 704Q7

RevNo	Revision note	Date	Signature	Checked
-------	---------------	------	-----------	---------

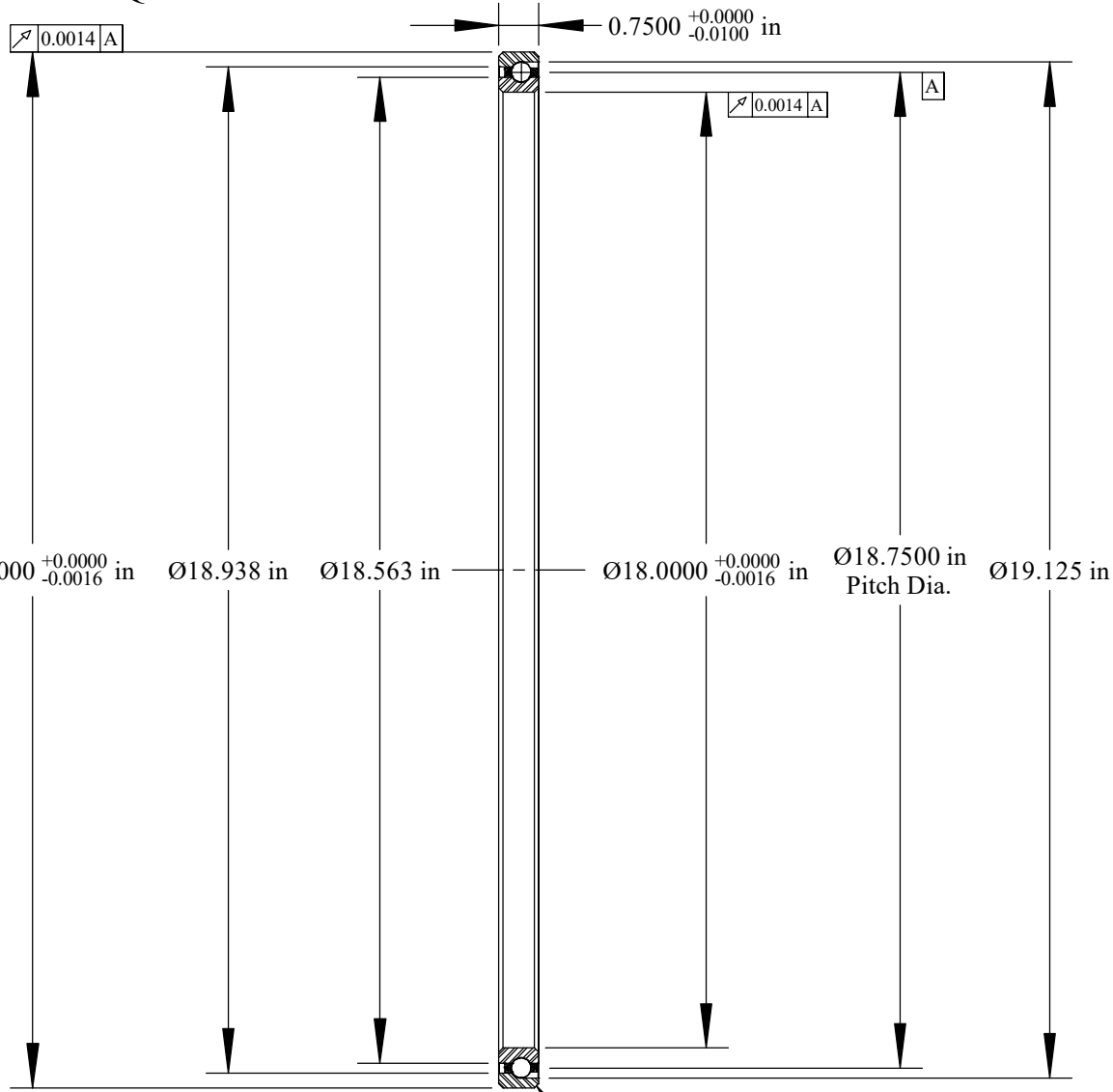

Will Clear 0.080  
Max. Fillet Radius  
4 Exterior Corners  
Scale: 0.3:1

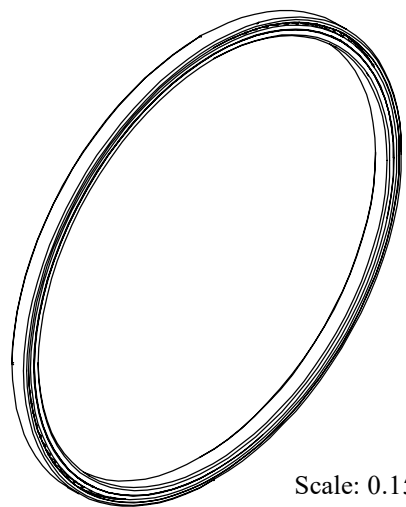

Scale: 0.15:1

	OUTER	INNER	SEPARATOR	BALL
MATERIAL	52100	52100	BRASS	52100
HARDNESS	Rc 59-62	Rc 59-62		
RACE RUN-OUT	OUTER	INNER		
ABEC RATING	PRELOAD		ROLLING ELEMENT	
1	N/A		QUANTITY	SIZE
			104	3/8
RADIAL LOAD		THRUST LOAD		MOMENT LOAD
DYNAMIC: 8103 Lbs. STATIC: 25,410 Lbs.		DYNAMIC: 21,210 Lbs. STATIC: 73,360 Lbs.		N/A
RADIAL PLAY		CONTACT ANGLE		LIMITING SPEED
N/A		30°		833 RPM
LUBRICATION		SEAL		BEARING WEIGHT
LIGHT OIL PRESERVATIVE		N/A		7.67 Lbs.

**SSB**  
thin section bearings

Corporate Headquarters  
15151 Prater Drive  
Covington, GA 30014  
(800) 431-1980  
www.rfbearing.com

UNLESS OTHERWISE SPECIFIED ALL DIMENSIONS IN INCHES

Designed by ML	Checked by ML	This drawing and the information contained herein are proprietary and the property of Rfbearing Corporation.	
<b>RF180AR0</b>		Angular Contact Thin Section Ball Bearing	
File name RF180AR0	Date May 28, 2020	REVISION A	Sheet 1 of 1