

Cage Code: 704Q7

RevNo	Revision note	Date	Signature	Checked
-------	---------------	------	-----------	---------

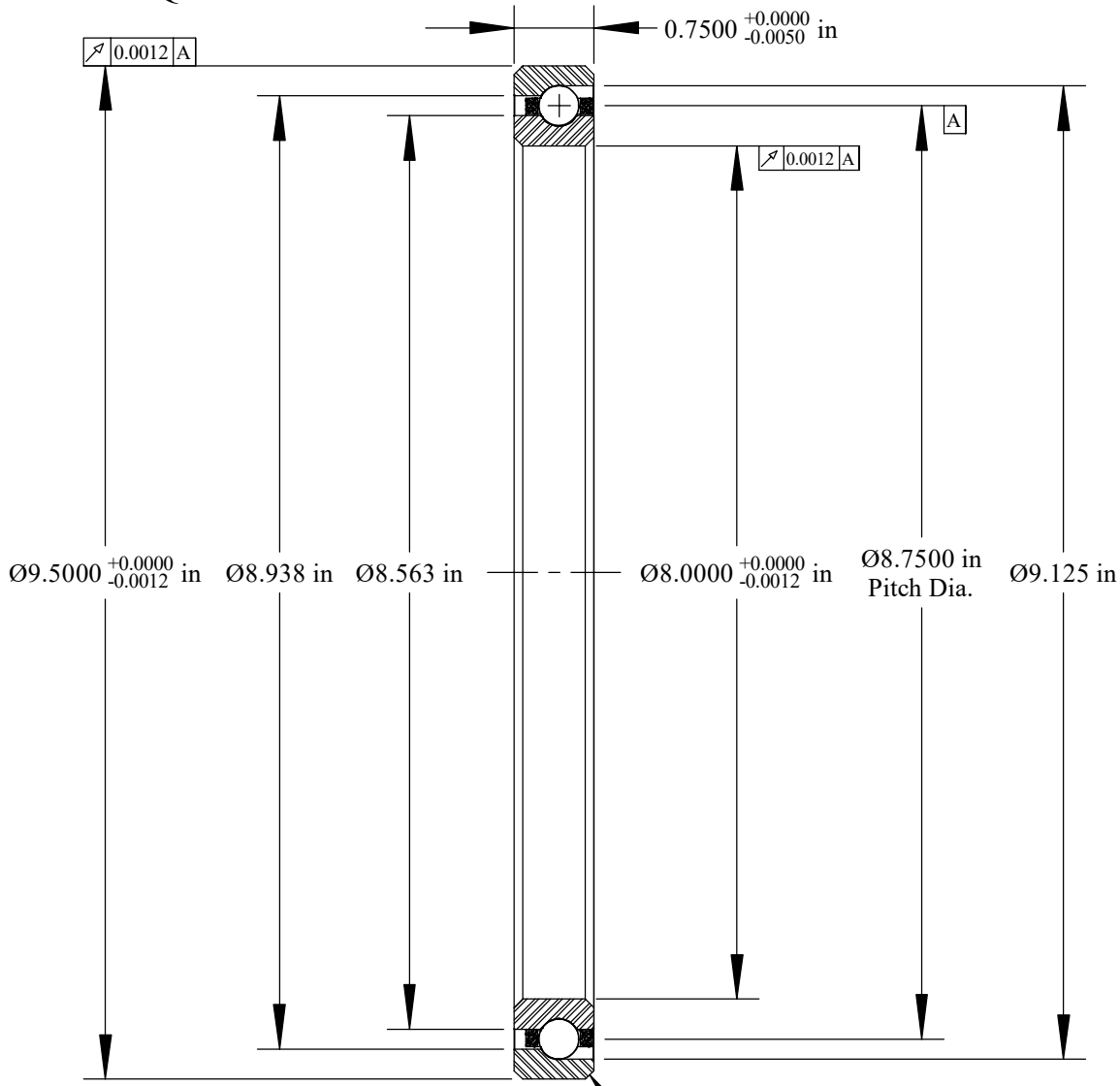

Will Clear 0.080
Max. Fillet Radius
4 Exterior Corners

Scale: 0.6:1

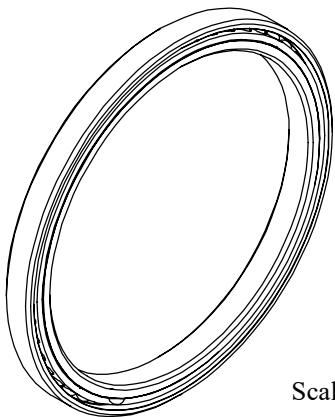

Scale: 0.25:1

	OUTER	INNER	SEPARATOR	BALL
MATERIAL	52100	52100	BRASS	52100
HARDNESS	Rc 59-62	Rc 59-62		
RACE RUN-OUT	OUTER	INNER		
ABEC RATING	PRELOAD		ROLLING ELEMENT	
1	N/A		QUANTITY	SIZE
			48	3/8
RADIAL LOAD	THRUST LOAD		MOMENT LOAD	
DYNAMIC: 5242 Lbs. STATIC: 11,730 Lbs.	DYNAMIC: 12,670 Lbs. STATIC: 33,860 Lbs.		N/A	
RADIAL PLAY	CONTACT ANGLE		LIMITING SPEED	
N/A	30°		2200 RPM	
LUBRICATION	SEAL		BEARING WEIGHT	
LIGHT OIL PRESERVATIVE	N/A		3.61 Lbs.	

UNLESS OTHERWISE SPECIFIED ALL DIMENSIONS IN INCHES

Designed by ML	Checked by ML	This drawing and the information contained herein are proprietary and the property of Ritbearing Corporation.
-------------------	------------------	---

RF080AR0

Angular Contact Thin Section Ball Bearing

File name RF080AR0	Date May 28, 2020	REVISION A	Sheet 1 of 1
-----------------------	----------------------	---------------	-----------------



Corporate Headquarters
15151 Prafer Drive
Covington, GA 30014
(800) 431-1980
www.ritbearing.com