

Cage Code: 704Q7

RevNo	Revision note	Date	Signature	Checked
-------	---------------	------	-----------	---------

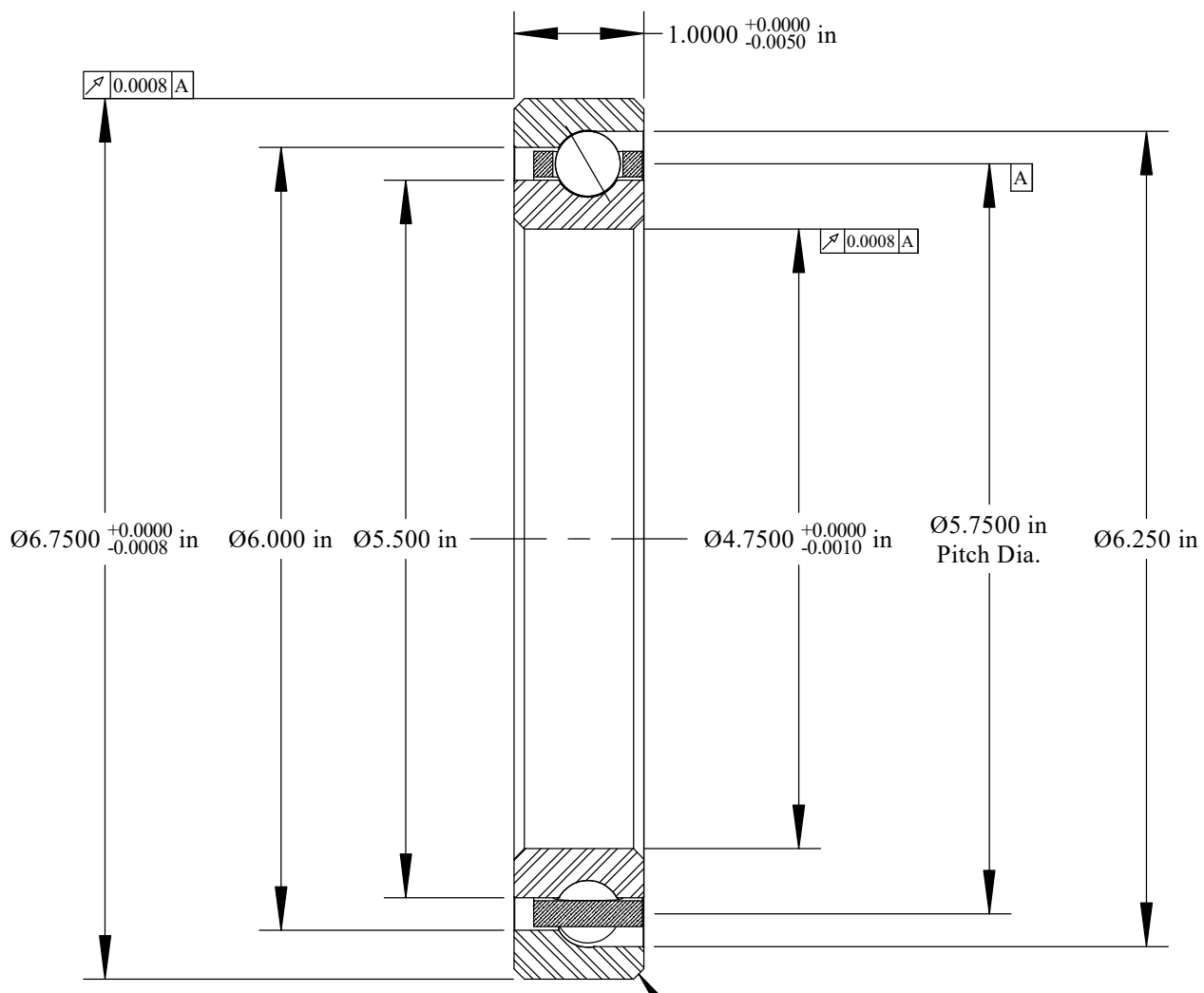

Scale: 0.75:1  
 Will Clear 0.080  
 Max. Fillet Radius  
 4 Exterior Corners

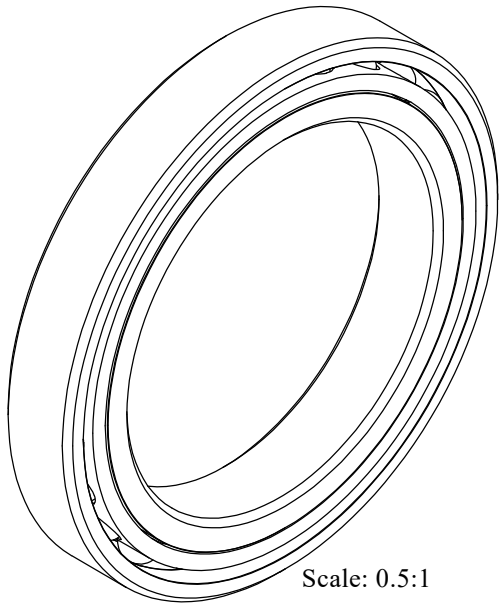

Scale: 0.5:1

	OUTER	INNER	SEPARATOR	BALL
MATERIAL	52100	52100	BRASS	52100
HARDNESS	Rc 59-62	Rc 59-62		
RACE RUN-OUT	OUTER	INNER		
ABEC RATING	PRELOAD		ROLLING ELEMENT	
1	N/A		QUANTITY	SIZE
			23	1/2
RADIAL LOAD	THRUST LOAD		MOMENT LOAD	
DYNAMIC: 6745 Lbs. STATIC: 10,900 Lbs.	DYNAMIC: 14,970 Lbs. STATIC: 31,460 Lbs.		N/A	
RADIAL PLAY	CONTACT ANGLE		LIMITING SPEED	
N/A	30°		4400 RPM	
LUBRICATION	SEAL		BEARING WEIGHT	
LIGHT OIL PRESERVATIVE	N/A		4.17 Lbs.	

UNLESS OTHERWISE SPECIFIED ALL DIMENSIONS IN INCHES

**Corporate Headquarters**  
 15151 Prater Drive  
 Covington, GA 30014  
 (800) 431-1980  
 www.ritbearing.com

Designed by ML	Checked by ML	This drawing and the information contained herein are proprietary and the property of Ritbearing Corporation.	
<b>RG047AR0</b>		Angular Contact Thin Section Ball Bearing	
File name RG047AR0	Date December 16, 2020	REVISION A	Sheet 1 of 1