

Cage Code: 704Q7

RevNo	Revision note	Date	Signature	Checked
-------	---------------	------	-----------	---------

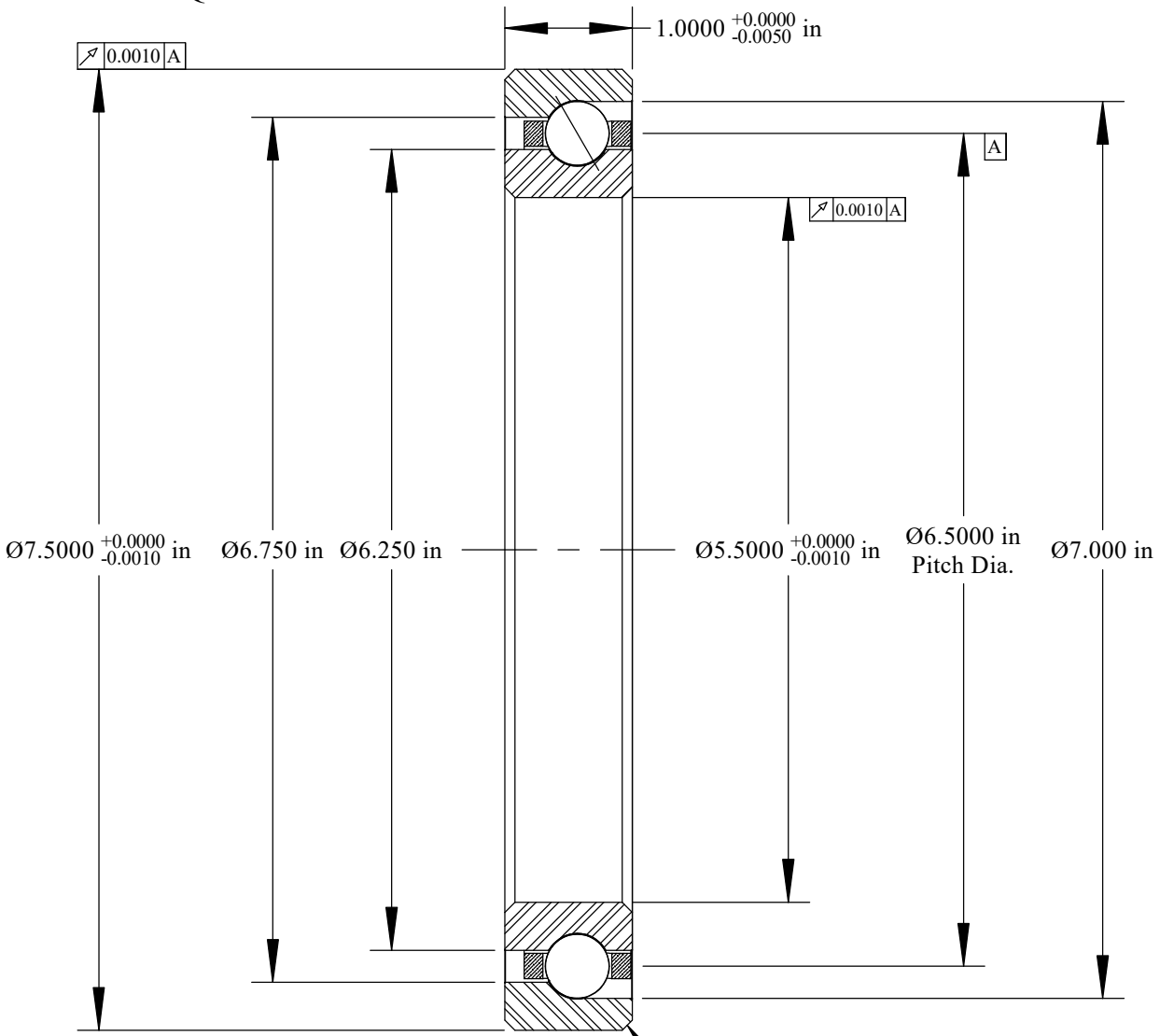

Scale: 0.75:1 Will Clear 0.080 Max. Fillet Radius 4 Exterior Corners

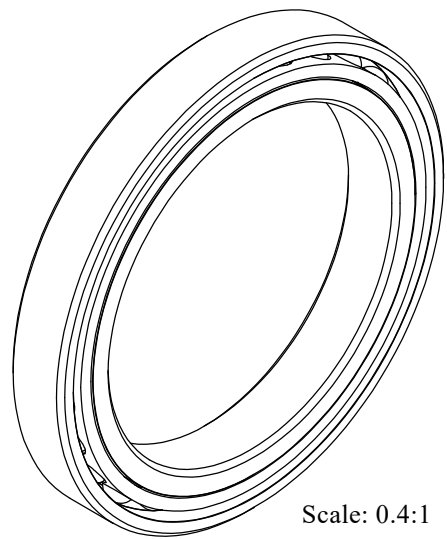

Scale: 0.4:1

	OUTER	INNER	SEPARATOR	BALL
MATERIAL	52100	52100	BRASS	52100
HARDNESS	Rc 59-62	Rc 59-62		
RACE RUN-OUT	OUTER	INNER		
ABEC RATING	PRELOAD		ROLLING ELEMENT	
1	N/A		QUANTITY	SIZE
			26	1/2
RADIAL LOAD	THRUST LOAD		MOMENT LOAD	
DYNAMIC: 7192 Lbs. STATIC: 12,320 Lbs.	DYNAMIC: 16,240 Lbs. STATIC: 35,570 Lbs.		N/A	
RADIAL PLAY	CONTACT ANGLE		LIMITING SPEED	
N/A	30°		3800 RPM	
LUBRICATION	SEAL		BEARING WEIGHT	
LIGHT OIL PRESERVATIVE	N/A		4.73 Lbs.	

UNLESS OTHERWISE SPECIFIED ALL DIMENSIONS IN INCHES

SSD
thin section bearings

Corporate Headquarters
15151 Prater Drive
Covington, GA 30014
(800) 431-1980
www.ritbearing.com

Designed by ML	Checked by ML	This drawing and the information contained herein are proprietary and the property of Ritbearing Corporation.	
RG055AR0		Angular Contact Thin Section Ball Bearing	
File name RG055AR0	Date December 16, 2020	REVISION A	Sheet 1 of 1