

Cage Code: 704Q7

RevNo	Revision note	Date	Signature	Checked
-------	---------------	------	-----------	---------

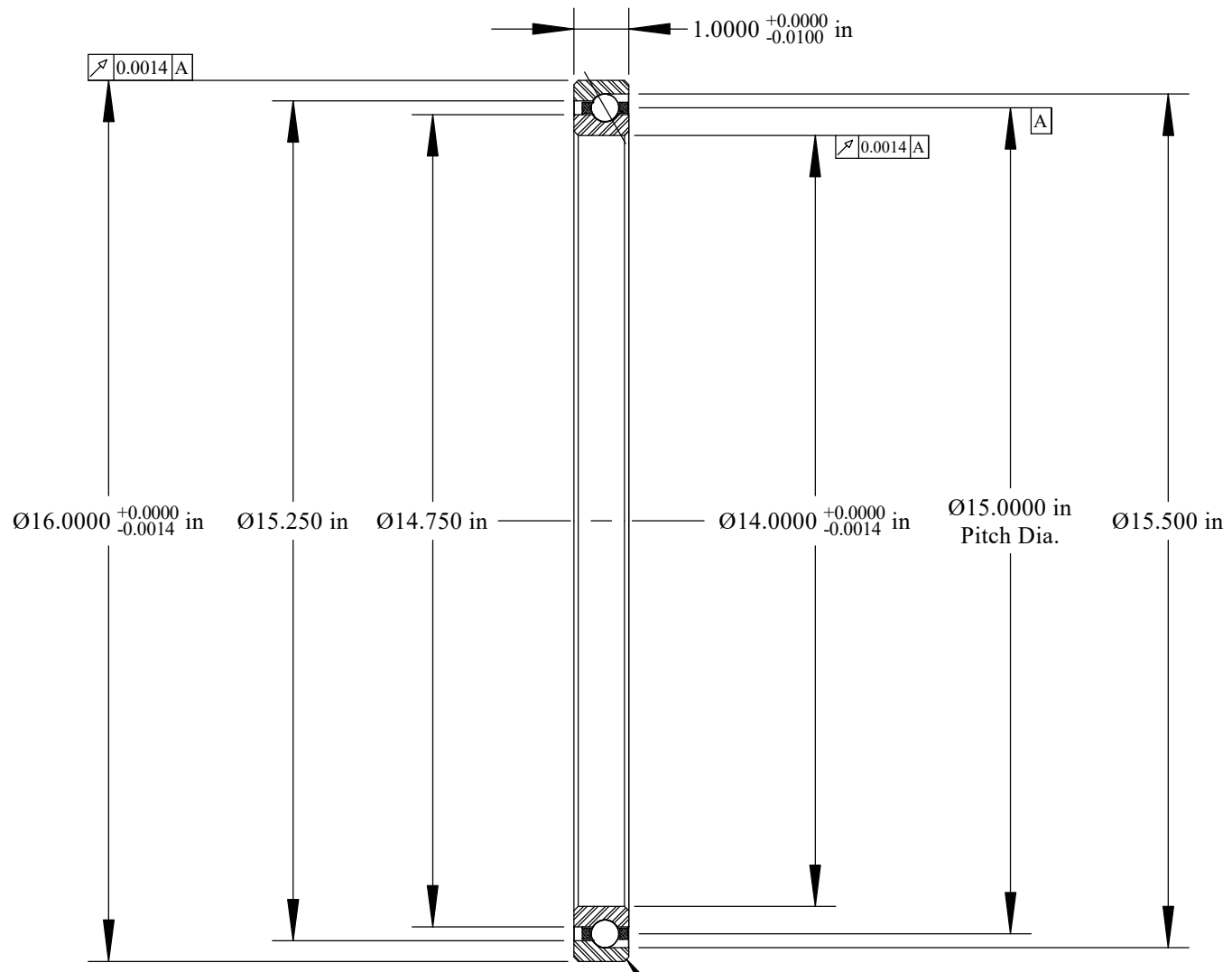

Will Clear 0.080
Max. Fillet Radius
4 Exterior Corners
Scale: 0.3333:1

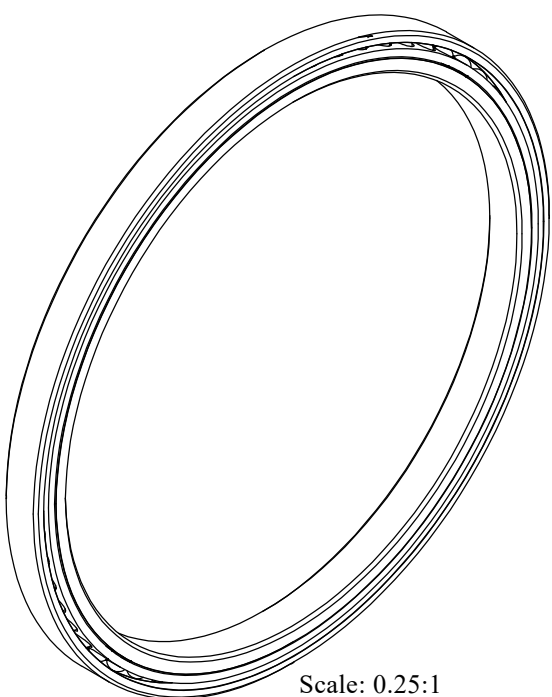

Scale: 0.25:1

	OUTER	INNER	SEPARATOR	BALL
MATERIAL	52100	52100	BRASS	52100
HARDNESS	Rc 59-62	Rc 59-62		
RACE RUN-OUT	OUTER	INNER		
ABEC RATING	PRELOAD		ROLLING ELEMENT	
1	N/A		QUANTITY	SIZE
			60	1/2
RADIAL LOAD	THRUST LOAD		MOMENT LOAD	
DYNAMIC: 11,338 Lbs. STATIC: 28,430 Lbs.	DYNAMIC: 28,360 Lbs. STATIC: 82,080 Lbs.		N/A	
RADIAL PLAY	CONTACT ANGLE		LIMITING SPEED	
N/A	30°		1200 RPM	
LUBRICATION	SEAL		BEARING WEIGHT	
LIGHT OIL PRESERVATIVE	N/A		10.90 Lbs.	

UNLESS OTHERWISE SPECIFIED ALL DIMENSIONS IN INCHES

Designed by ML	Checked by ML	This drawing and the information contained herein are proprietary and the property of Ritbearing Corporation.
-------------------	------------------	---

RG140AR0 Angular Contact Thin Section Ball Bearing

File name RG140AR0	Date February 10, 2021	REVISION A	Sheet 1 of 1
-----------------------	---------------------------	---------------	-----------------

Corporate Headquarters
15151 Prater Drive
Covington, GA 30014
(800) 431-1980
www.ritbearing.com