

Cage Code: 704Q7

RevNo	Revision note	Date	Signature	Checked
-------	---------------	------	-----------	---------

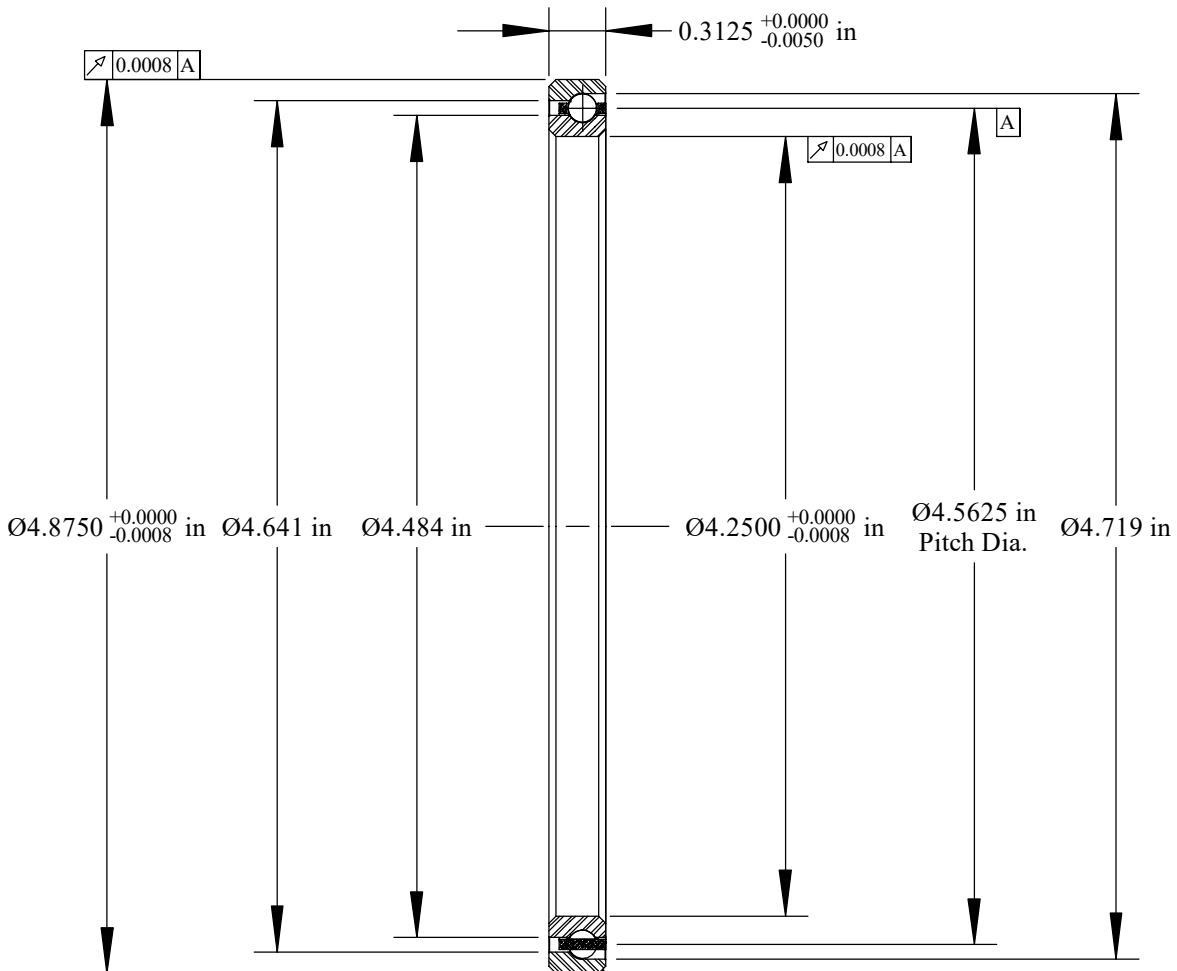

Scale: 1:1
 Will Clear 0.040
 Max. Fillet Radius
 4 Exterior Corners

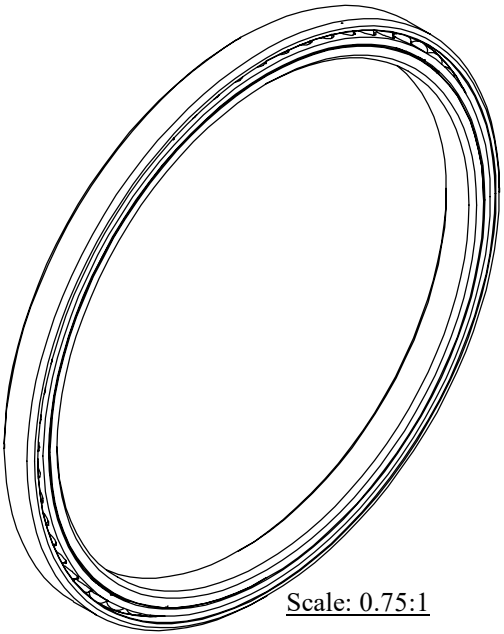

Scale: 0.75:1

	OUTER	INNER	SEPARATOR	BALL
MATERIAL	52100	52100	BRASS	52100
HARDNESS	Re 59-62	Re 59-62		
RACE RUN-OUT	OUTER	INNER		
ABEC RATING	PRELOAD		ROLLING ELEMENT	
1	N/A		QUANTITY	SIZE
			61	5/32
RADIAL LOAD	THRUST LOAD		MOMENT LOAD	
DYNAMIC: 891 Lbs. STATIC: 2150 Lbs.	DYNAMIC: 2170 Lbs. STATIC: 6200 Lbs.		N/A	
RADIAL PLAY	CONTACT ANGLE		LIMITING SPEED	
N/A	30°		4,250 RPM	
LUBRICATION	SEAL		BEARING WEIGHT	
LIGHT OIL PRESERVATIVE	N/A		0.31 Lbs.	

UNLESS OTHERWISE SPECIFIED ALL DIMENSIONS IN INCHES

Designed by ML	Checked by ML	This drawing and the information contained herein are proprietary and the property of Ritbearing Corporation.	
RB042AR0		Angular Contact Thin Section Ball Bearing	
File name RB042AR0	Date April 20, 2020	REVISION A	Sheet 1 of 1

Corporate Headquarters
 15151 Prater Drive
 Covington, GA 30014
 (800) 431-1980
 www.ritbearing.com