

Cage Code: 704Q7

| | | | | |
|-------|---------------|------|-----------|---------|
| RevNo | Revision note | Date | Signature | Checked |
|-------|---------------|------|-----------|---------|

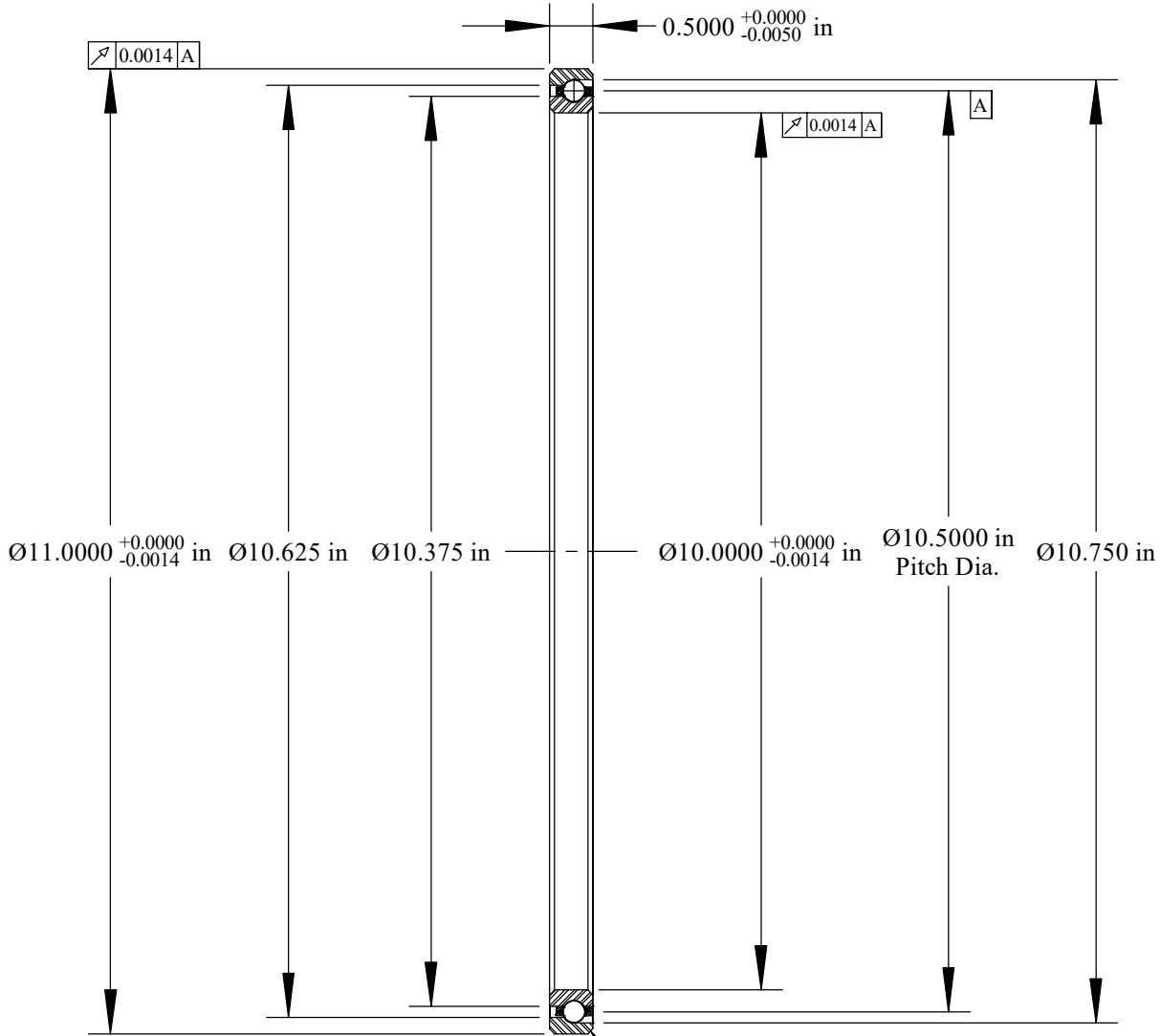

Scale: 0.5:1
 Will Clear 0.060
 Max. Fillet Radius
 4 Exterior Corners

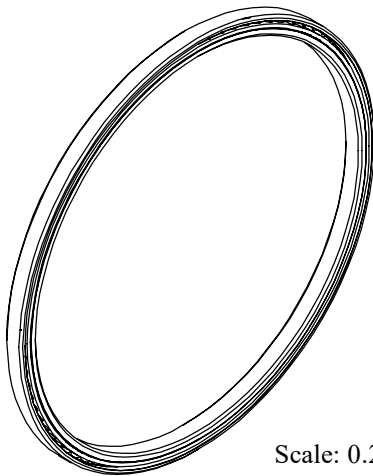

Scale: 0.25:1

| | | | | |
|---|---|----------|-----------------|-------|
| | OUTER | INNER | SEPARATOR | BALL |
| MATERIAL | 52100 | 52100 | BRASS | 52100 |
| HARDNESS | Rc 59-62 | Rc 59-62 | | |
| RACE RUN-OUT | OUTER | INNER | | |
| ABEC RATING | PRELOAD | | ROLLING ELEMENT | |
| 1 | N/A | | QUANTITY | SIZE |
| | | | 84 | 1/4 |
| RADIAL LOAD | THRUST LOAD | | MOMENT LOAD | |
| DYNAMIC: 2972 Lbs. STATIC: 8290 Lbs. | DYNAMIC: 7500 Lbs. STATIC: 23,940 Lbs. | | N/A | |
| RADIAL PLAY | CONTACT ANGLE | | LIMITING SPEED | |
| N/A | 30° | | 1800 RPM | |
| LUBRICATION | SEAL | | BEARING WEIGHT | |
| LIGHT OIL PRESERVATIVE | N/A | | 1.87 Lbs. | |

UNLESS OTHERWISE SPECIFIED ALL DIMENSIONS IN INCHES

| | | |
|-------------------|------------------|---|
| Designed by ML | Checked by ML | This drawing and the information contained herein are proprietary and the property of Ritbearing Corporation. |
|-------------------|------------------|---|

RD100AR0

Angular Contact Thin Section Ball Bearing

| | | | |
|-----------------------|---------------------|---------------|-----------------|
| File name RD100AR0 | Date May 7, 2020 | REVISION A | Sheet 1 of 1 |
|-----------------------|---------------------|---------------|-----------------|



Corporate Headquarters
 15151 Prater Drive
 Covington, GA 30014
 (800) 431-1980
 www.ritbearing.com