

Cage Code: 704Q7

RevNo	Revision note	Date	Signature	Checked
-------	---------------	------	-----------	---------

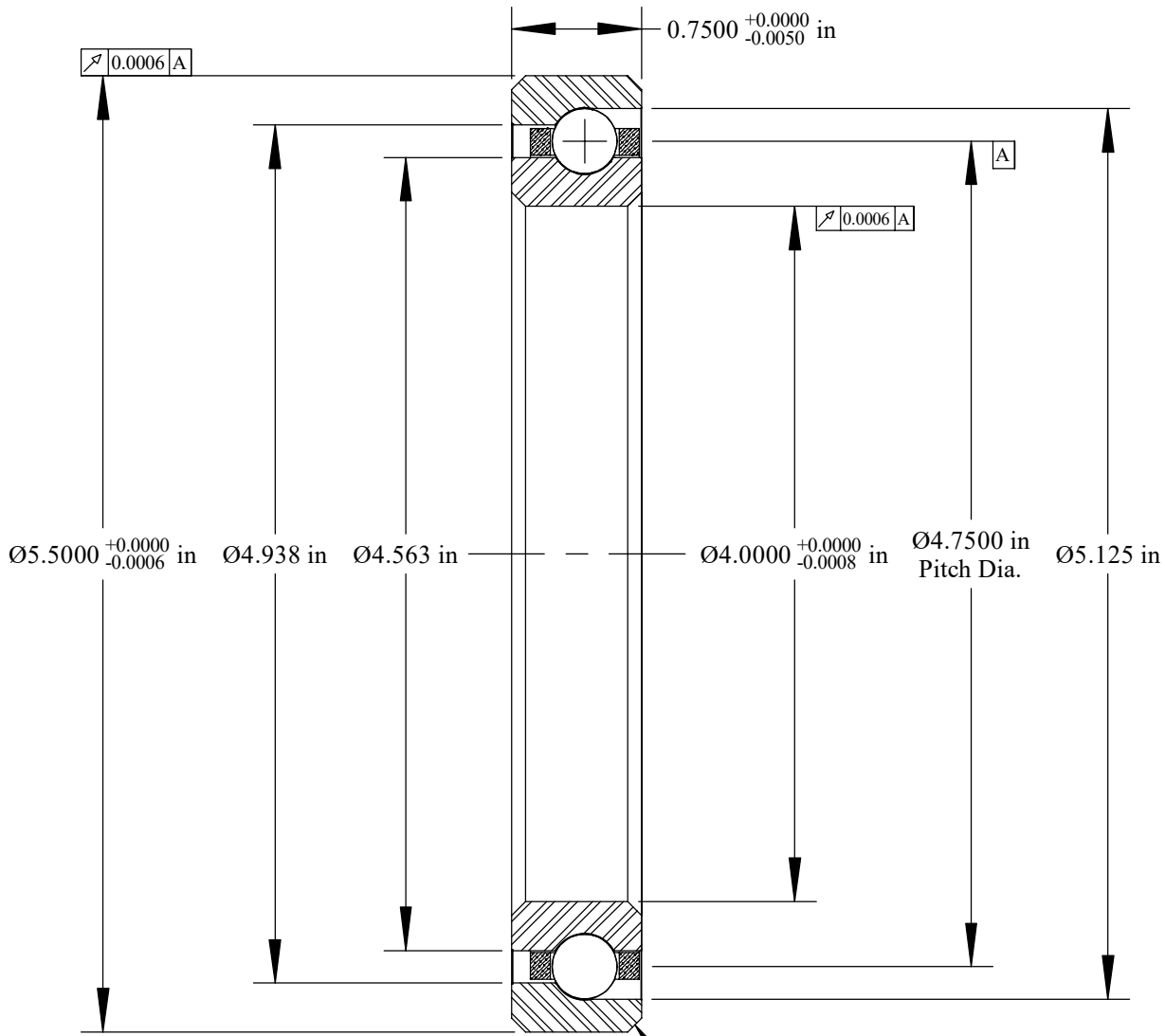

Scale: 1:1
 Will Clear 0.080
 Max. Fillet Radius
 4 Exterior Corners

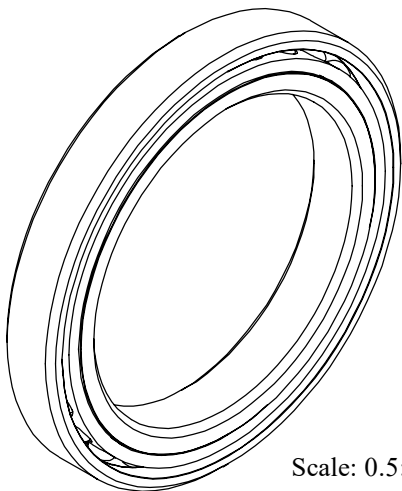

	OUTER	INNER	SEPARATOR	BALL
MATERIAL	52100	52100	BRASS	52100
HARDNESS	Rc 59-62	Rc 59-62		
RACE RUN-OUT	OUTER	INNER		
ABEC RATING	PRELOAD		ROLLING ELEMENT	
1	N/A		QUANTITY	SIZE
			26	3/8
RADIAL LOAD	THRUST LOAD		MOMENT LOAD	
DYNAMIC: 3736 Lbs. STATIC: 6350 Lbs.	DYNAMIC: 8420 Lbs. STATIC: 18,340 Lbs.		N/A	
RADIAL PLAY	CONTACT ANGLE		LIMITING SPEED	
N/A	30°		5250 RPM	
LUBRICATION	SEAL		BEARING WEIGHT	
LIGHT OIL PRESERVATIVE	N/A		1.92 Lbs.	

UNLESS OTHERWISE SPECIFIED ALL DIMENSIONS IN INCHES

Designed by ML	Checked by ML	This drawing and the information contained herein are proprietary and the property of Ritbearing Corporation.
-------------------	------------------	---

RF040AR0

Angular Contact Thin Section Ball Bearing

File name RF040AR0	Date May 11, 2020	REVISION A	Sheet 1 of 1
-----------------------	----------------------	---------------	-----------------



Corporate Headquarters
 15151 Prater Drive
 Covington, GA 30014
 (800) 431-1980
 www.ritbearing.com