

Cage Code: 704Q7

RevNo	Revision note	Date	Signature	Checked
-------	---------------	------	-----------	---------

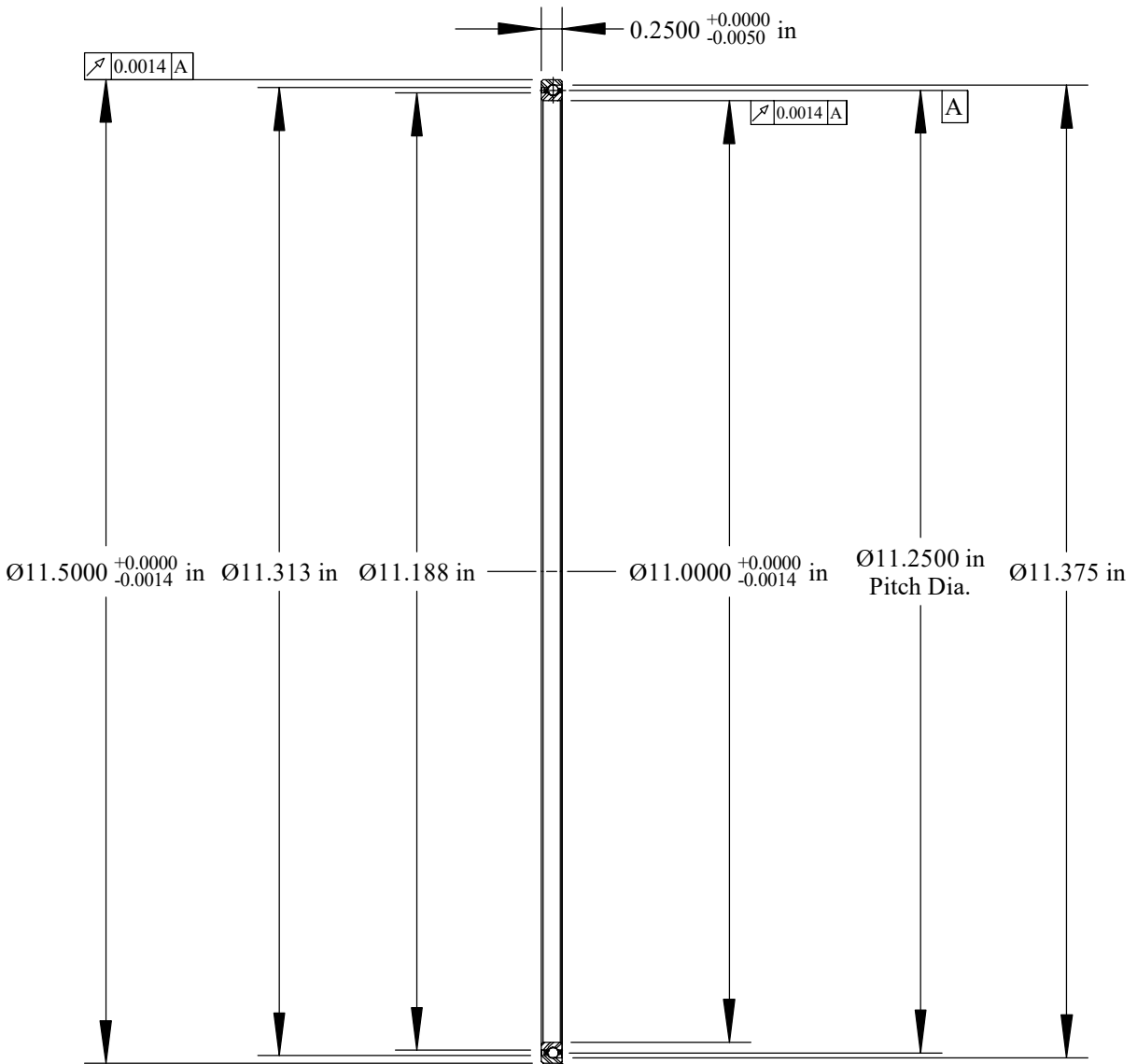

Scale: 0.5:1

Will Clear 0.025
Max. Fillet Radius
4 Exterior Corners

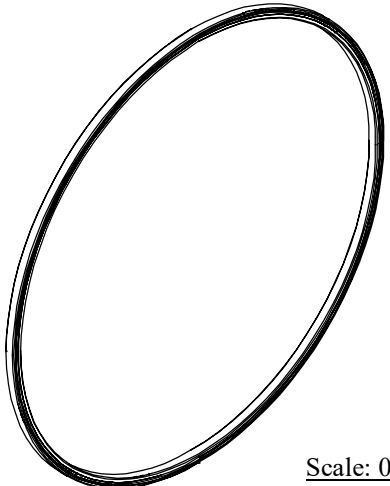

Scale: 0.25:1

	OUTER	INNER	SEPARATOR	BALL
MATERIAL	52100	52100	BRASS	Ceramic
HARDNESS	Rc 59-62	Rc 59-62		
RACE RUN-OUT	OUTER	INNER		
ABEC RATING	PRELOAD		ROLLING ELEMENT	
1	N/A		QUANTITY 180	SIZE 1/8
RADIAL LOAD	THRUST LOAD		MOMENT LOAD	
DYNAMIC: 1072 Lbs. STATIC: 3940 Lbs.	DYNAMIC: 2810 Lbs. STATIC: 11,380 Lbs.		N/A	
AXIAL PRELOAD	CONTACT ANGLE		LIMITING SPEED	
N/A	30°		1,100 RPM	
LUBRICATION	SEAL		BEARING WEIGHT	
LIGHT OIL PRESERVATIVE	N/A		0.50 Lbs.	



Corporate Headquarters
15151 Prater Drive
Covington, GA 30014
(800) 431-1980
www.ritbearing.com

UNLESS OTHERWISE SPECIFIED ALL DIMENSIONS IN INCHES

Designed by ML	Checked by ML	This drawing and the information contained herein are proprietary and the property of Ritbearing Corporation.	
RA110AR0		Angular Contact Thin Section Ball Bearing	
File name RA110AR0	Date March 30, 2020	REVISION A	Sheet 1 of 1