

Cage Code: 704Q7

RevNo	Revision note	Date	Signature	Checked
-------	---------------	------	-----------	---------

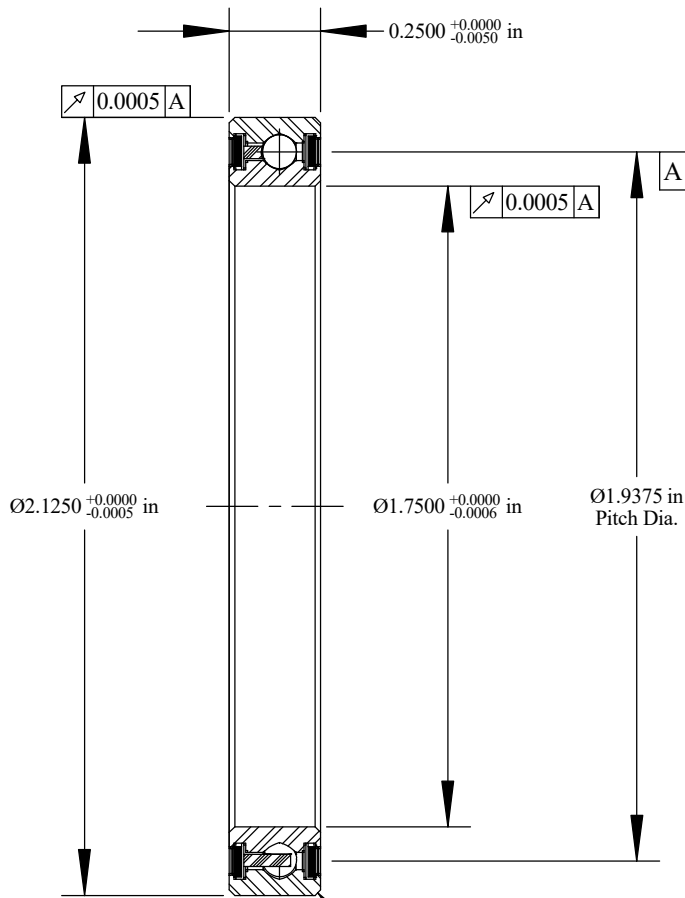

Scale: 2:1  
Will clear 0.015  
Max. Fillet Radius  
4 Exterior Corners

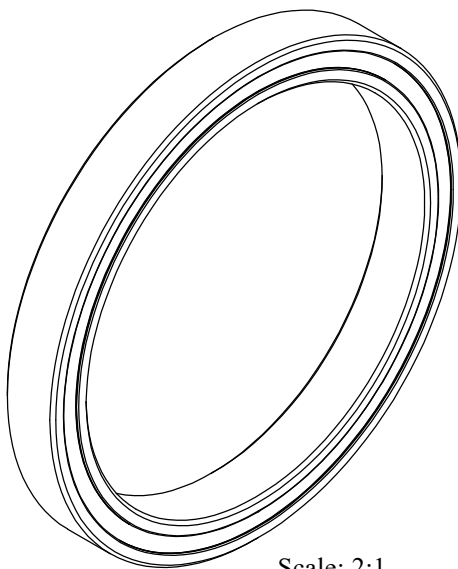

Scale: 2:1

	OUTER	INNER	SEPARATOR	BALL
MATERIAL	52100	52100	BRASS	52100
HARDNESS	Rc 59-62	Rc 59-62		
RACE RUN-OUT	OUTER	INNER		
ABEC RATING	PRELOAD		ROLLING ELEMENT	
1	N/A		QUANTITY	SIZE
			33	3/32
RADIAL LOAD	THRUST LOAD		MOMENT LOAD	
DYNAMIC: 319 Lbs. STATIC: 455 Lbs.	DYNAMIC: 497 Lbs. STATIC: 1140 Lbs.		DYNAMIC: 232 in-Lbs. STATIC: 442 in-Lbs.	
RADIAL PLAY	CONTACT ANGLE		LIMITING SPEED	
0.0012 0.0022	N/A		1710 RPM	
LUBRICATION	SEAL		BEARING WEIGHT	
LIGHT OIL PRESERVATIVE	2 - TEFLON		0.06 Lbs.	

UNLESS OTHERWISE SPECIFIED ALL DIMENSIONS IN INCHES

Designed by ML	Checked by ML	This drawing and the information contained herein are proprietary and the property of Ritbearing Corporation.
-------------------	------------------	---

**RJHA17XL0**

4 Point Contact  
Section Bearing

File name RJHA17XL0	Date March 1, 2017	REVISION A	Sheet 1 of 1
------------------------	-----------------------	---------------	-----------------



**Corporate Headquarters**  
15151 Prater Drive  
Covington, GA 30014  
(800) 431-1980  
www.ritbearing.com