

Cage Code: 704Q7

| | | | | |
|-------|---------------|------|-----------|---------|
| RevNo | Revision note | Date | Signature | Checked |
|-------|---------------|------|-----------|---------|

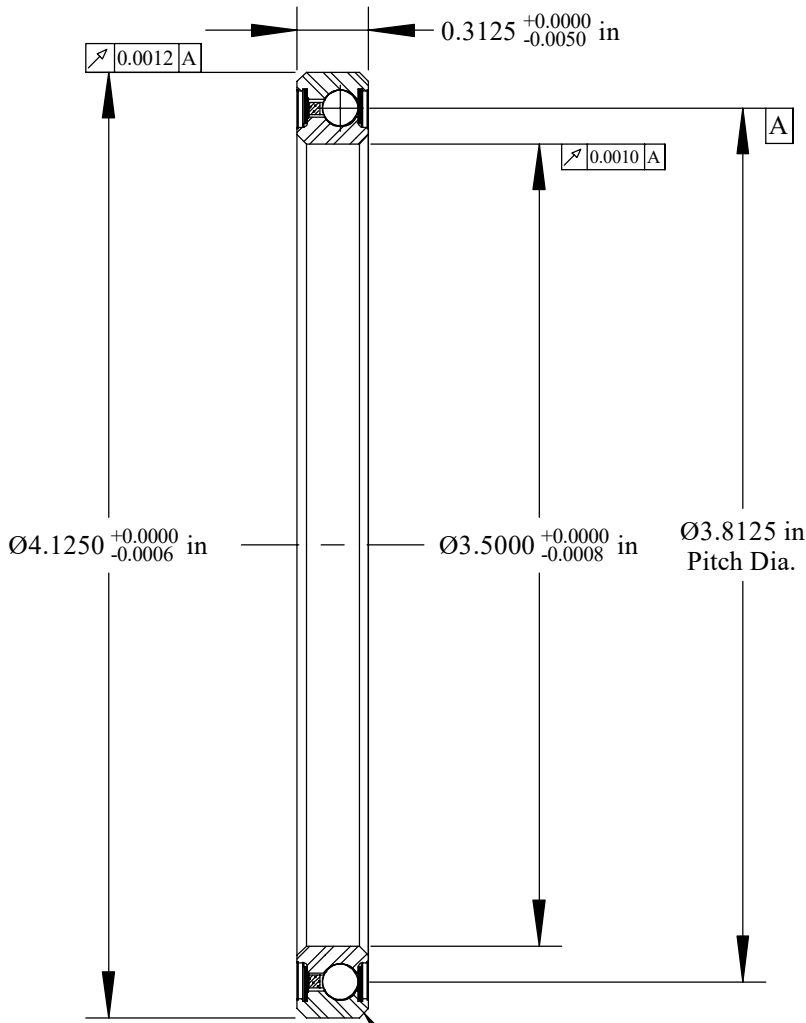

Will Clear 0.040
Max. Fillet Radius
4 Exterior Corners
Scale: 1.25:1

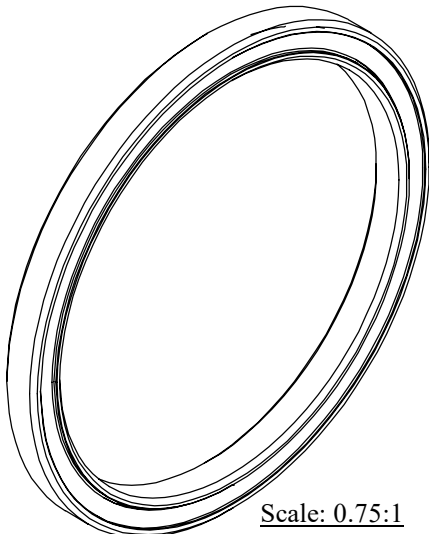

| | | | | |
|--|---------------|----------|-----------------|-------|
| | OUTER | INNER | SEPARATOR | BALL |
| MATERIAL | 52100 | 52100 | BRASS | 52100 |
| HARDNESS | Rc 59-62 | Rc 59-62 | | |
| RACE RUN-OUT | OUTER | INNER | | |
| ABEC RATING | PRELOAD | | ROLLING ELEMENT | |
| 1 | N/A | | QUANTITY | SIZE |
| | | | 38 | 5/32 |
| RADIAL LOAD | THRUST LOAD | | MOMENT LOAD | |
| DYNAMIC: 767 Lbs. STATIC: 1540 Lbs. | N/A | | N/A | |
| RADIAL PLAY | CONTACT ANGLE | | LIMITING SPEED | |
| 0.016 0.028 | N/A | | 1,900 RPM | |
| LUBRICATION | SEAL | | BEARING WEIGHT | |
| Mobil 28 30% Fill | 2 - Teflon | | 0.27 Lbs. | |

UNLESS OTHERWISE SPECIFIED ALL DIMENSIONS IN INCHES

| | | |
|-------------------|------------------|---|
| Designed by ML | Checked by ML | This drawing and the information contained herein are proprietary and the property of Ritbearing Corporation. |
|-------------------|------------------|---|

RJB035CP0

Radial Thin Section
Ball Bearing

| | | | |
|------------------------|---------------------------|---------------|-----------------|
| File name RJB035CP0 | Date November 19, 2019 | REVISION A | Sheet 1 of 1 |
|------------------------|---------------------------|---------------|-----------------|



Corporate Headquarters
15151 Prater Drive
Covington, GA 30014
(800) 431-1980
www.ritbearing.com