

Cage Code: 704Q7

|       |               |      |           |         |
|-------|---------------|------|-----------|---------|
| RevNo | Revision note | Date | Signature | Checked |
|-------|---------------|------|-----------|---------|

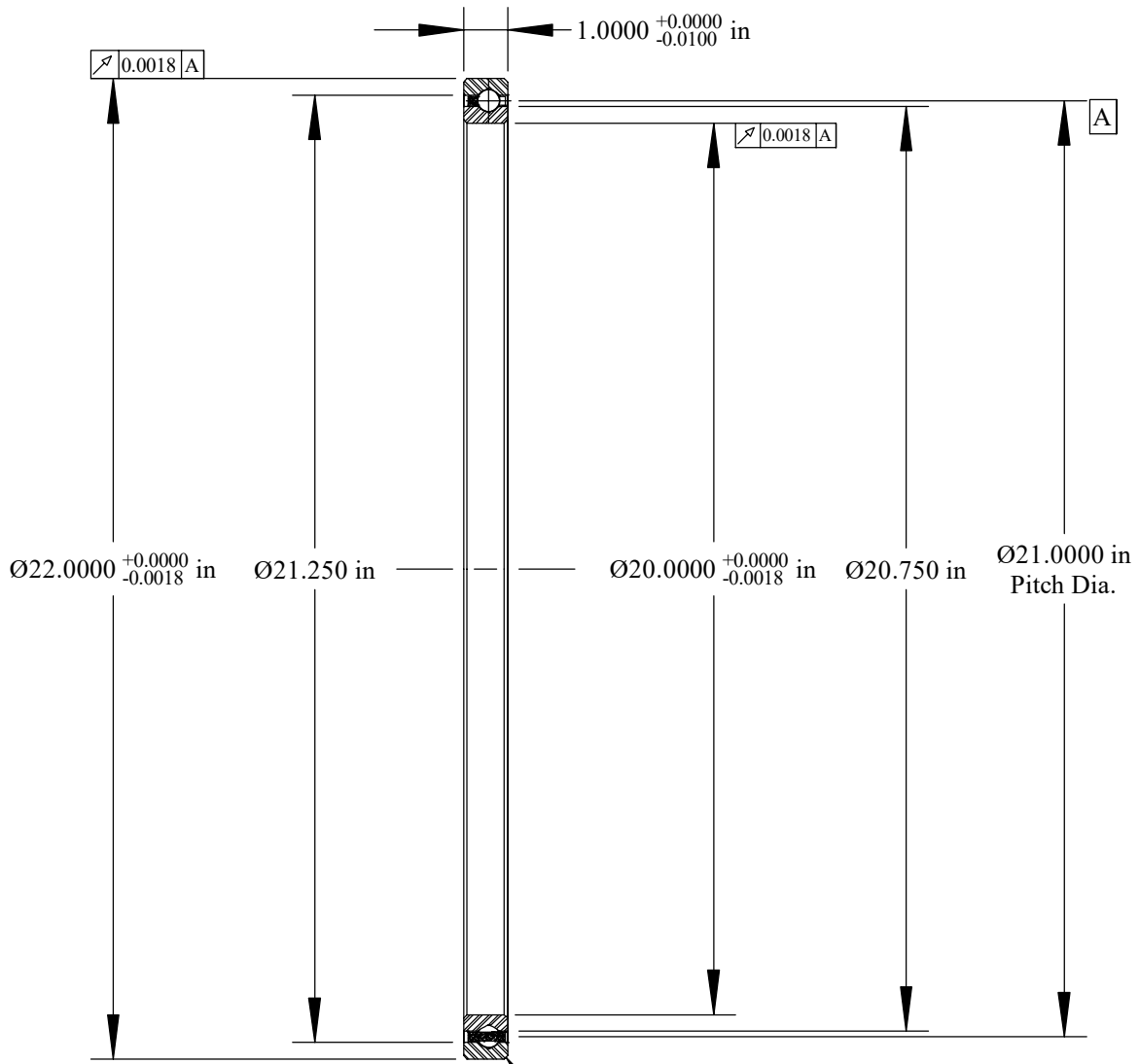

Will Clear 0.080  
Max. Fillet Radius  
4 Exterior Corners  
Scale: 0.25:1

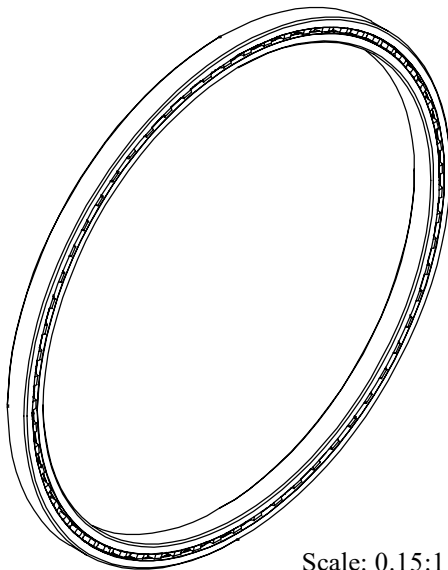

Scale: 0.15:1

|   |   |          |   |             |
|---|---|----------|---|-------------|
|   | OUTER                                       | INNER    | SEPARATOR   | BALL        |
| MATERIAL                                    | 52100                                       | 52100    | BRASS   | 52100       |
| HARDNESS                                    | Re 59-62                                    | Re 59-62 |   |             |
| RACE RUN-OUT                                | OUTER                                       | INNER    |   |             |
| ABEC RATING                                 | PRELOAD                                     |          | ROLLING ELEMENT                                       |             |
| 1   | N/A   |          | QUANTITY<br>63  | SIZE<br>1/2 |
| RADIAL LOAD                                 | THRUST LOAD                                 |          | MOMENT LOAD   |             |
| DYNAMIC: 17,293 Lbs.<br>STATIC: 34,470 Lbs. | DYNAMIC: 29,300 Lbs.<br>STATIC: 86,180 Lbs. |          | DYNAMIC: 136,238 Lbs.-in.<br>STATIC: 362,000 Lbs.-in. |             |
| RADIAL PLAY                                 | CONTACT ANGLE                               |          | LIMITING SPEED  |             |
| 0.0036<br>0.0046                            | N/A   |          | 150 RPM   |             |
| LUBRICATION                                 | SEAL  |          | BEARING WEIGHT  |             |
| LIGHT OIL<br>PRESERVATIVE                   | N/A   |          | 15.80 Lbs.  |             |

UNLESS OTHERWISE SPECIFIED ALL DIMENSIONS IN INCHES

|                   |                  |   |
|-------------------|------------------|---|
| Designed by<br>ML | Checked by<br>ML | This drawing and the information contained herein are proprietary and the property of Ritbearing Corporation. |
|-------------------|------------------|---|

**RG200XP0**

4 Point Contact  
Thin Section  
Ball Bearing

|                       |                        |               |                 |
|-----------------------|------------------------|---------------|-----------------|
| File name<br>RG200XP0 | Date<br>March 25, 2020 | REVISION<br>A | Sheet<br>1 of 1 |
|-----------------------|------------------------|---------------|-----------------|

**Corporate Headquarters**  
15151 Prater Drive  
Covington, GA 30014  
(800) 431-1980  
www.ritbearing.com