

Cage Code: 704Q7

RevNo	Revision note	Date	Signature	Checked
-------	---------------	------	-----------	---------

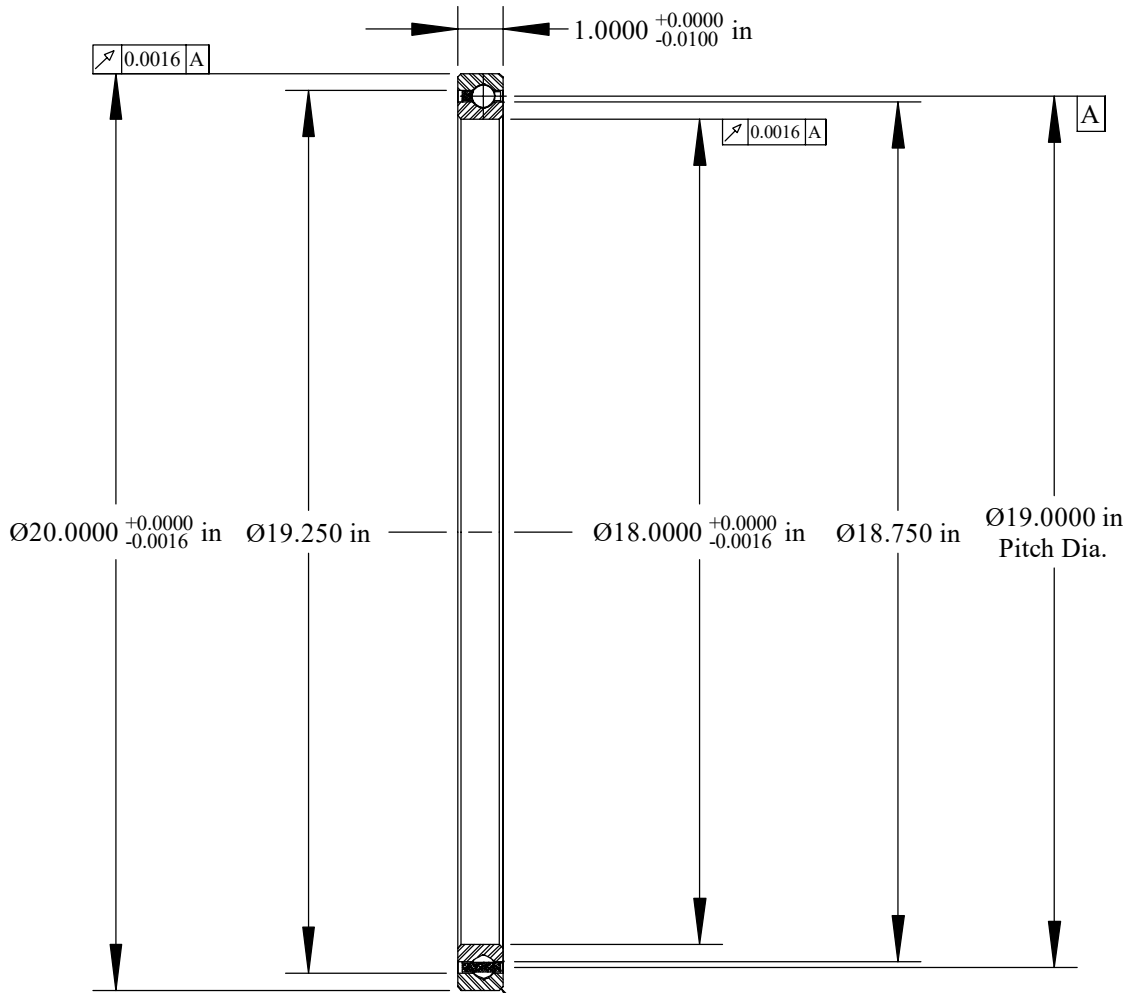

Will Clear 0.080  
Max. Fillet Radius  
4 Exterior Corners  
Scale: 0.25:1

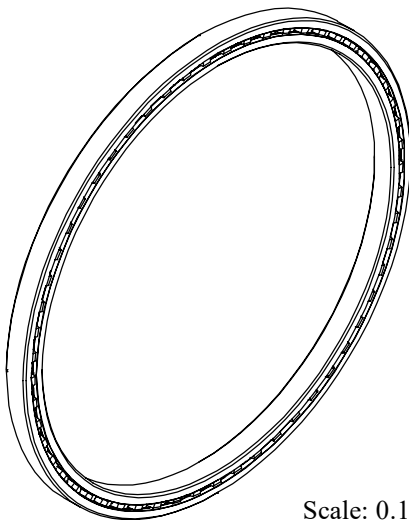

Scale: 0.15:1

	OUTER	INNER	SEPARATOR	BALL
MATERIAL	52100	52100	BRASS	52100
HARDNESS	Rc 59-62	Rc 59-62		
RACE RUN-OUT	OUTER	INNER		
ABEC RATING	PRELOAD		ROLLING ELEMENT	
1	N/A		QUANTITY	SIZE
			57	1/2
RADIAL LOAD	THRUST LOAD		MOMENT LOAD	
DYNAMIC: 16,386 Lbs. STATIC: 34,190 Lbs.	DYNAMIC: 27,410 Lbs. STATIC: 77,980 Lbs.		DYNAMIC: 116,793 Lbs.-in. STATIC: 362,300 Lbs.-in.	
RADIAL PLAY	CONTACT ANGLE		LIMITING SPEED	
0.0032 0.0042	N/A		190 RPM	
LUBRICATION	SEAL		BEARING WEIGHT	
LIGHT OIL PRESERVATIVE	N/A		13.70 Lbs.	

  
**Corporate Headquarters**  
**15151 Prater Drive**  
**Covington, GA 30014**  
**(800) 431-1980**  
**www.ritbearing.com**

UNLESS OTHERWISE SPECIFIED ALL DIMENSIONS IN INCHES

Designed by ML	Checked by ML	This drawing and the information contained herein are proprietary and the property of Ritbearing Corporation.	
<b>RG180XP0</b>		4 Point Contact Thin Section Ball Bearing	
File name RG180XP0	Date March 25, 2020	REVISION A	Sheet 1 of 1