

Cage Code: 704Q7

RevNo	Revision note	Date	Signature	Checked
-------	---------------	------	-----------	---------

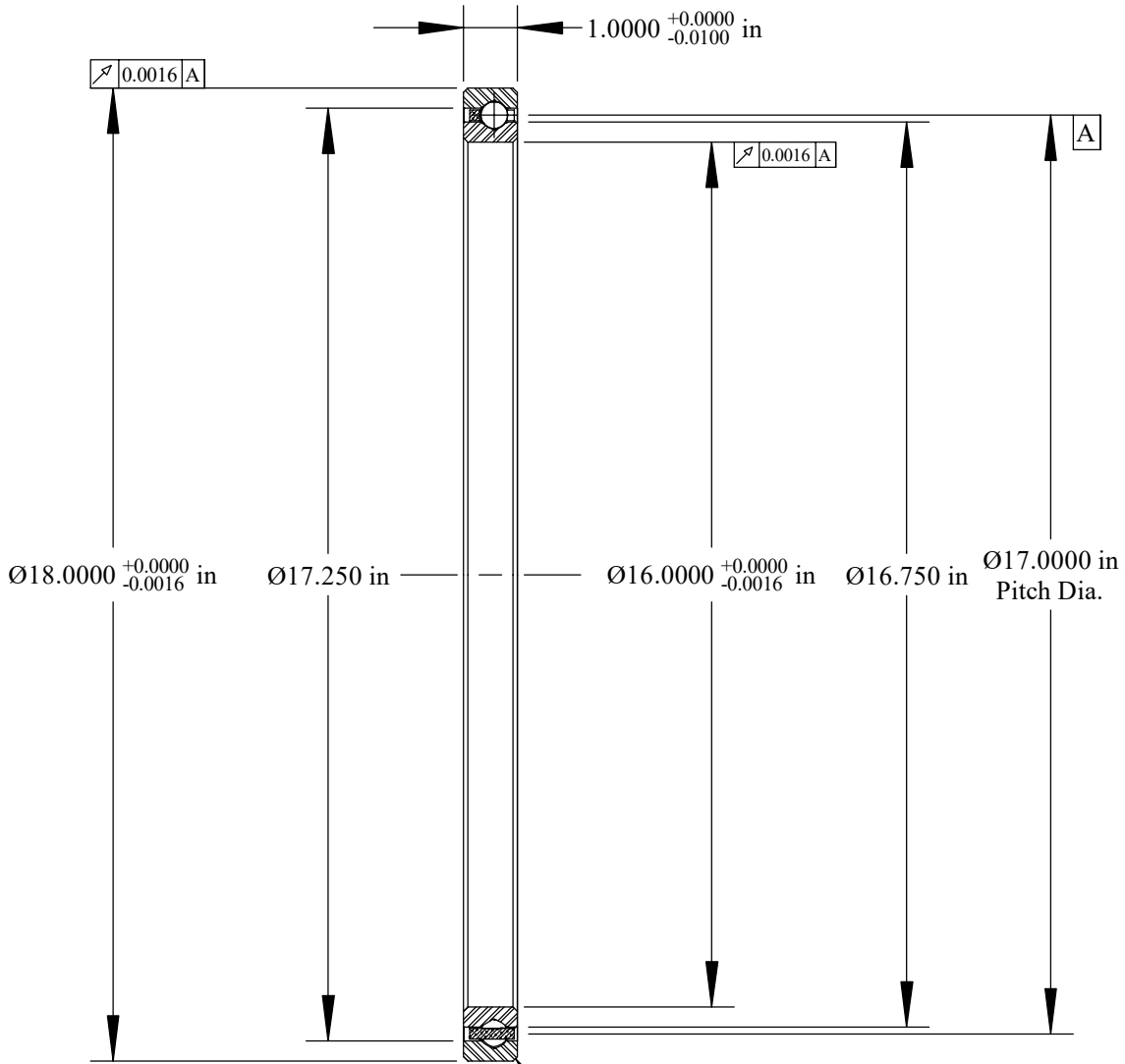

Scale: 0.3:1
 Will Clear 0.080
 Max. Fillet Radius
 4 Exterior Corners

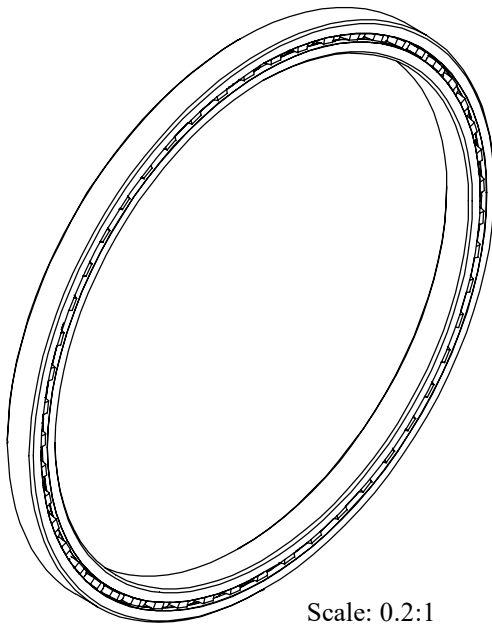

Scale: 0.2:1

	OUTER	INNER	SEPARATOR	BALL
MATERIAL	52100	52100	BRASS	52100
HARDNESS	Re 59-62	Re 59-62		
RACE RUN-OUT	OUTER	INNER		
ABEC RATING	PRELOAD		ROLLING ELEMENT	
1	N/A		QUANTITY	SIZE
			51	1/2
RADIAL LOAD	THRUST LOAD		MOMENT LOAD	
DYNAMIC: 15,425 Lbs. STATIC: 27,910 Lbs.	DYNAMIC: 25,450 Lbs. STATIC: 69,770 Lbs.		DYNAMIC: 98,373 Lbs.-in. STATIC: 237,200 Lbs.-in.	
RADIAL PLAY	CONTACT ANGLE		LIMITING SPEED	
0.0032 0.0042	N/A		200 RPM	
LUBRICATION	SEAL		BEARING WEIGHT	
LIGHT OIL PRESERVATIVE	N/A		12.30 Lbs.	

UNLESS OTHERWISE SPECIFIED ALL DIMENSIONS IN INCHES

Designed by ML	Checked by ML	This drawing and the information contained herein are proprietary and the property of Ritbearing Corporation.
-------------------	------------------	---

RG160XP0

4 Point Contact
Thin Section
Ball Bearing

File name RG160XP0	Date March 25, 2020	REVISION A	Sheet 1 of 1
-----------------------	------------------------	---------------	-----------------

Corporate Headquarters
 15151 Prater Drive
 Covington, GA 30014
 (800) 431-1980
 www.ritbearing.com