

Cage Code: 704Q7

RevNo	Revision note	Date	Signature	Checked
-------	---------------	------	-----------	---------

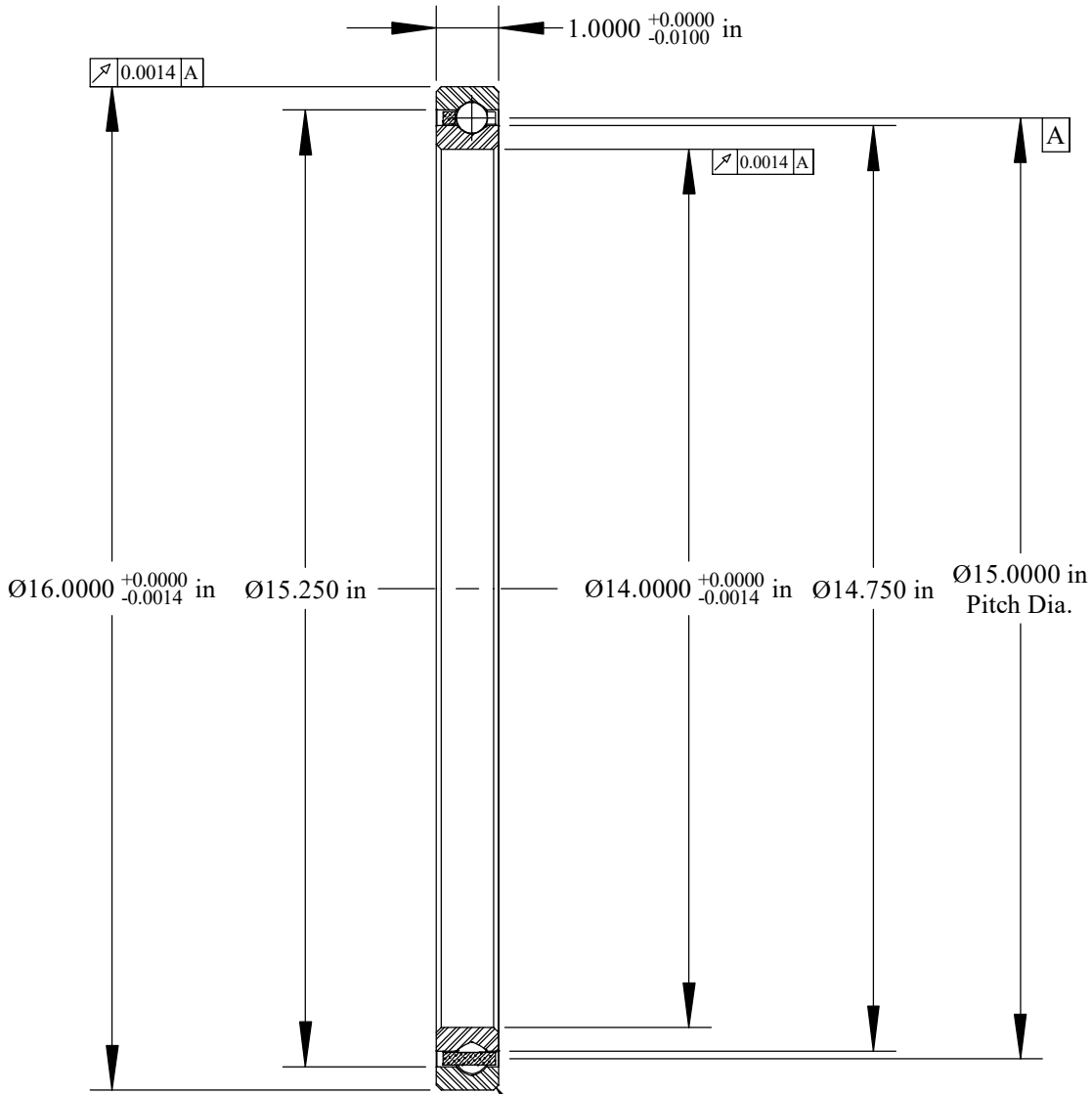

Will Clear 0.080
Max. Fillet Radius
4 Exterior Corners

Scale: 0.35:1

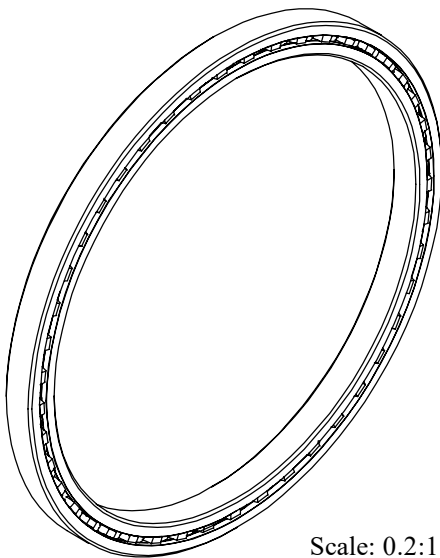

Scale: 0.2:1

	OUTER	INNER	SEPARATOR	BALL
MATERIAL	52100	52100	BRASS	52100
HARDNESS	Re 59-62	Re 59-62		
RACE RUN-OUT	OUTER	INNER		
ABEC RATING	PRELOAD		ROLLING ELEMENT	
1	N/A		QUANTITY	SIZE
			45	1/2
RADIAL LOAD	THRUST LOAD		MOMENT LOAD	
DYNAMIC: 14,404 Lbs. STATIC: 24,620 Lbs.	DYNAMIC: 23,410 Lbs. STATIC: 61,560 Lbs.		DYNAMIC: 81,056 Lbs.-in. STATIC: 184,700 Lbs.-in.	
RADIAL PLAY	CONTACT ANGLE		LIMITING SPEED	
0.0028 0.0038	N/A		250 RPM	
LUBRICATION	SEAL		BEARING WEIGHT	
LIGHT OIL PRESERVATIVE	N/A		10.80 Lbs.	

UNLESS OTHERWISE SPECIFIED ALL DIMENSIONS IN INCHES

Designed by ML	Checked by ML	This drawing and the information contained herein are proprietary and the property of Ritbearing Corporation.
-------------------	------------------	---

RG140XP0

4 Point Contact
Thin Section
Ball Bearing

File name RG140XP0	Date March 25, 2020	REVISION A	Sheet 1 of 1
-----------------------	------------------------	---------------	-----------------



Corporate Headquarters
15151 Prater Drive
Covington, GA 30014
(800) 431-1980
www.ritbearing.com