

Cage Code: 704Q7

RevNo	Revision note	Date	Signature	Checked
-------	---------------	------	-----------	---------

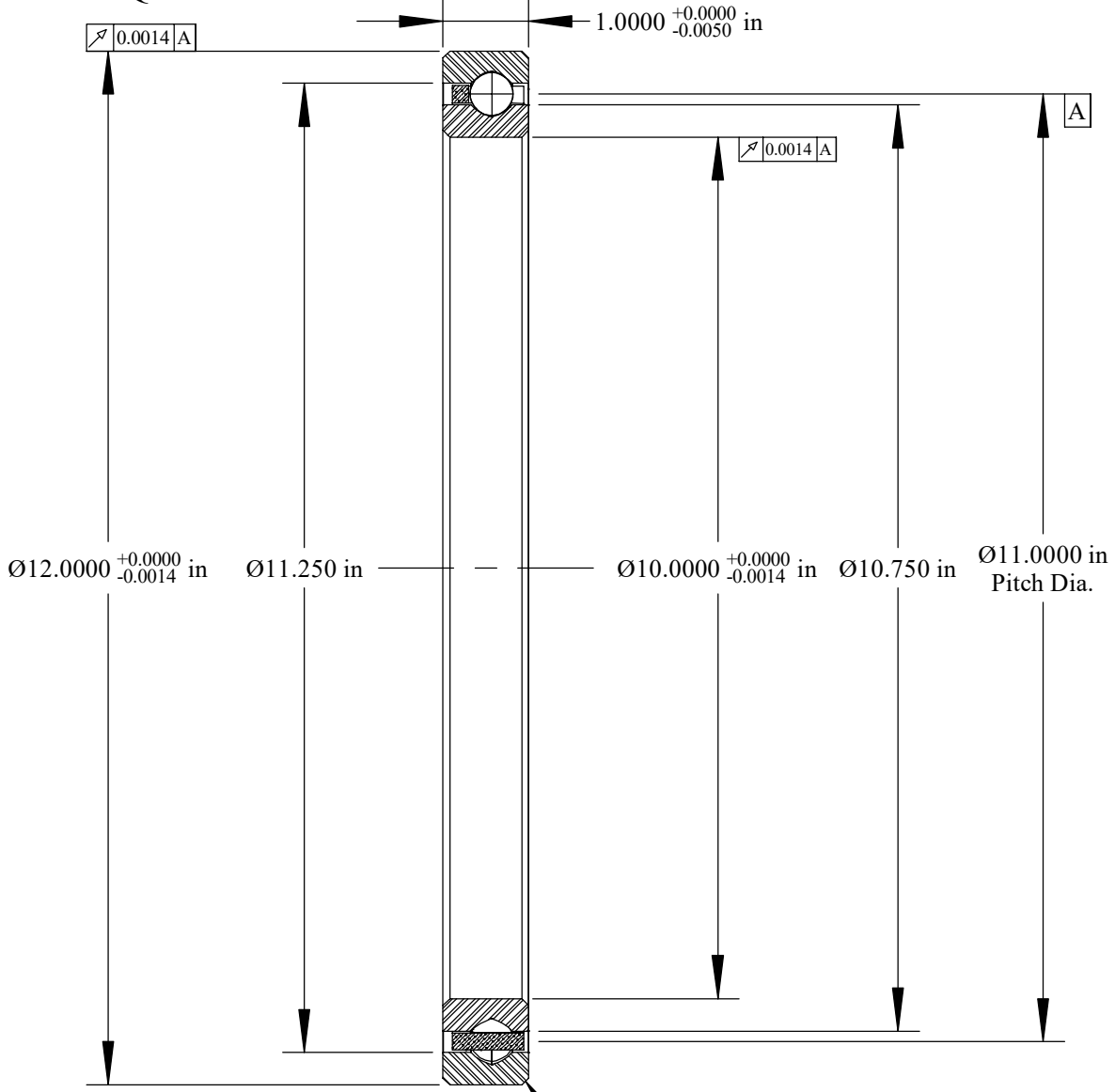

Will Clear 0.080
Max. Fillet Radius
4 Exterior Corners

Scale: 0.5:1

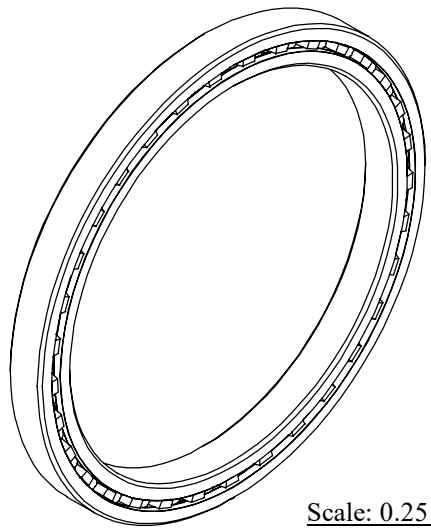

Scale: 0.25:1

	OUTER	INNER	SEPARATOR	BALL
MATERIAL	52100	52100	BRASS	52100
HARDNESS	Rc 59-62	Rc 59-62		
RACE RUN-OUT	OUTER	INNER		
ABEC RATING	PRELOAD		ROLLING ELEMENT	
1	N/A		QUANTITY	SIZE
			33	1/2
RADIAL LOAD	THRUST LOAD		MOMENT LOAD	
DYNAMIC: 12,147 Lbs. STATIC: 18,060 Lbs.	DYNAMIC: 19,040 Lbs. STATIC: 45,140 Lbs.		DYNAMIC: 50,124 Lbs.-in. STATIC: 99,320 Lbs.-in.	
RADIAL PLAY	CONTACT ANGLE		LIMITING SPEED	
0.0028 0.0038	N/A		350 RPM	
LUBRICATION	SEAL		BEARING WEIGHT	
LIGHT OIL PRESERVATIVE	N/A		7.90 Lbs.	

UNLESS OTHERWISE SPECIFIED ALL DIMENSIONS IN INCHES

Designed by ML	Checked by ML	This drawing and the information contained herein are proprietary and the property of Ritbearing Corporation.
-------------------	------------------	---

RG100XP0 4 Point Contact Thin Section Ball Bearing

File name RG100XP0	Date March 25, 2020	REVISION A	Sheet 1 of 1
-----------------------	------------------------	---------------	-----------------

Corporate Headquarters
15151 Prater Drive
Covington, GA 30014
(800) 431-1980
www.ritbearing.com