

Cage Code: 704Q7

RevNo	Revision note	Date	Signature	Checked
-------	---------------	------	-----------	---------

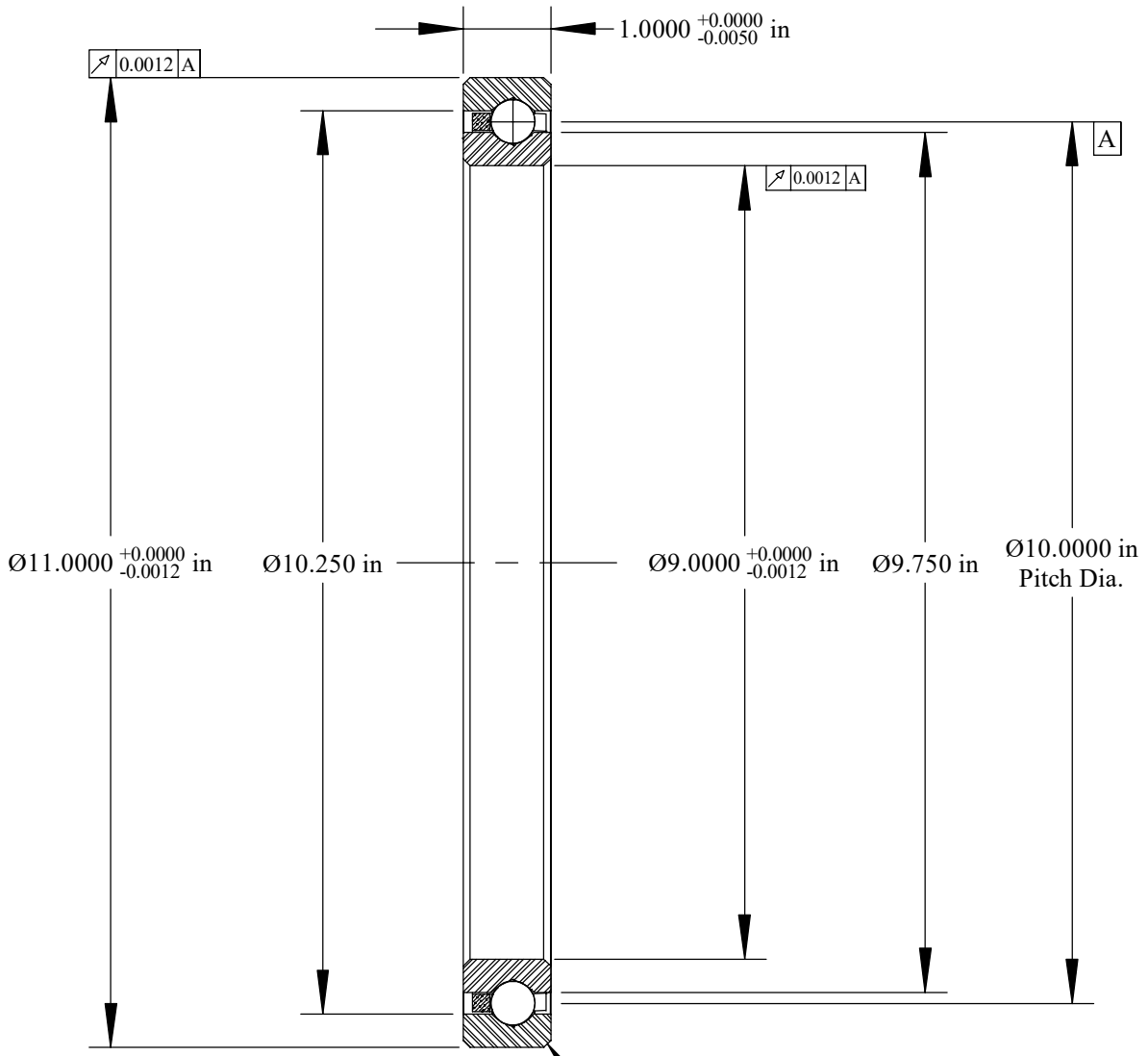

Scale: 0.5:1 Will Clear 0.080 Max. Fillet Radius 4 Exterior Corners

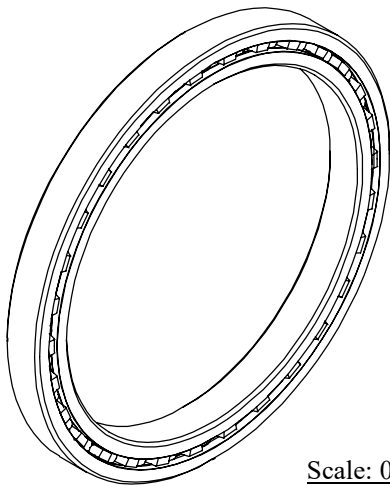

Scale: 0.25:1

	OUTER	INNER	SEPARATOR	BALL
MATERIAL	52100	52100	BRASS	52100
HARDNESS	Rc 59-62	Rc 59-62		
RACE RUN-OUT	OUTER	INNER		
ABEC RATING	PRELOAD		ROLLING ELEMENT	
1	N/A		QUANTITY	SIZE
			30	1/2
RADIAL LOAD	THRUST LOAD		MOMENT LOAD	
DYNAMIC: 11,526 Lbs. STATIC: 16,420 Lbs.	DYNAMIC: 17,870 Lbs. STATIC: 41,040 Lbs.		DYNAMIC: 43,240 Lbs.-in. STATIC: 82,080 Lbs.-in.	
RADIAL PLAY	CONTACT ANGLE		LIMITING SPEED	
0.0024 0.0034	N/A		425 RPM	
LUBRICATION	SEAL		BEARING WEIGHT	
LIGHT OIL PRESERVATIVE	N/A		7.20 Lbs.	

SSB
thin section bearings

Corporate Headquarters
15151 Prater Drive
Covington, GA 30014
(800) 431-1980
www.ritbearing.com

UNLESS OTHERWISE SPECIFIED ALL DIMENSIONS IN INCHES

Designed by ML	Checked by ML	This drawing and the information contained herein are proprietary and the property of Ritbearing Corporation.	
RG090XP0		4 Point Contact Thin Section Ball Bearing	
File name RG090XP0	Date March 25, 2020	REVISION A	Sheet 1 of 1