

Cage Code: 704Q7

RevNo	Revision note	Date	Signature	Checked
-------	---------------	------	-----------	---------

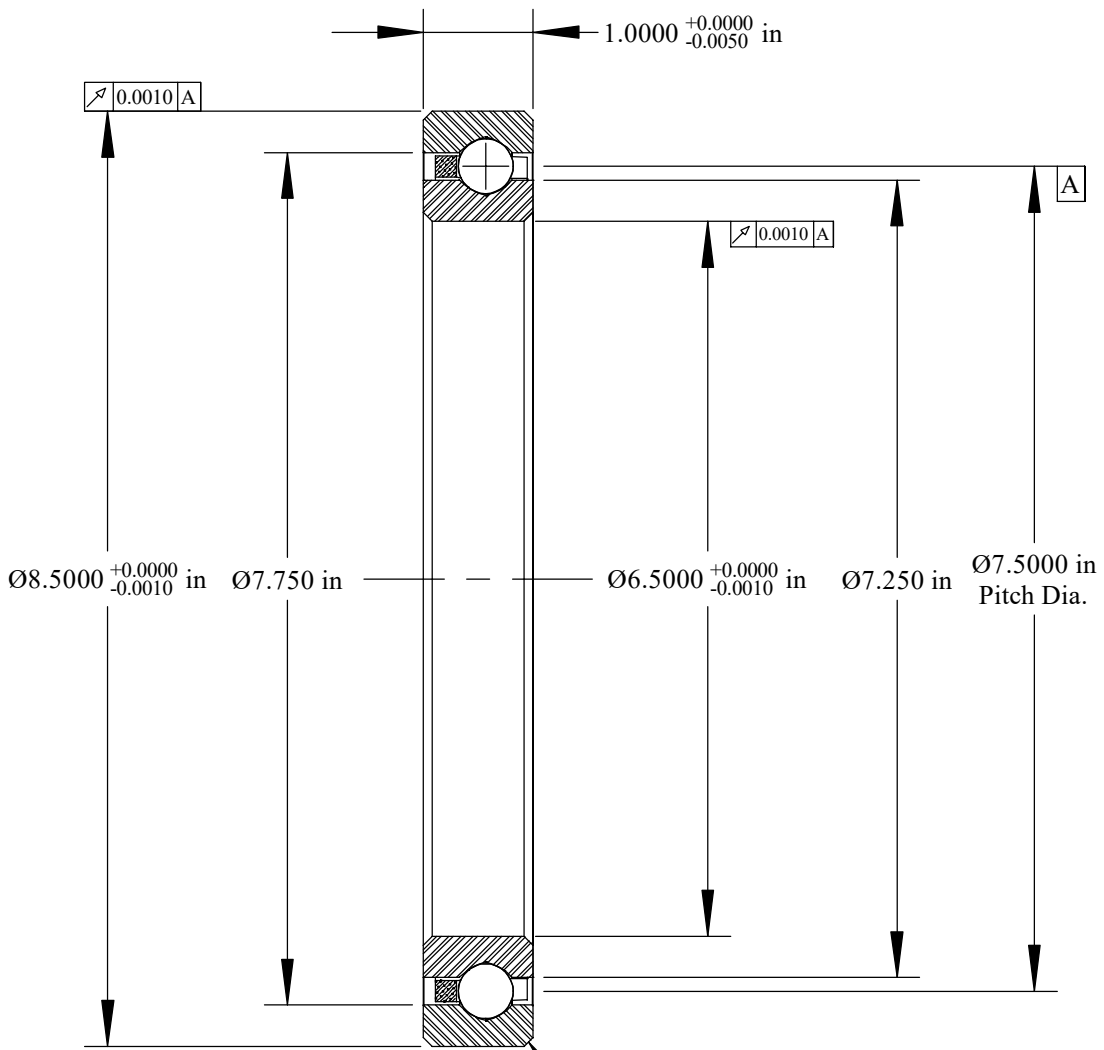

Scale: 0.6:1
 Will Clear 0.080
 Max. Fillet Radius
 4 Exterior Corners

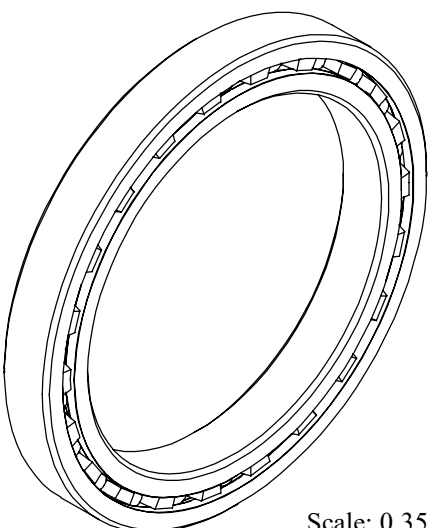

Scale: 0.35:1

	OUTER	INNER	SEPARATOR	BALL
MATERIAL	52100	52100	BRASS	52100
HARDNESS	Rc 59-62	Rc 59-62		
RACE RUN-OUT	OUTER	INNER		
ABEC RATING	PRELOAD		ROLLING ELEMENT	
1	N/A		QUANTITY	SIZE
			22	1/2
RADIAL LOAD	THRUST LOAD		MOMENT LOAD	
DYNAMIC: 9713 Lbs. STATIC: 12,040 Lbs.	DYNAMIC: 14,530 Lbs. STATIC: 30,100 Lbs.		DYNAMIC: 27,327 Lbs.-in. STATIC: 45,140 Lbs.-in.	
RADIAL PLAY	CONTACT ANGLE		LIMITING SPEED	
0.0020 0.0030	N/A		600 RPM	
LUBRICATION	SEAL		BEARING WEIGHT	
LIGHT OIL PRESERVATIVE	N/A		5.40 Lbs.	

SSB BRAND
thin section bearings

Corporate Headquarters
 15151 Prater Drive
 Covington, GA 30014
 (800) 431-1980
 www.ritbearing.com

UNLESS OTHERWISE SPECIFIED ALL DIMENSIONS IN INCHES

Designed by ML	Checked by ML	This drawing and the information contained herein are proprietary and the property of Ritbearing Corporation.	
RG065XP0		4 Point Contact Thin Section Ball Bearing	
File name RG065XP0	Date March 25, 2020	REVISION A	Sheet 1 of 1