

Cage Code: 704Q7

RevNo	Revision note	Date	Signature	Checked
-------	---------------	------	-----------	---------

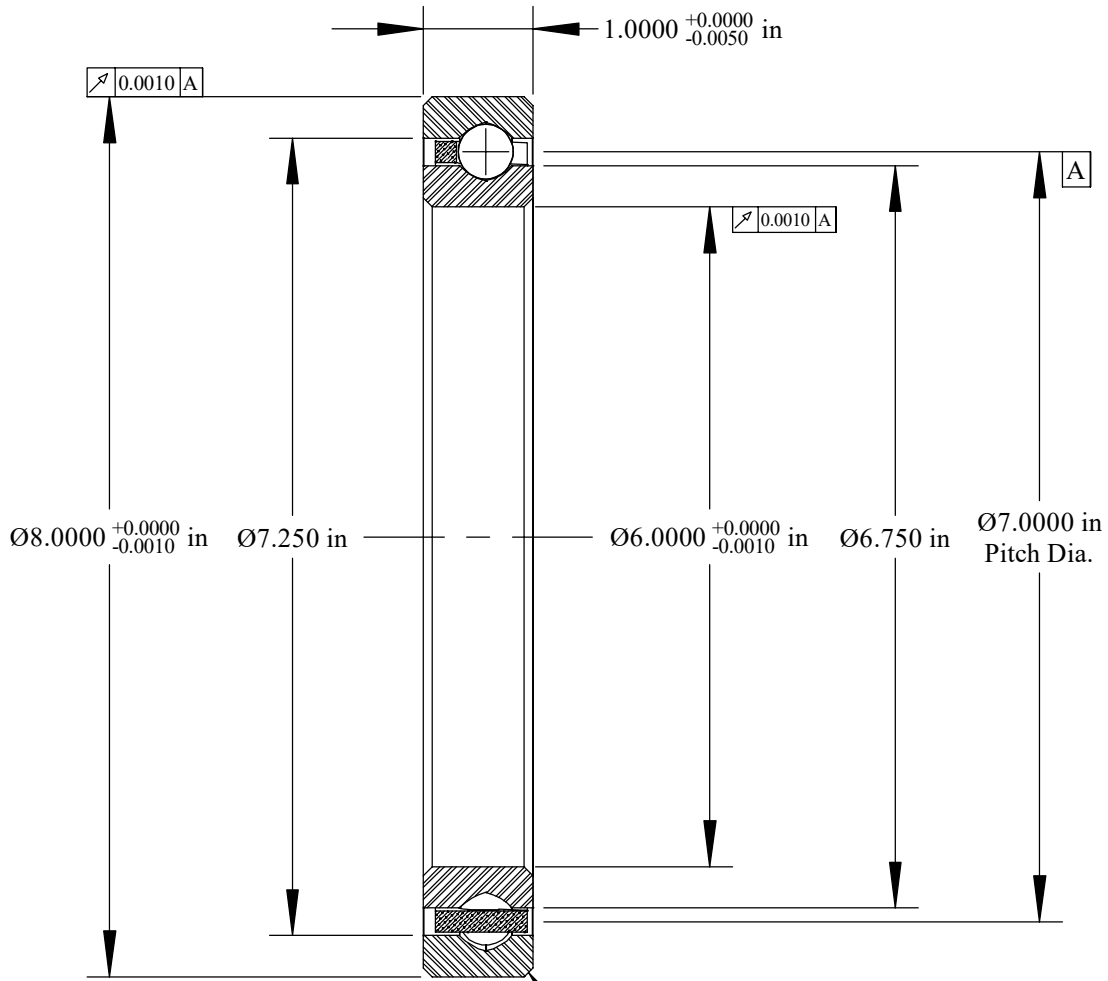

Scale: 0.6:1  
 Will Clear 0.080  
 Max. Fillet Radius  
 4 Exterior Corners

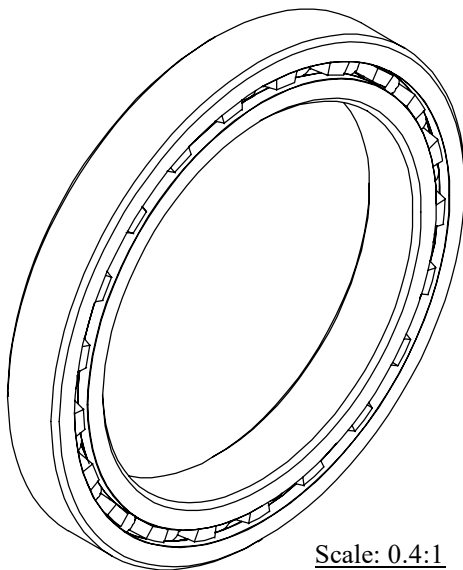

Scale: 0.4:1

	OUTER	INNER	SEPARATOR	BALL
MATERIAL	52100	52100	BRASS	52100
HARDNESS	Rc 59-62	Rc 59-62		
RACE RUN-OUT	OUTER	INNER		
ABEC RATING	PRELOAD		ROLLING ELEMENT	
1	N/A		QUANTITY	SIZE
			21	1/2
RADIAL LOAD	THRUST LOAD		MOMENT LOAD	
DYNAMIC: 9503 Lbs. STATIC: 11,490 Lbs.	DYNAMIC: 14,090 Lbs. STATIC: 28,730 Lbs.		DYNAMIC: 24,956 Lbs.-in. STATIC: 40,220 Lbs.-in.	
RADIAL PLAY	CONTACT ANGLE		LIMITING SPEED	
0.0020 0.0030	N/A		625 RPM	
LUBRICATION	SEAL		BEARING WEIGHT	
LIGHT OIL PRESERVATIVE	N/A		5.10 Lbs.	

UNLESS OTHERWISE SPECIFIED ALL DIMENSIONS IN INCHES

Designed by ML	Checked by ML	This drawing and the information contained herein are proprietary and the property of Ritbearing Corporation.
-------------------	------------------	---

**RG060XP0**

4 Point Contact  
Thin Section  
Ball Bearing

File name RG060XP0	Date March 25, 2020	REVISION A	Sheet 1 of 1
-----------------------	------------------------	---------------	-----------------

**SSB**  
thin section bearings

Corporate Headquarters  
 15151 Prater Drive  
 Covington, GA 30014  
 (800) 431-1980  
 www.ritbearing.com