

Cage Code: 704Q7

RevNo	Revision note	Date	Signature	Checked
-------	---------------	------	-----------	---------

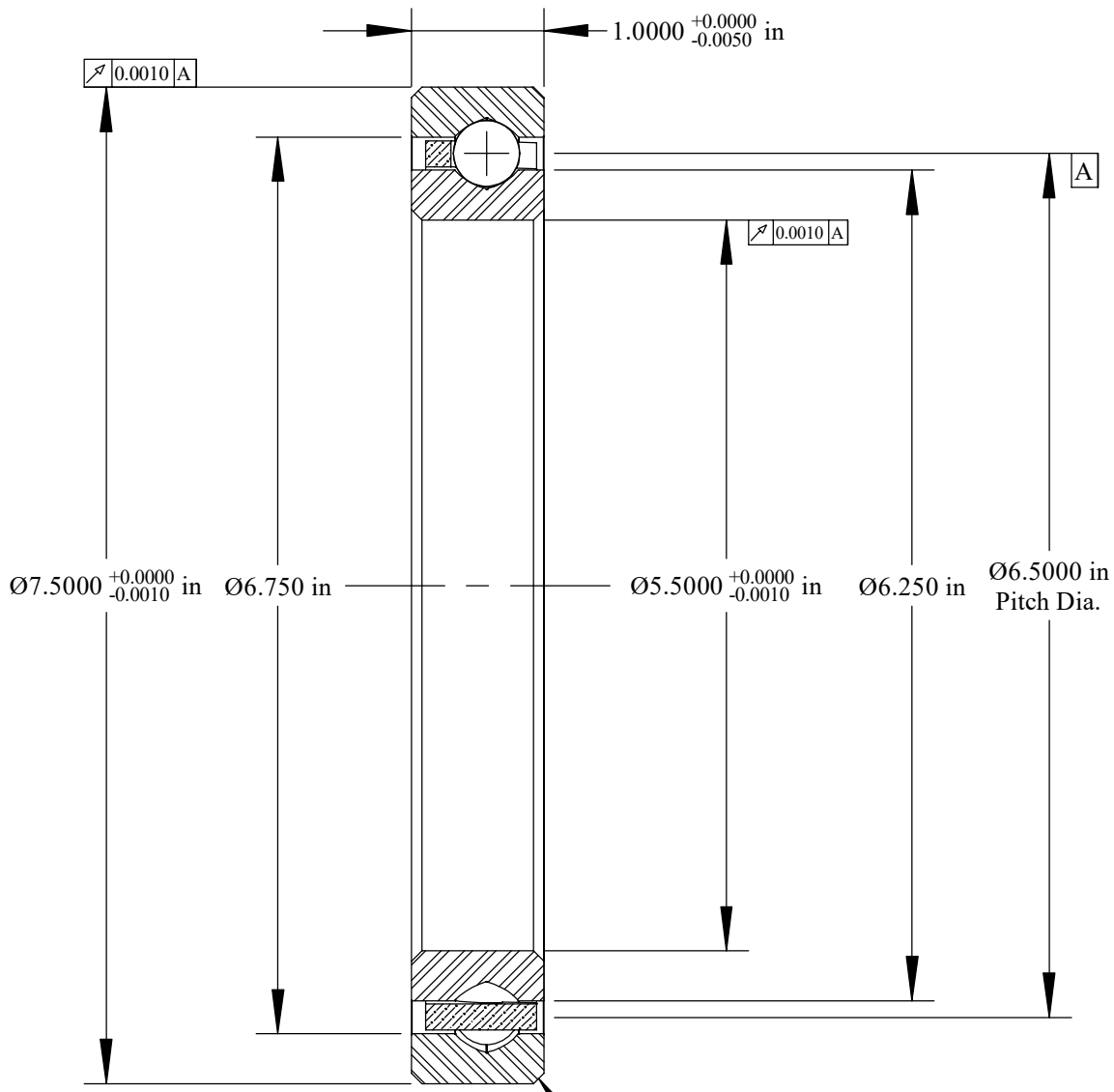

Scale: 0.75:1
 Will Clear 0.080
 Max. Fillet Radius
 4 Exterior Corners

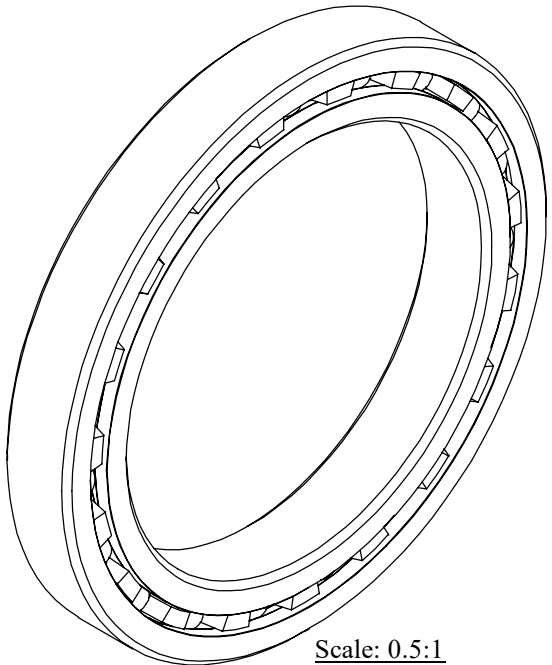

Scale: 0.5:1

	OUTER	INNER	SEPARATOR	BALL
MATERIAL	52100	52100	BRASS	52100
HARDNESS	Rc 59-62	Rc 59-62		
RACE RUN-OUT	OUTER	INNER		
ABEC RATING	PRELOAD		ROLLING ELEMENT	
1	N/A		QUANTITY	SIZE
			19	1/2
RADIAL LOAD	THRUST LOAD		MOMENT LOAD	
DYNAMIC: 8979 Lbs. STATIC: 10,400 Lbs.	DYNAMIC: 13,180 Lbs. STATIC: 25,990 Lbs.		DYNAMIC: 21,896 Lbs.-in. STATIC: 33,790 Lbs.-in.	
RADIAL PLAY	CONTACT ANGLE		LIMITING SPEED	
0.0020 0.0030	N/A		725 RPM	
LUBRICATION	SEAL		BEARING WEIGHT	
LIGHT OIL PRESERVATIVE	N/A		4.70 Lbs.	

Corporate Headquarters
 15151 Prater Drive
 Covington, GA 30014
 (800) 431-1980
 www.rfbearing.com

UNLESS OTHERWISE SPECIFIED ALL DIMENSIONS IN INCHES

Designed by ML	Checked by ML	This drawing and the information contained herein are proprietary and the property of Ribearing Corporation.	
RG055XP0		4 Point Contact Thin Section Ball Bearing	
File name RG055XP0	Date March 25, 2020	REVISION A	Sheet 1 of 1