

Cage Code: 704Q7

RevNo	Revision note	Date	Signature	Checked
-------	---------------	------	-----------	---------

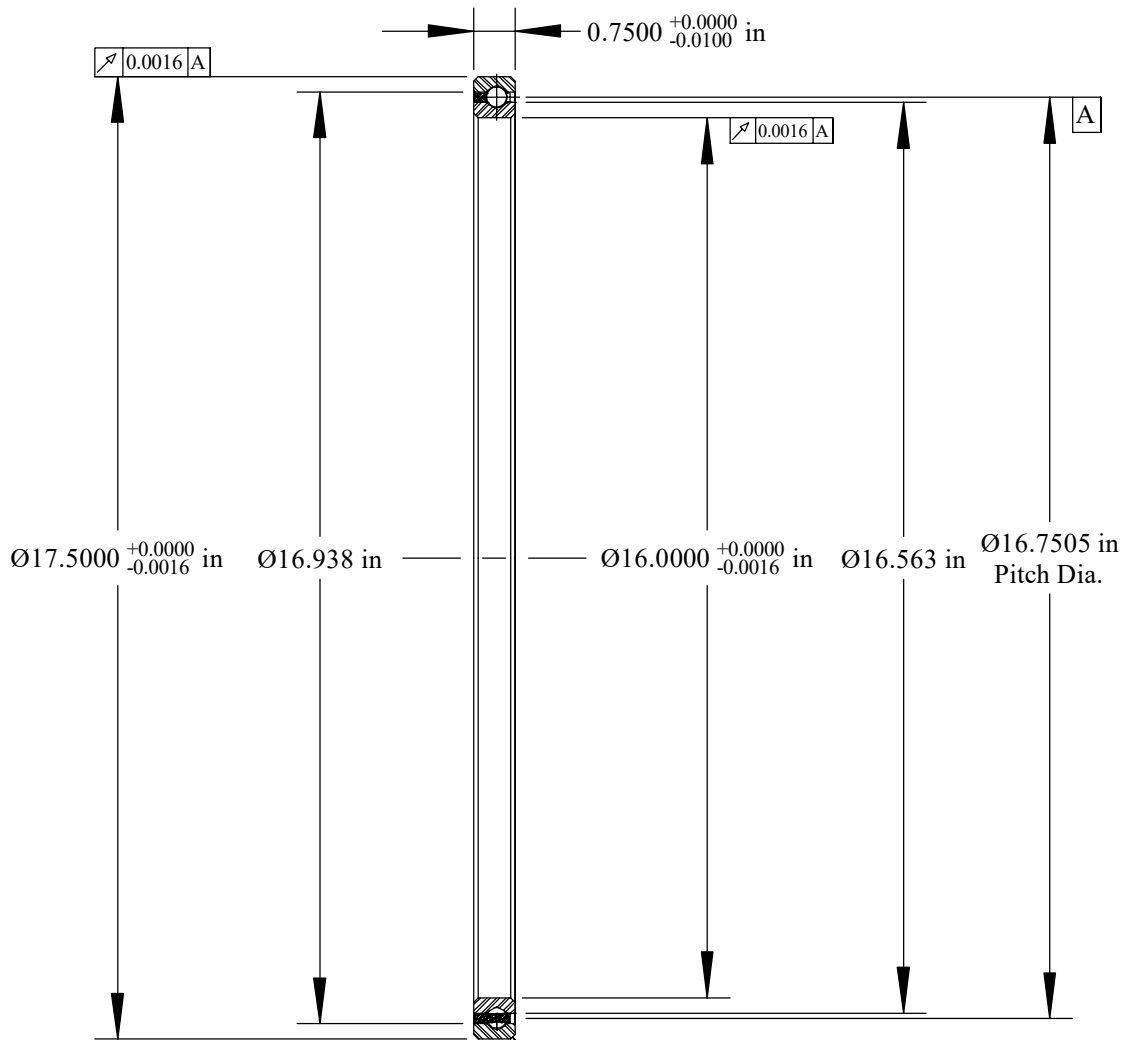

Will Clear 0.080  
Max. Fillet Radius  
4 Exterior Corners  
Scale: 0.3:1

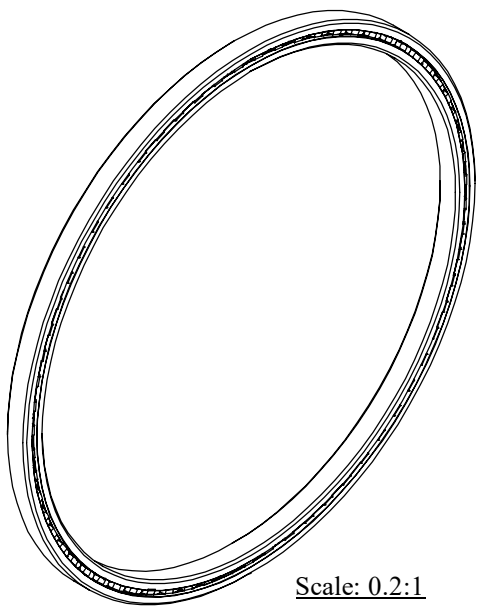

Scale: 0.2:1

	OUTER	INNER	SEPARATOR	BALL
MATERIAL	52100	52100	BRASS	52100
HARDNESS	Rc 59-62	Rc 59-62		
RACE RUN-OUT	OUTER	INNER		
ABEC RATING	PRELOAD		ROLLING ELEMENT	
1	N/A		QUANTITY	SIZE
			67	3/8
RADIAL LOAD	THRUST LOAD		MOMENT LOAD	
DYNAMIC: 9421 Lbs. STATIC: 18,900 Lbs.	DYNAMIC: 15,820 Lbs. STATIC: 47,260 Lbs.		DYNAMIC: 59,200 Lbs.-in. STATIC: 158,300 Lbs.-in.	
RADIAL PLAY	CONTACT ANGLE		LIMITING SPEED	
0.0032 0.0042	N/A		187 RPM	
LUBRICATION	SEAL		BEARING WEIGHT	
LIGHT OIL PRESERVATIVE	N/A		7.10 Lbs.	

UNLESS OTHERWISE SPECIFIED ALL DIMENSIONS IN INCHES

Designed by ML      Checked by ML      This drawing and the information contained herein are proprietary and the property of Ritbearing Corporation.

**RF160XP0**

Four Point Contact  
Thin Section  
Ball Bearing

File name: RF160XP0      Date: March 23, 2020      REVISION: A      Sheet: 1 of 1



**Corporate Headquarters**  
15151 Prater Drive  
Covington, GA 30014  
(800) 431-1980  
www.ritbearing.com