

Cage Code: 704Q7

RevNo

Revision note

Date

Signature

Checked

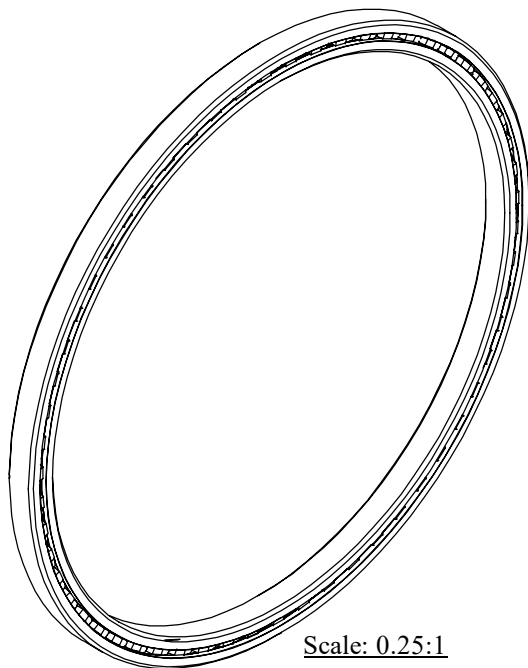
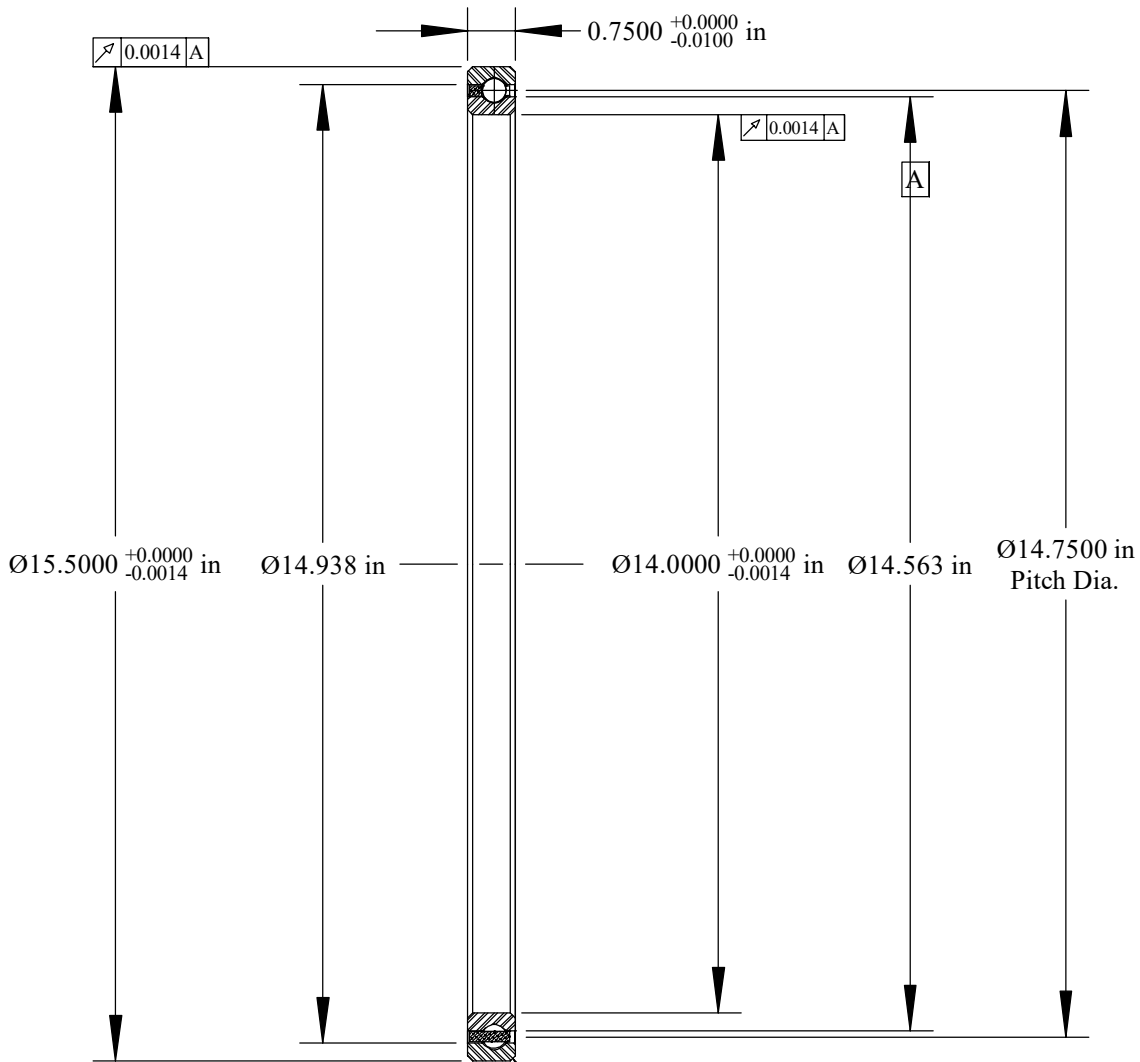

Scale: 0.35:1

Will Clear 0.080  
Max. Fillet Radius  
4 Exterior Corners

	OUTER	INNER	SEPARATOR	BALL
MATERIAL	52100	52100	BRASS	52100
HARDNESS	Re 59-62	Re 59-62		
RACE RUN-OUT	OUTER	INNER		
ABEC RATING	PRELOAD		ROLLING ELEMENT	
1	N/A		QUANTITY	SIZE
			59	3/8
RADIAL LOAD	THRUST LOAD		MOMENT LOAD	
DYNAMIC: 8775 Lbs. STATIC: 16,650 Lbs.	DYNAMIC: 14,530 Lbs. STATIC: 41,620 Lbs.		DYNAMIC: 48,556 Lbs.-in. STATIC: 122,800 Lbs.-in.	
RADIAL PLAY	CONTACT ANGLE		LIMITING SPEED	
0.0028 0.0038	N/A		250 RPM	
LUBRICATION	SEAL		BEARING WEIGHT	
LIGHT OIL PRESERVATIVE	N/A		6.00 Lbs.	

UNLESS OTHERWISE SPECIFIED ALL DIMENSIONS IN INCHES

Designed by  
ML

Checked by  
ML

This drawing and the information  
contained herein are proprietary and  
the property of Ritbearing Corporation.

RF140XP0

Four Point Contact  
Thin Section  
Ball Bearing

File name  
RF140XP0

Date  
March 23, 2020

REVISION  
A

Sheet  
1 of 1

**SSB** BRAND  
thin section bearings

**Corporate Headquarters**  
15151 Prater Drive  
Covington, GA 30014  
(800) 431-1980  
www.ritbearing.com