

Cage Code: 704Q7

RevNo	Revision note	Date	Signature	Checked
-------	---------------	------	-----------	---------

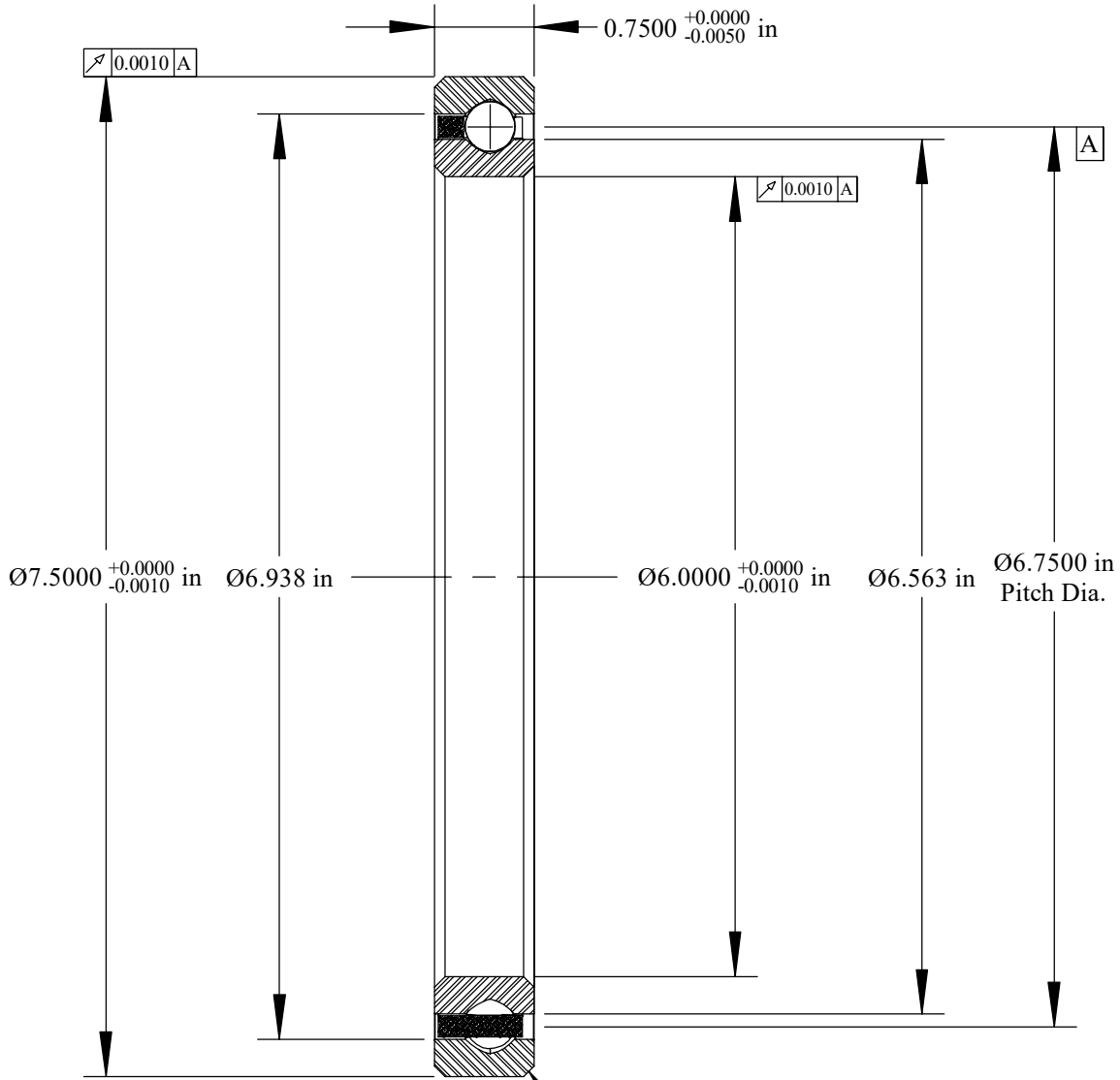

Scale: 0.75:1  
 Will Clear 0.080  
 Max. Fillet Radius  
 4 Exterior Corners

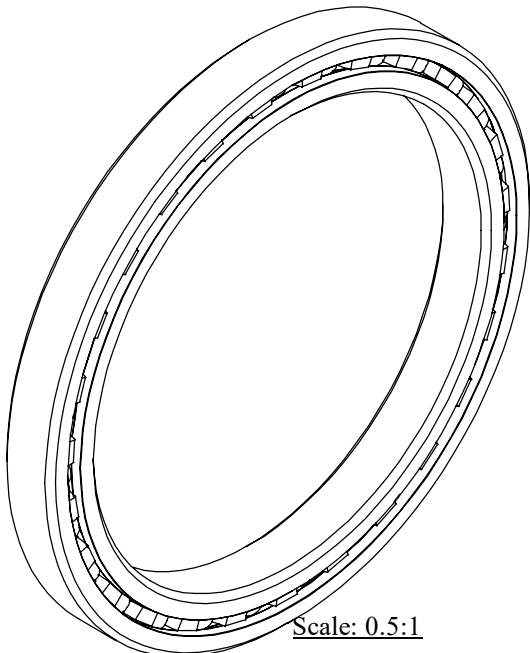

Scale: 0.5:1

	OUTER	INNER	SEPARATOR	BALL
MATERIAL	52100	52100	BRASS	52100
HARDNESS	Rc 59-62	Rc 59-62		
RACE RUN-OUT	OUTER	INNER		
ABEC RATING	PRELOAD		ROLLING ELEMENT	
1	N/A		QUANTITY	SIZE
			27	3/8
RADIAL LOAD	THRUST LOAD		MOMENT LOAD	
DYNAMIC: 5651 Lbs. STATIC: 7620 Lbs.	DYNAMIC: 8630 Lbs. STATIC: 19,050 Lbs.		DYNAMIC: 14,311 Lbs.-in. STATIC: 25,710 Lbs.-in.	
RADIAL PLAY	CONTACT ANGLE		LIMITING SPEED	
0.0020 0.0030	N/A		650 RPM	
LUBRICATION	SEAL		BEARING WEIGHT	
LIGHT OIL PRESERVATIVE	N/A		2.70 Lbs.	

UNLESS OTHERWISE SPECIFIED ALL DIMENSIONS IN INCHES

Designed by ML	Checked by ML	This drawing and the information contained herein are proprietary and the property of Ritbearing Corporation.
-------------------	------------------	---

**RF060XP0**

Four Point Contact  
Thin Section  
Ball Bearing

File name RF060XP0	Date March 20,2020	REVISION A	Sheet 1 of 1
-----------------------	-----------------------	---------------	-----------------



**Corporate Headquarters**  
**15151 Prater Drive**  
**Cevington, GA 30014**  
**(800) 431-1980**  
**www.ritbearing.com**