

Cage Code: 704Q7

RevNo

Revision note

Date

Signature

Checked

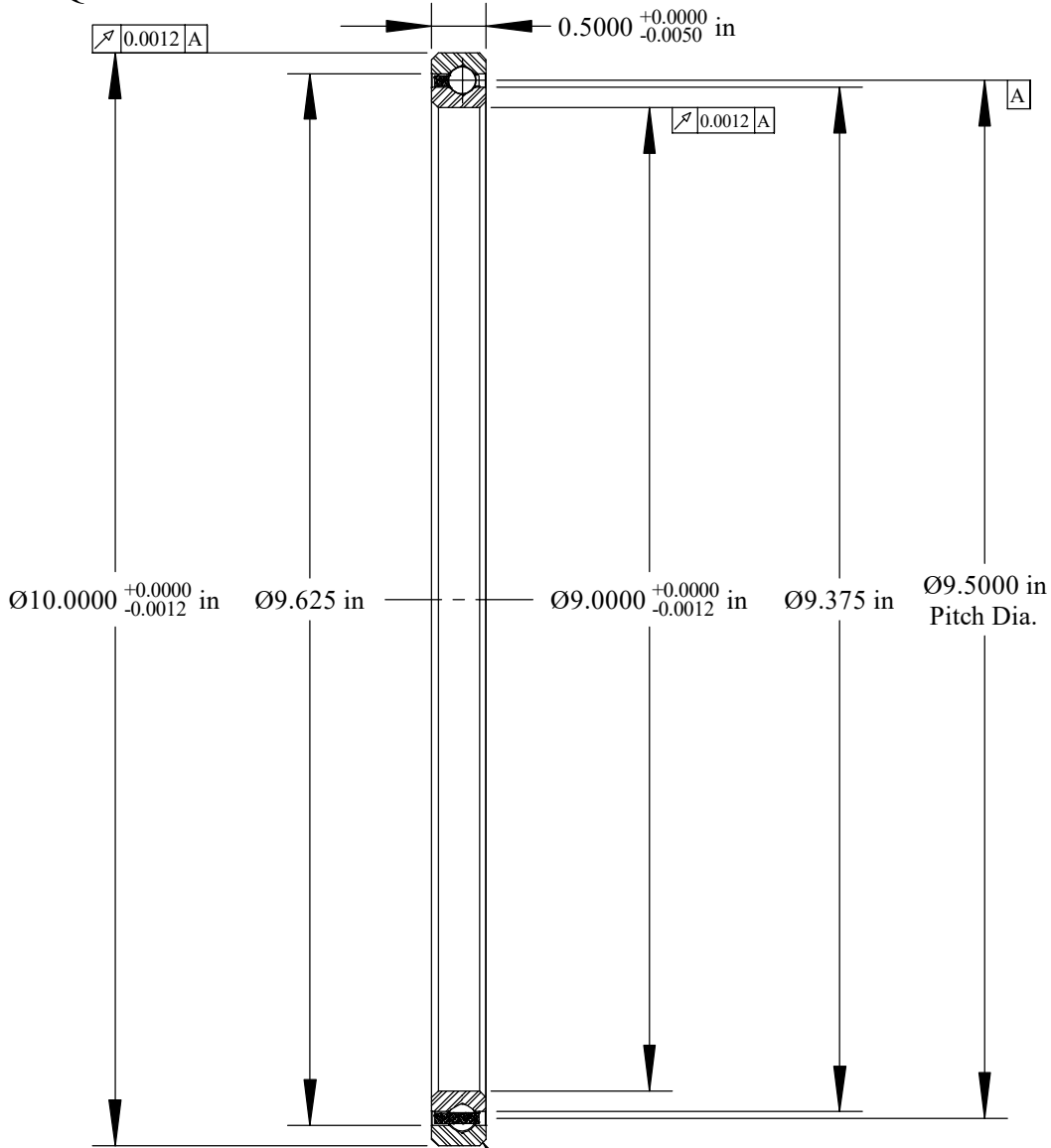

Scale: 0.6:1

Will Clear 0.060  
Max. Fillet Radius  
4 Exterior Corners

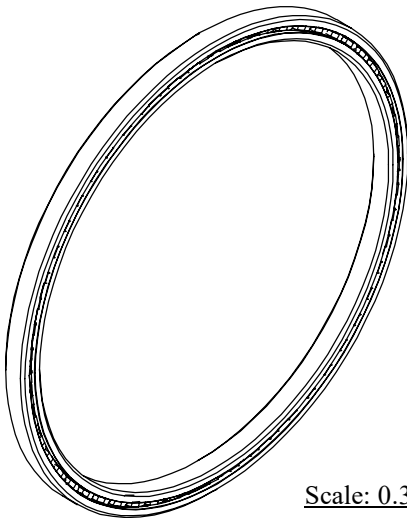

Scale: 0.3:1

	OUTER	INNER	SEPARATOR	BALL
MATERIAL	52100	52100	BRASS	52100
HARDNESS	Re 59-62	Re 59-62		
RACE RUN-OUT	OUTER	INNER		
ABEC RATING	PRELOAD		ROLLING ELEMENT	
1	N/A		QUANTITY 57	SIZE 1/4
RADIAL LOAD	THRUST LOAD		MOMENT LOAD	
DYNAMIC: 3561 Lbs. STATIC: 6500 Lbs.	DYNAMIC: 5790 Lbs. STATIC: 16,250 Lbs.		DYNAMIC: 12,693 Lbs.-in. STATIC: 30,870 Lbs.-in.	
RADIAL PLAY	CONTACT ANGLE		LIMITING SPEED	
0.0024 0.0034	N/A		390 RPM	
LUBRICATION	SEAL		BEARING WEIGHT	
LIGHT OIL PRESERVATIVE	N/A		1.72 Lbs.	

UNLESS OTHERWISE SPECIFIED ALL DIMENSIONS IN INCHES

Designed by  
ML

Checked by  
ML

This drawing and the information  
contained herein are proprietary and  
the property of Ritbearing Corporation.

RD040XP0

Four Point Contact  
Thin Section  
Ball Bearing

File name  
RC040XP0

Date  
March 17, 2020

REVISION  
A

Sheet  
1 of 1

**SSB** BRAND  
thin section bearings

Corporate Headquarters  
15151 Prater Drive  
Covington, GA 30014  
(800) 431-1980  
www.ritbearing.com