

Cage Code: 704Q7

RevNo	Revision note	Date	Signature	Checked
-------	---------------	------	-----------	---------

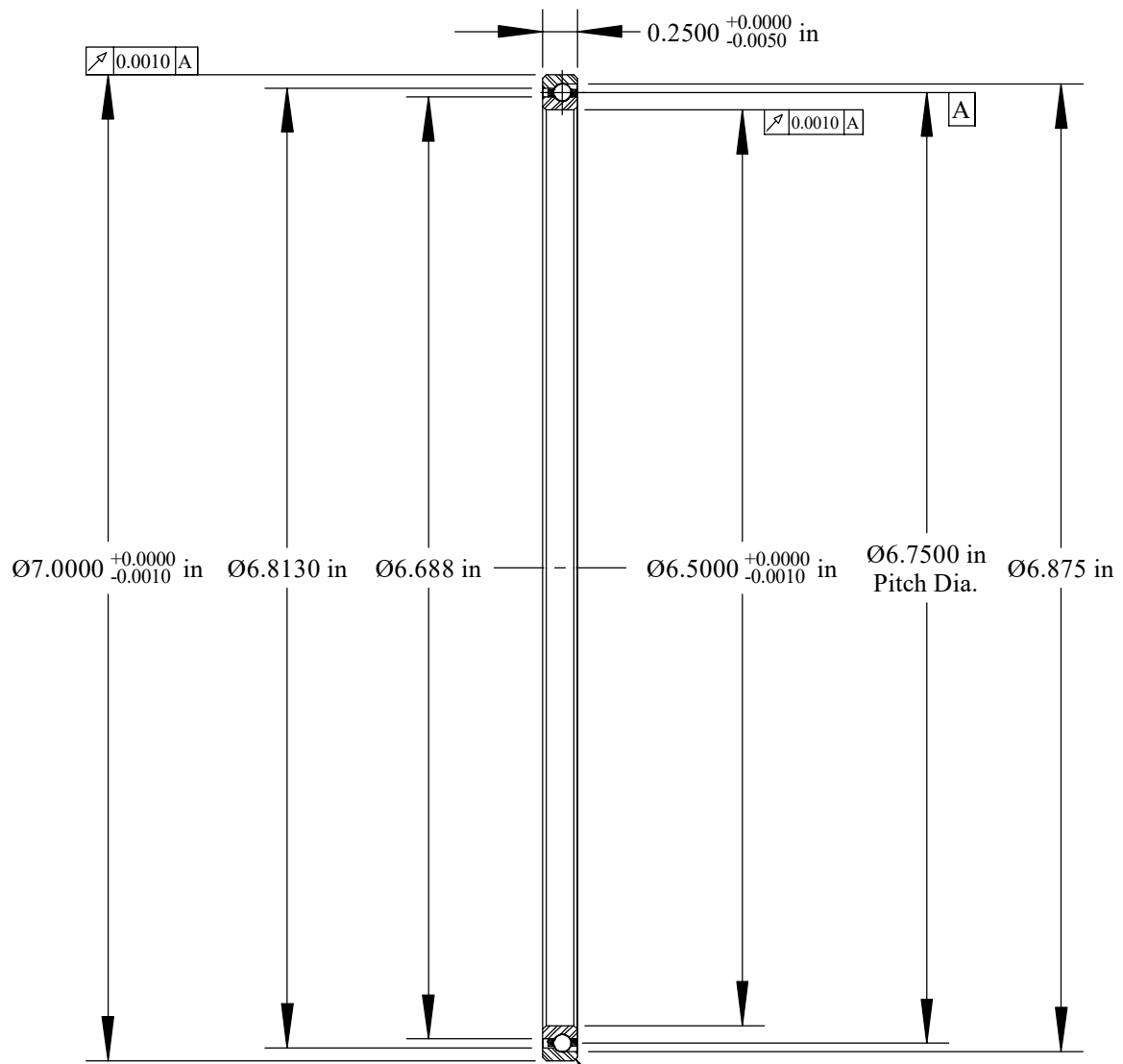

Will Clear 0.025
Max. Fillet Radius
4 Exterior Corners

Scale: 0.8:1

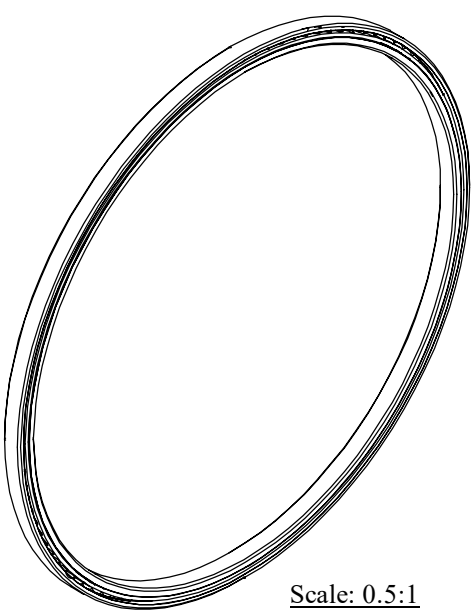

Scale: 0.5:1

	OUTER	INNER	SEPARATOR	BALL
MATERIAL	52100	52100	BRASS	Ceramic
HARDNESS	Re 59-62	Re 59-62		
RACE RUN-OUT	OUTER	INNER		
ABEC RATING	PRELOAD		ROLLING ELEMENT	
1	N/A		QUANTITY 108	SIZE 1/8
RADIAL LOAD	THRUST LOAD		MOMENT LOAD	
DYNAMIC: 788 Lbs. STATIC: 2370 Lbs.	DYNAMIC: 2000 Lbs. STATIC: 6830 Lbs.		N/A	
AXIAL PRELOAD	CONTACT ANGLE		LIMITING SPEED	
N/A	30°		2,625 RPM	
LUBRICATION	SEAL		BEARING WEIGHT	
LIGHT OIL PRESERVATIVE	N/A		0.30 Lbs.	

UNLESS OTHERWISE SPECIFIED ALL DIMENSIONS IN INCHES

Designed by ML	Checked by ML	This drawing and the information contained herein are proprietary and the property of Ritbearing Corporation.
-------------------	------------------	---

RA065AR0 Radial Thin Section Ball Bearing

File name RA065AR0	Date April 8, 2020	REVISION A	Sheet 1 of 1
-----------------------	-----------------------	---------------	-----------------



Corporate Headquarters
15151 Prater Drive
Covington, GA 30014
(800) 431-1980
www.ritbearing.com