

Cage Code: 704Q7

RevNo

Revision note

Date

Signature

Checked

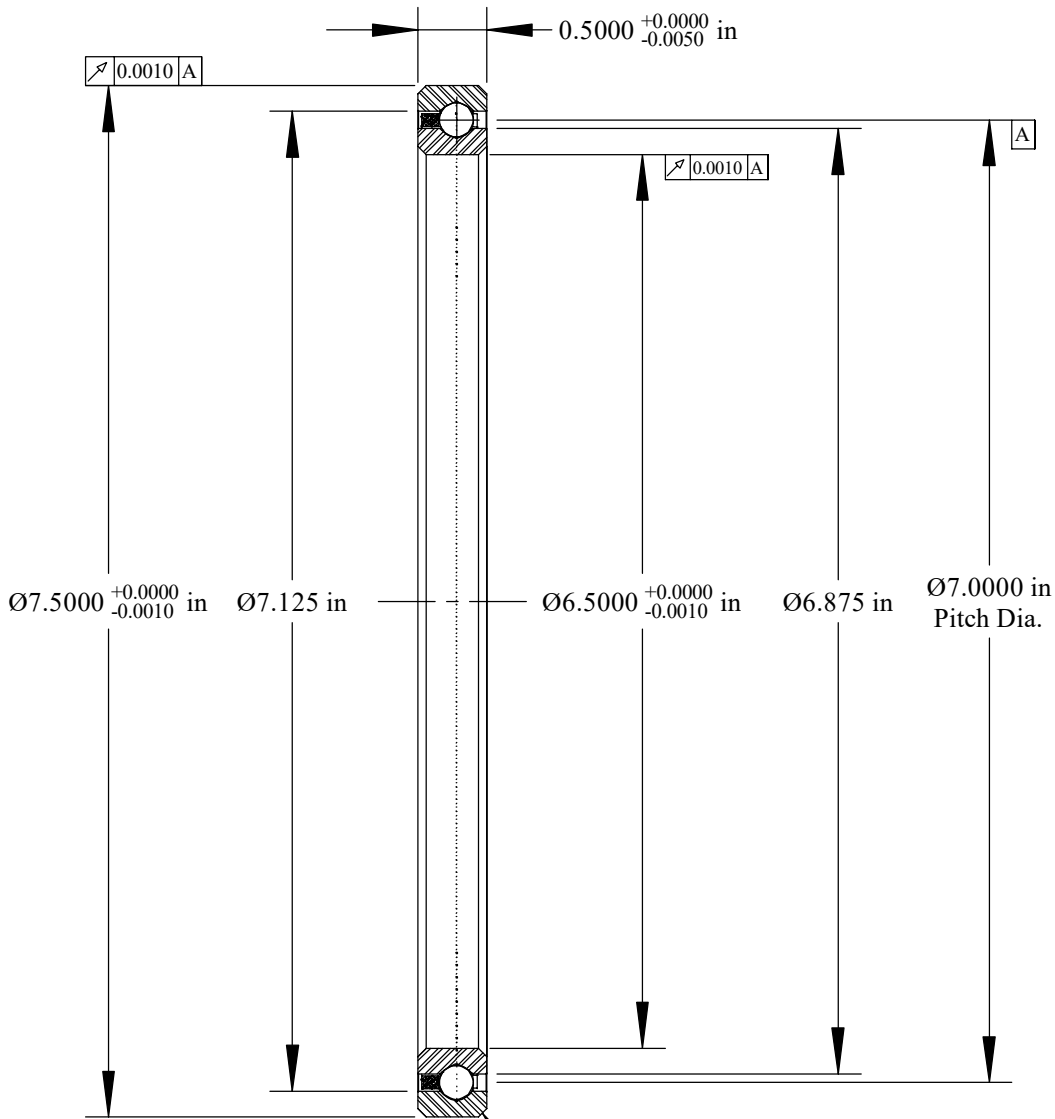

Scale: 0.75:1

Will Clear 0.060
Max. Fillet Radius
4 Exterior Corners

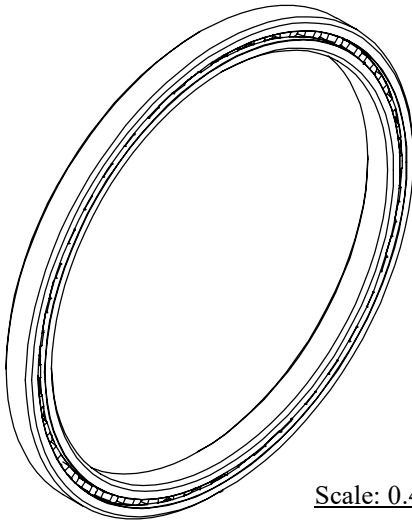

Scale: 0.4:1

	OUTER	INNER	SEPARATOR	BALL
MATERIAL	52100	52100	BRASS	52100
HARDNESS	Re 59-62	Re 59-62		
RACE RUN-OUT	OUTER	INNER		
ABEC RATING	PRELOAD		ROLLING ELEMENT	
1	N/A		QUANTITY	SIZE
			42	1/4
RADIAL LOAD	THRUST LOAD		MOMENT LOAD	
DYNAMIC: 2982 Lbs. STATIC: 4790 Lbs.	DYNAMIC: 4720 Lbs. STATIC: 11,970 Lbs.		DYNAMIC: 7826 Lbs.-in. STATIC: 16,760 Lbs.-in.	
RADIAL PLAY	CONTACT ANGLE		LIMITING SPEED	
0.0020 0.0030	N/A		540 RPM	
LUBRICATION	SEAL		BEARING WEIGHT	
LIGHT OIL PRESERVATIVE	N/A		1.22 Lbs.	

UNLESS OTHERWISE SPECIFIED ALL DIMENSIONS IN INCHES

Designed by
ML

Checked by
ML

This drawing and the information
contained herein are proprietary and
the property of Ritbearing Corporation.

RD040XP0

Four Point Contact
Thin Section
Ball Bearing

File name
RC040XP0

Date
March 17, 2020

REVISION
A

Sheet
1 of 1

SSB BRAND
thin section bearings

Corporate Headquarters
15151 Prater Drive
Covington, GA 30014
(800) 431-1980
www.ritbearing.com