

Cage Code: 704Q7

| | | | | |
|-------|---------------|------|-----------|---------|
| RevNo | Revision note | Date | Signature | Checked |
|-------|---------------|------|-----------|---------|

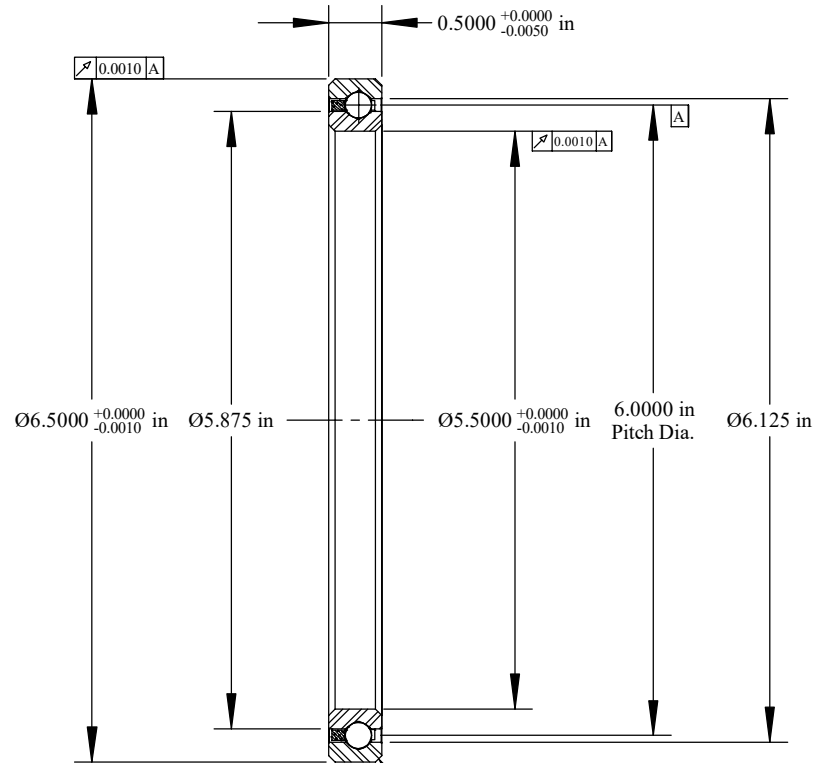

Scale: 0.75:1
 Will Clear 0.060
 Max. Fillet Radius
 4 Exterior Corners

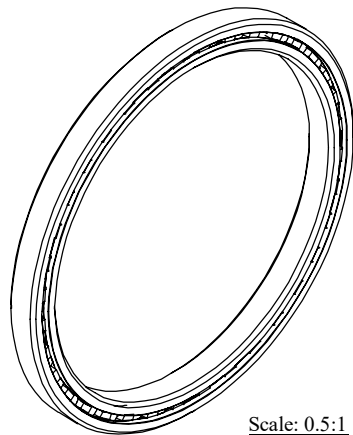

Scale: 0.5:1

| | | | | |
|---|---|----------|---|-------|
| | OUTER | INNER | SEPARATOR | BALL |
| MATERIAL | 52100 | 52100 | BRASS | 52100 |
| HARDNESS | Rc 59-62 | Rc 59-62 | | |
| RACE RUN-OUT | OUTER | INNER | | |
| ABEC RATING | PRELOAD | | ROLLING ELEMENT | |
| 1 | N/A | | QUANTITY | SIZE |
| | | | 36 | 1/4 |
| RADIAL LOAD | THRUST LOAD | | MOMENT LOAD | |
| DYNAMIC: 2725 Lbs. STATIC: 4100 Lbs. | DYNAMIC: 4260 Lbs. STATIC: 10,260 Lbs. | | DYNAMIC: 6134 Lbs.-in. STATIC: 12,310 Lbs.-in. | |
| RADIAL PLAY | CONTACT ANGLE | | LIMITING SPEED | |
| 0.0020 0.0030 | N/A | | 640 RPM | |
| LUBRICATION | SEAL | | BEARING WEIGHT | |
| LIGHT OIL PRESERVATIVE | N/A | | 1.06 Lbs. | |

UNLESS OTHERWISE SPECIFIED ALL DIMENSIONS IN INCHES

| | | |
|-----------------------|------------------------|--|
| Designed by ML | Checked by ML | This drawing and the information contained herein are proprietary and the property of Rfbearing Corporation. |
| RD055XP0 | | Four Point Contact Thin Section Ball Bearing |
| File name RD055XP0 | Date March 20, 2019 | REVISION A Sheet 1 of 1 |

SSB
thin section bearings

Corporate Headquarters
 18151 Praire Drive
 Covington, GA 30014
 (800) 431-1980
 www.rfbearing.com