

Cage Code: 704Q7

RevNo	Revision note	Date	Signature	Checked
-------	---------------	------	-----------	---------

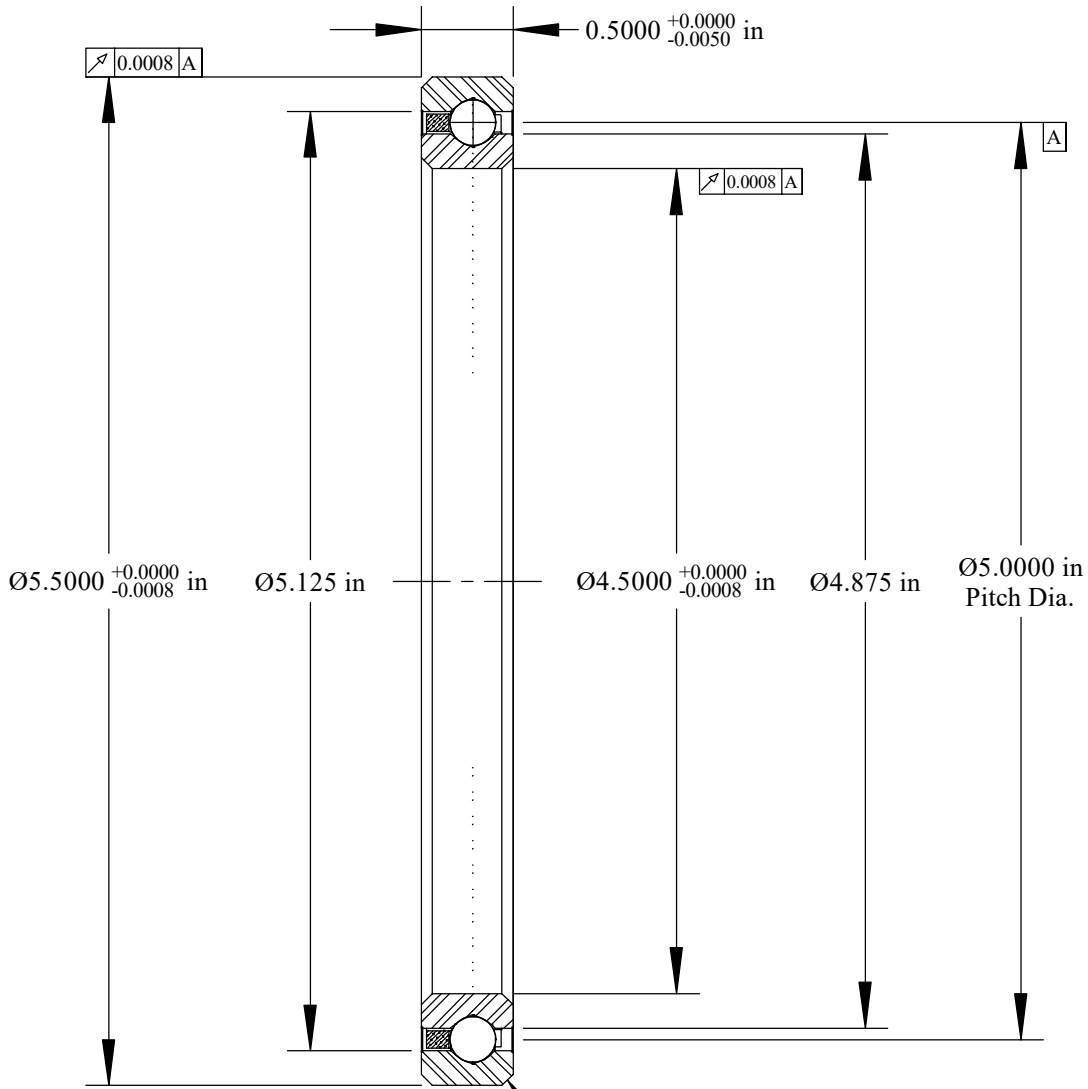

Scale: 1:1

Will Clear 0.060
Max. Fillet Radius
4 Exterior Corners

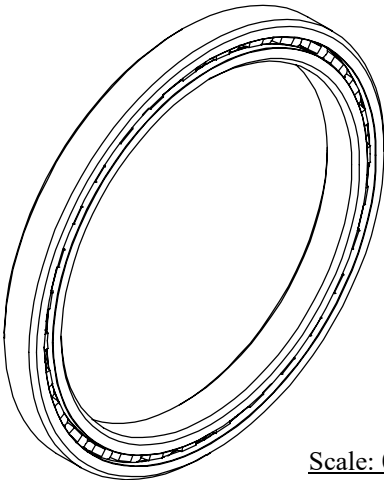

Scale: 0.5:1

	OUTER	INNER	SEPARATOR	BALL
MATERIAL	52100	52100	BRASS	52100
HARDNESS	Rc 59-62	Rc 59-62		
RACE RUN-OUT	OUTER	INNER		
ABEC RATING	PRELOAD		ROLLING ELEMENT	
1	N/A		QUANTITY	SIZE
			30	1/4
RADIAL LOAD	THRUST LOAD		MOMENT LOAD	
DYNAMIC: 2454 Lbs. STATIC: 3420 Lbs.	DYNAMIC: 3770 Lbs. STATIC: 8550 Lbs.		DYNAMIC: 4602 Lbs.-in. STATIC: 8550 Lbs.-in.	
RADIAL PLAY	CONTACT ANGLE		LIMITING SPEED	
0.0016 0.0026	N/A		890 RPM	
LUBRICATION	SEAL		BEARING WEIGHT	
LIGHT OIL PRESERVATIVE	N/A		0.88 Lbs.	

UNLESS OTHERWISE SPECIFIED ALL DIMENSIONS IN INCHES

Designed by ML	Checked by ML	This drawing and the information contained herein are proprietary and the property of Ritbearing Corporation.
-------------------	------------------	---

RD045XP0

Four Point Contact
Thin Section
Ball Bearing

File name RC045XP0	Date March 17, 2020	REVISION A	Sheet 1 of 1
-----------------------	------------------------	---------------	-----------------



Corporate Headquarters
15151 Prazer Drive
Covington, GA 30014
(800) 431-1980
www.ritbearing.com