

Cage Code: 704Q7

RevNo

Revision note

Date

Signature

Checked

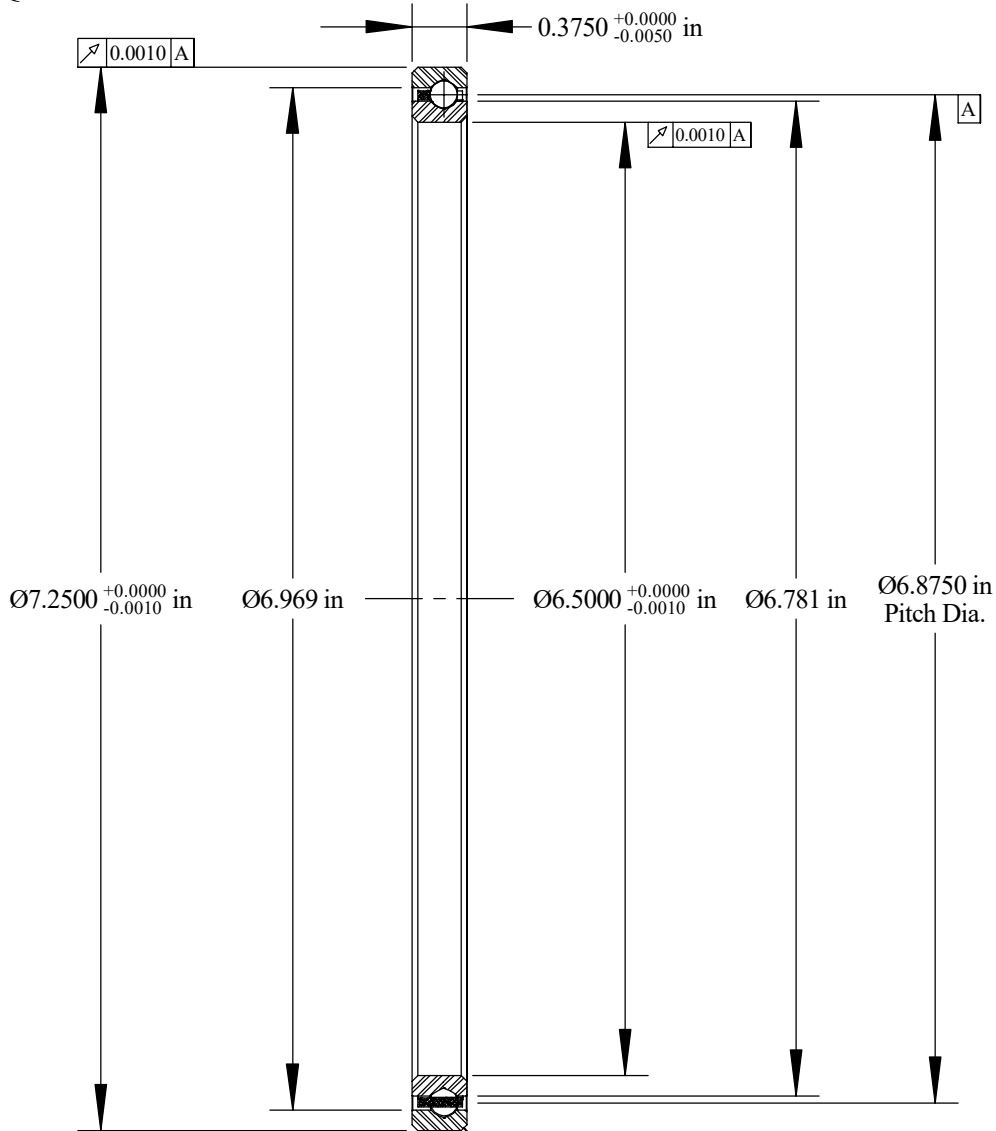

Will Clear 0.040  
Max. Fillet Radius  
4 Exterior Corners

Scale: 0.8:1

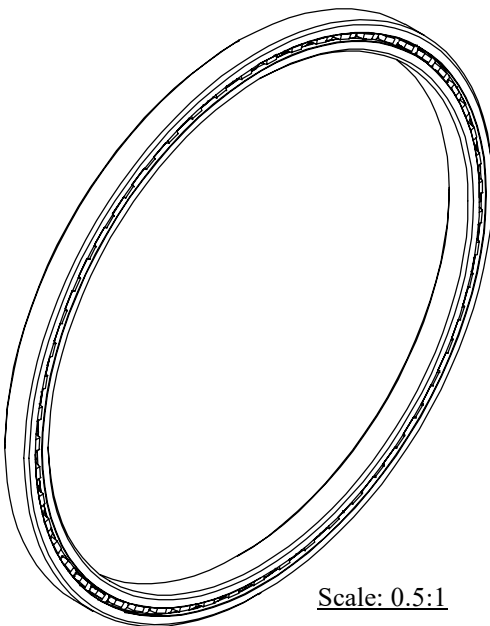

Scale: 0.5:1

	OUTER	INNER	SEPARATOR	BALL
MATERIAL	52100	52100	BRASS	52100
HARDNESS	Re 59-62	Re 59-62		
RACE RUN-OUT	OUTER	INNER		
ABEC RATING	PRELOAD		ROLLING ELEMENT	
1	N/A		QUANTITY 55	SIZE 3/16
RADIAL LOAD	THRUST LOAD		MOMENT LOAD	
DYNAMIC: 1851 Lbs. STATIC: 3310 Lbs.	DYNAMIC: 2990 Lbs. STATIC: 8270 Lbs.		DYNAMIC: 4775 Lbs.-in. STATIC: 11,370 Lbs.-in.	
RADIAL PLAY	CONTACT ANGLE		LIMITING SPEED	
0.0020 0.0030	N/A		540 RPM	
LUBRICATION	SEAL		BEARING WEIGHT	
LIGHT OIL PRESERVATIVE	N/A		0.68 Lbs.	

UNLESS OTHERWISE SPECIFIED ALL DIMENSIONS IN INCHES

Designed by  
ML

Checked by  
ML

This drawing and the information  
contained herein are proprietary and  
the property of Ritbearing Corporation.

RC065XP0

Four Point Contact  
Thin Section  
Ball Bearing

File name  
RC065XP0

Date  
March 3, 2020

REVISION  
A

Sheet  
1 of 1

**SSB** BRAND  
thin section bearings

**Corporate Headquarters**  
15151 Prater Drive  
Covington, GA 30014  
(800) 431-1980  
www.ritbearing.com