

Cage Code: 704Q7

RevNo	Revision note	Date	Signature	Checked
-------	---------------	------	-----------	---------

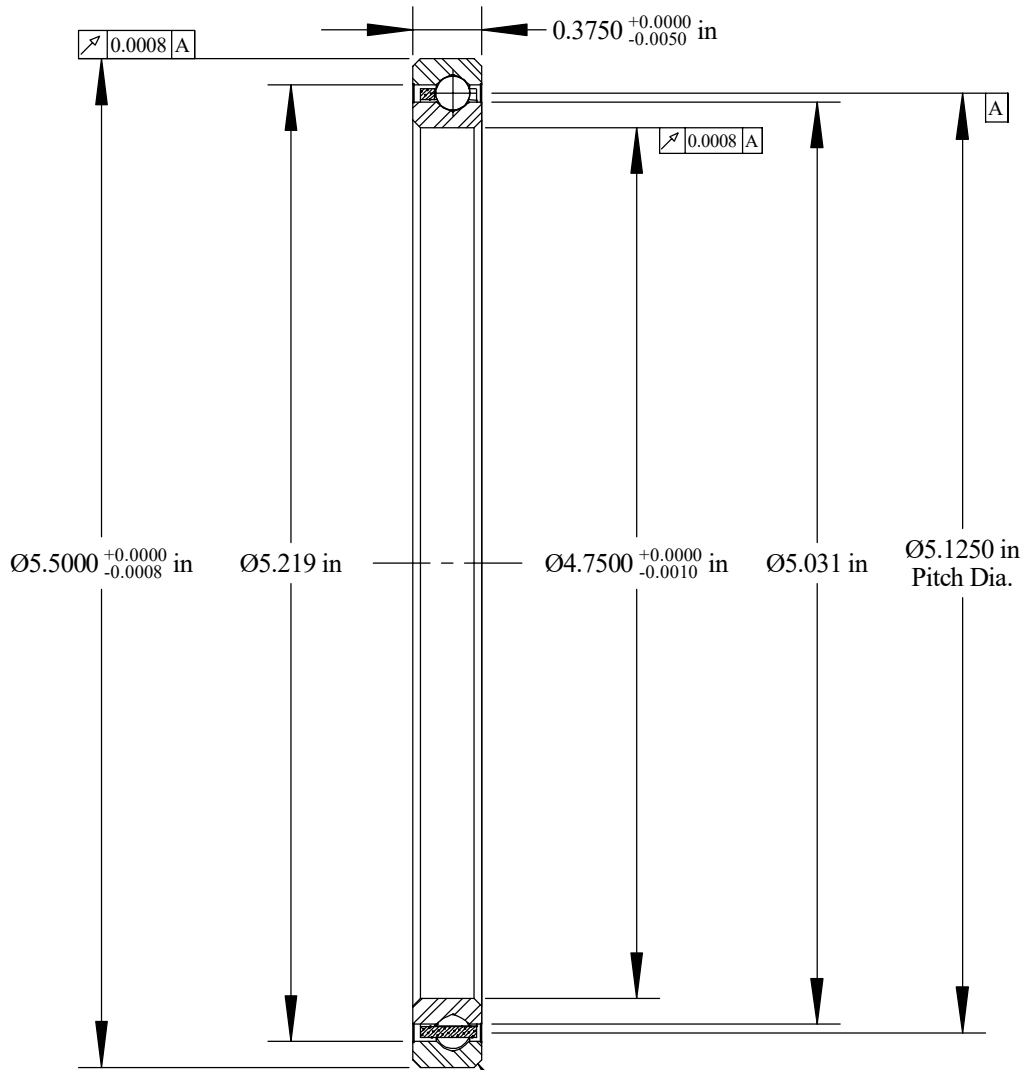

Scale: 1:1

Will Clear 0.040
Max. Fillet Radius
4 Exterior Corners

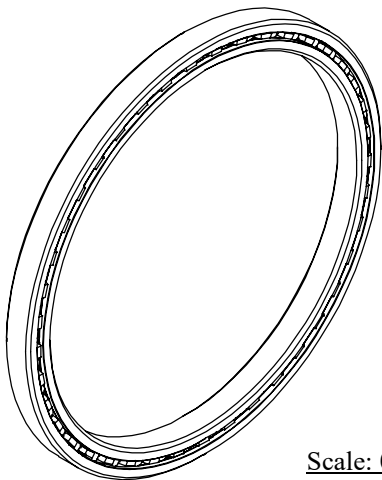

Scale: 0.5:1

	OUTER	INNER	SEPARATOR	BALL
MATERIAL	52100	52100	BRASS	52100
HARDNESS	Rc 59-62	Rc 59-62		
RACE RUN-OUT	OUTER	INNER		
ABEC RATING	PRELOAD		ROLLING ELEMENT	
1	N/A		QUANTITY 41	SIZE 3/16
RADIAL LOAD	THRUST LOAD		MOMENT LOAD	
DYNAMIC: 1556 Lbs. STATIC: 2460 Lbs.	DYNAMIC: 2460 Lbs. STATIC: 6160 Lbs.		DYNAMIC: 2991 Lbs.-in. STATIC: 6320 Lbs.-in.	
RADIAL PLAY	CONTACT ANGLE		LIMITING SPEED	
0.0020 0.0030	N/A		740 RPM	
LUBRICATION	SEAL		BEARING WEIGHT	
LIGHT OIL PRESERVATIVE	N/A		0.50 Lbs.	

UNLESS OTHERWISE SPECIFIED ALL DIMENSIONS IN INCHES

Designed by ML	Checked by ML	This drawing and the information contained herein are proprietary and the property of Ritbearing Corporation.
-------------------	------------------	---

RC047XP0

Four Point Contact
Thin Section
Ball Bearing

File name RC047XP0	Date March 3, 2020	REVISION A	Sheet 1 of 1
-----------------------	-----------------------	---------------	-----------------



Corporate Headquarters
15151 Prater Drive
Covington, GA 30014
(800) 431-1980
www.ritbearing.com