

Cage Code: 704Q7

RevNo	Revision note	Date	Signature	Checked
-------	---------------	------	-----------	---------

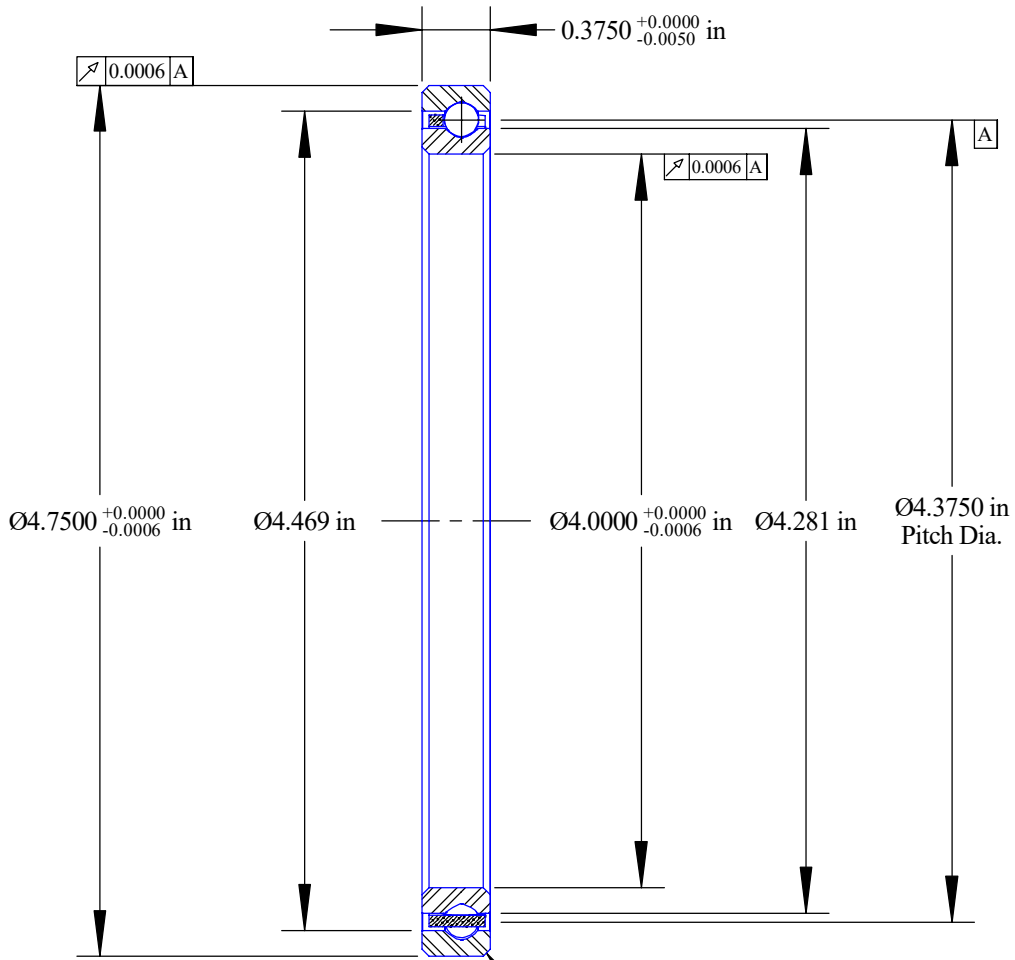

Scale: 1:1  
 Will Clear 0.040  
 Max. Fillet Radius  
 4 Exterior Corners

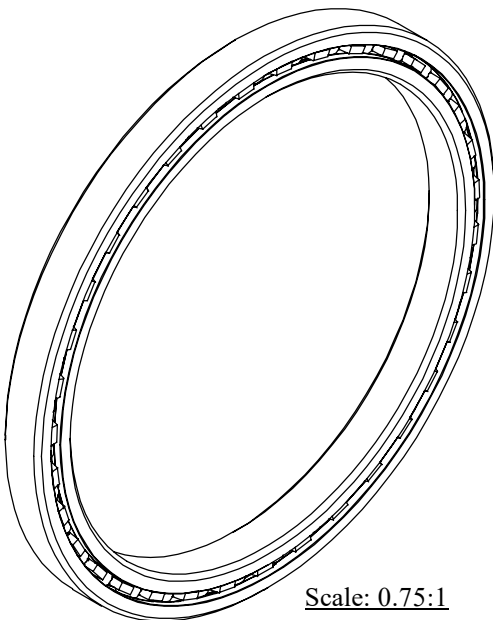

Scale: 0.75:1

	OUTER	INNER	SEPARATOR	BALL
MATERIAL	52100	52100	BRASS	52100
HARDNESS	Rc 59-62	Rc 59-62		
RACE RUN-OUT	OUTER	INNER		
ABEC RATING	PRELOAD		ROLLING ELEMENT	
1	N/A		QUANTITY	SIZE
			35	3/16
RADIAL LOAD	THRUST LOAD		MOMENT LOAD	
DYNAMIC: 1417 Lbs. STATIC: 2100 Lbs.	DYNAMIC: 2210 Lbs. STATIC: 5260 Lbs.		DYNAMIC: 2326 Lbs.-in. STATIC: 4600 Lbs.-in.	
RADIAL PLAY	CONTACT ANGLE		LIMITING SPEED	
0.0016 0.0026	N/A		1000 RPM	
LUBRICATION	SEAL		BEARING WEIGHT	
LIGHT OIL PRESERVATIVE	N/A		0.45 Lbs.	

UNLESS OTHERWISE SPECIFIED ALL DIMENSIONS IN INCHES



**Corporate Headquarters**  
 15151 Praire Drive  
 Covington, GA 30014  
 (800) 431-1980  
 www.ritbearing.com

Designed by ML	Checked by ML	This drawing and the information contained herein are proprietary and the property of Ritbearing Corporation.
-------------------	------------------	---

**RC040XP0**

Four Point Contact  
 Thin Section  
 Ball Bearing

File name RC040XP0	Date February 26, 2020	REVISION A	Sheet 1 of 1
-----------------------	---------------------------	---------------	-----------------