

Cage Code: 704Q7

RevNo	Revision note	Date	Signature	Checked
-------	---------------	------	-----------	---------

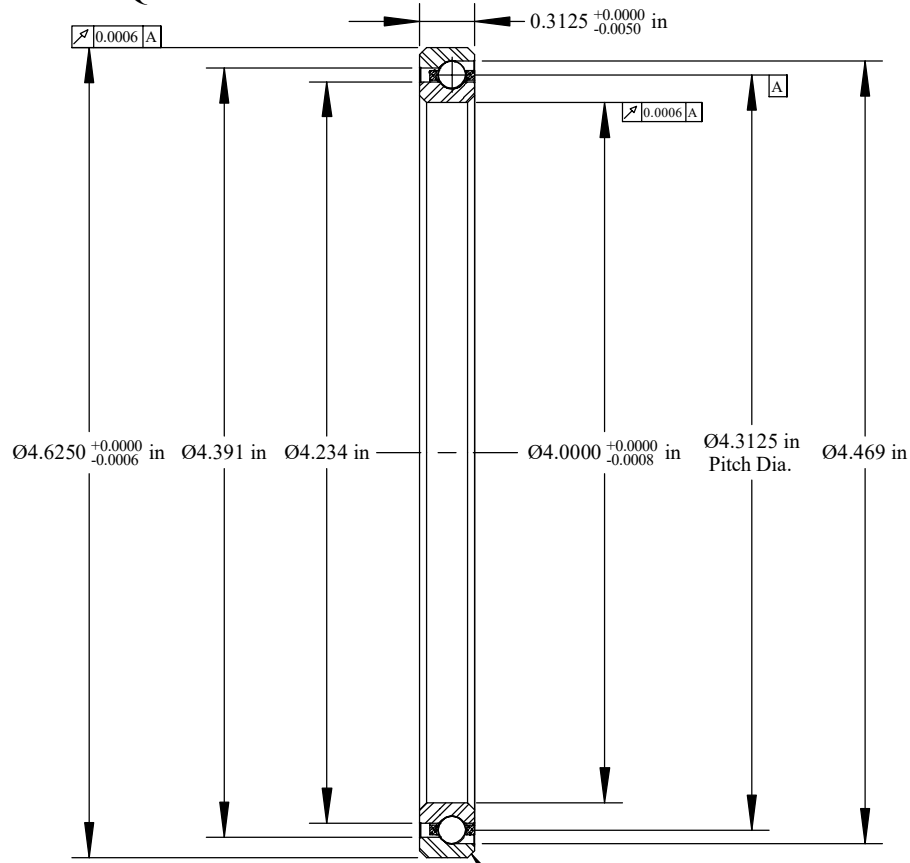

Scale: 1.25:1  
 Will Clear 0.040  
 Max. Fillet Radius  
 4 Exterior Corners

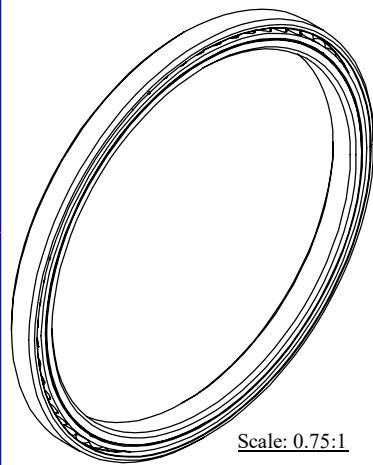

Scale: 0.75:1

	OUTER	INNER	SEPARATOR	BALL
MATERIAL	52100	52100	BRASS	52100
HARDNESS	Rc 59-62	Rc 59-62		
RACE RUN-OUT	OUTER	INNER		
ABEC RATING	PRELOAD		ROLLING ELEMENT QUANTITY	
1	N/A		58	5/32
RADIAL LOAD	THRUST LOAD		MOMENT LOAD	
DYNAMIC: 865 Lbs. STATIC: 2040 Lbs.	DYNAMIC: 2100 Lbs. STATIC: 5890 Lbs.		N/A	
RADIAL PLAY	CONTACT ANGLE		LIMITING SPEED	
N/A	30°		4,500 RPM	
LUBRICATION	SEAL		BEARING WEIGHT	
LIGHT OIL PRESERVATIVE	N/A		0.30 Lbs.	

UNLESS OTHERWISE SPECIFIED ALL DIMENSIONS IN INCHES

Designed by ML	Checked by ML	This drawing and the information contained herein are proprietary and the property of Rfbearing Corporation.
RB040AR0		Angular Contact Thin Section Ball Bearing
File name RB040AR0	Date April 6, 2020	REVISION A Sheet 1 of 1

**Corporate Headquarters**  
 18181 Prazer Drive  
 Covington, GA 30014  
 (800) 431-1980  
 www.rfbearing.com