

Cage Code: 704Q7

RevNo	Revision note	Date	Signature	Checked
-------	---------------	------	-----------	---------

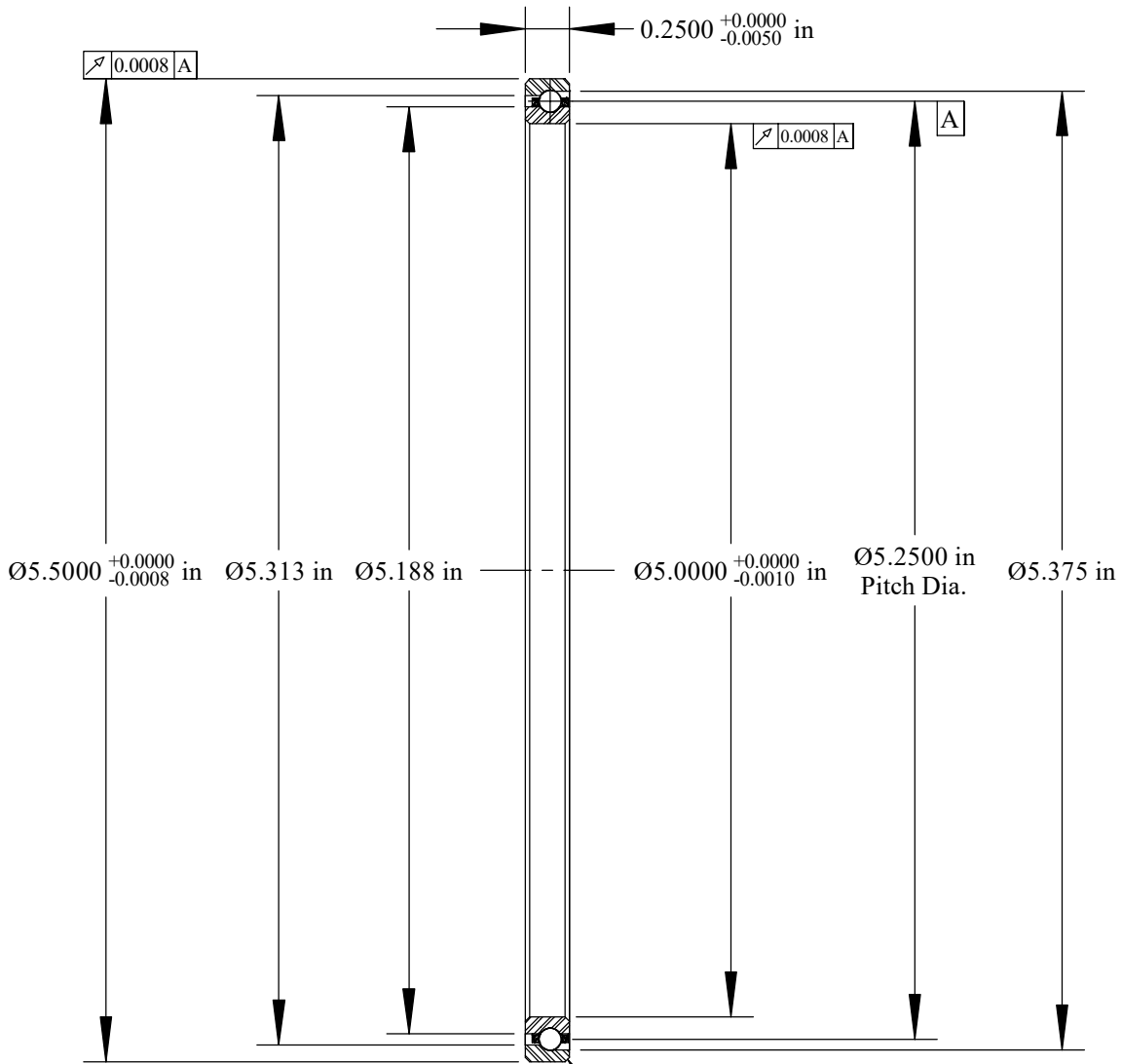

Scale: 1:1

Will Clear 0.025  
Max. Fillet Radius  
4 Exterior Corners

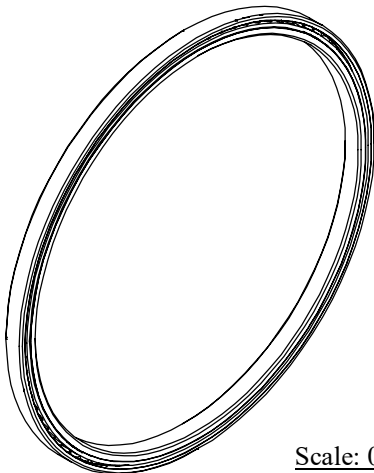

Scale: 0.5:1

	OUTER	INNER	SEPARATOR	BALL
MATERIAL	52100	52100	BRASS	Ceramic
HARDNESS	Rc 59-62	Rc 59-62		
RACE RUN-OUT	OUTER	INNER		
ABEC RATING	PRELOAD		ROLLING ELEMENT	
1	N/A		QUANTITY	SIZE
			84	1/8
RADIAL LOAD	THRUST LOAD		MOMENT LOAD	
DYNAMIC: 676 Lbs. STATIC: 1840 Lbs.	DYNAMIC: 1690 Lbs. STATIC: 5310 Lbs.		N/A	
AXIAL PRELOAD	CONTACT ANGLE		LIMITING SPEED	
N/A	30°		3,600 RPM	
LUBRICATION	SEAL		BEARING WEIGHT	
N/A	N/A		0.23 Lbs.	

UNLESS OTHERWISE SPECIFIED ALL DIMENSIONS IN INCHES

Designed by ML	Checked by ML	This drawing and the information contained herein are proprietary and the property of Ritbearing Corporation.
-------------------	------------------	---

**RA050AR0**

Radial Thin Section  
Ball Bearing

File name RA050AR0	Date March 30, 2020	REVISION A	Sheet 1 of 1
-----------------------	------------------------	---------------	-----------------



**Corporate Headquarters**  
15151 Prater Drive  
Covington, GA 30014  
(800) 431-1980  
www.ritbearing.com