

Cage Code: 704Q7

RevNo	Revision note	Date	Signature	Checked
-------	---------------	------	-----------	---------

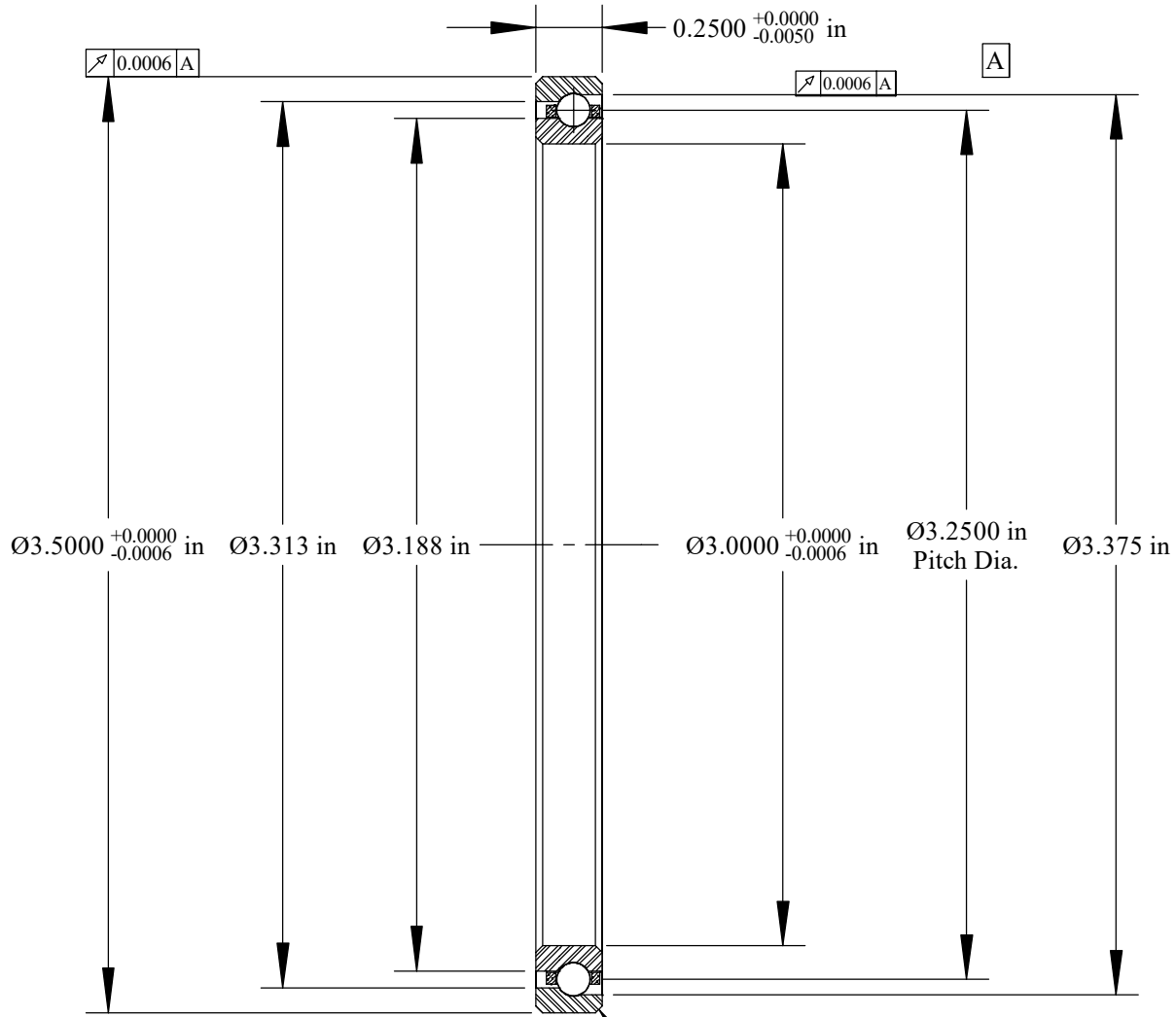

Will Clear 0.025
Max. Fillet Radius
4 Exterior Corners
Scale: 1.5:1

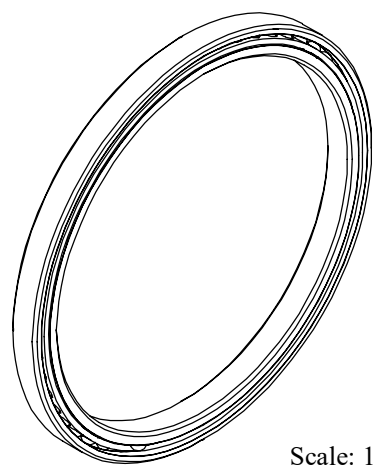

Scale: 1:1

	OUTER	INNER	SEPARATOR	BALL
MATERIAL	52100	52100	BRASS	Ceramic
HARDNESS	Rc 59-62	Rc 59-62		
RACE RUN-OUT	OUTER	INNER		
ABEC RATING	PRELOAD		ROLLING ELEMENT	
1	N/A		QUANTITY 52	SIZE 1/8
RADIAL LOAD	THRUST LOAD		MOMENT LOAD	
DYNAMIC: 507 Lbs. STATIC: 1140 Lbs.	DYNAMIC: 1230 Lbs. STATIC: 3290 Lbs.		N/A	
AXIAL PRELOAD	CONTACT ANGLE		LIMITING SPEED	
N/A	30°		6,000 RPM	
LUBRICATION	SEAL		BEARING WEIGHT	
N/A	N/A		0.14 Lbs.	

UNLESS OTHERWISE SPECIFIED ALL DIMENSIONS IN INCHES

Designed by ML	Checked by ML	This drawing and the information contained herein are proprietary and the property of Ritbearing Corporation.
-------------------	------------------	---

RA030AR0

Radial Thin Section Ball Bearing

File name RA030AR0	Date March 30, 2020	REVISION A	Sheet 1 of 1
-----------------------	------------------------	---------------	-----------------



Corporate Headquarters
15151 Prazer Drive
Covington, GA 30014
(800) 431-1980
www.ritbearing.com