

Cage Code: 704Q7

RevNo	Revision note	Date	Signature	Checked
-------	---------------	------	-----------	---------

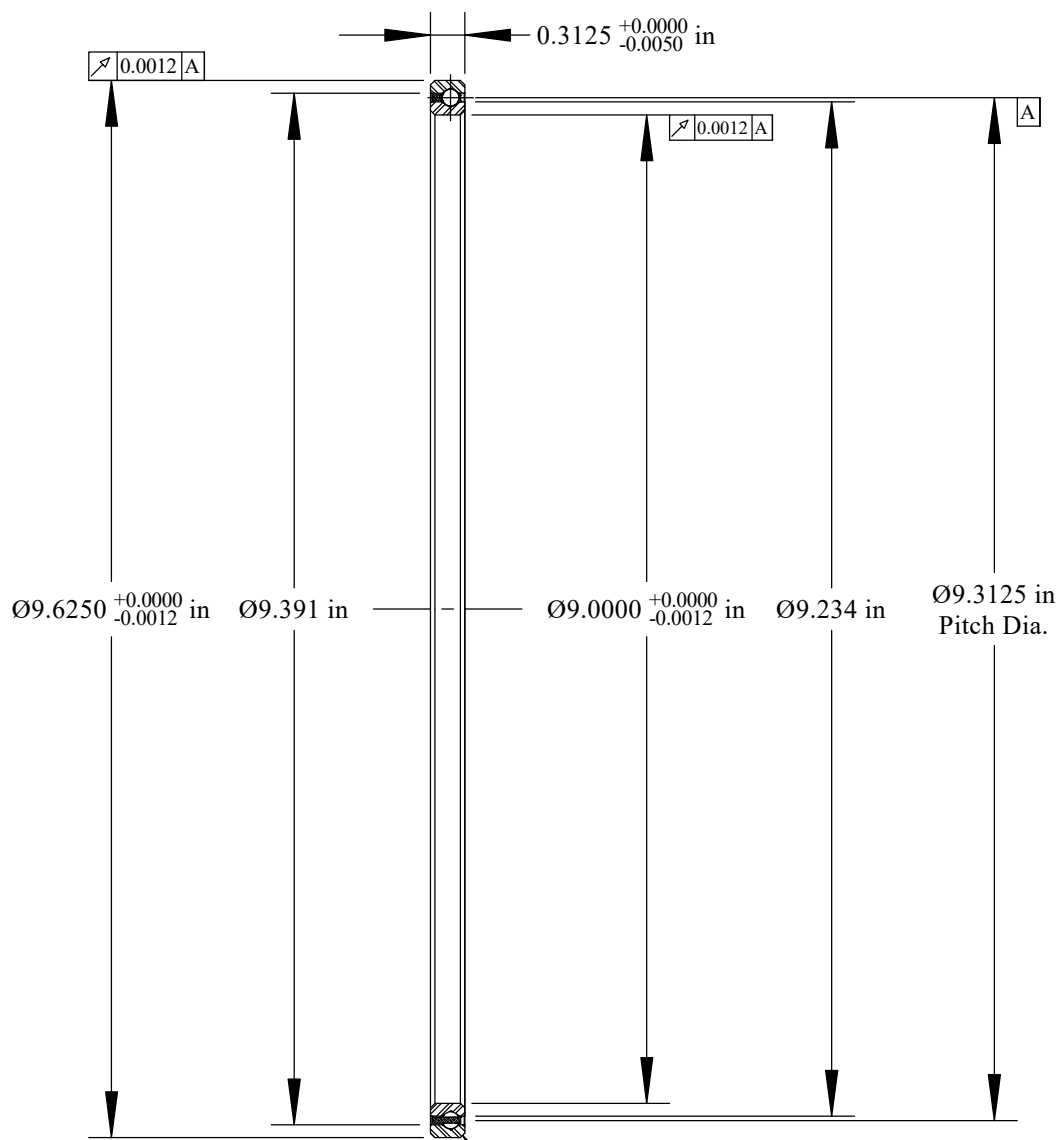

Will Clear 0.040  
Max. Fillet Radius  
4 Exterior Corners  
Scale: 0.6:1

	OUTER	INNER	SEPARATOR	BALL
MATERIAL	52100	52100	BRASS	52100
HARDNESS	Rc 59-62	Rc 59-62		
RACE RUN-OUT	OUTER	INNER		
ABEC RATING	PRELOAD		ROLLING ELEMENT	
1	N/A		QUANTITY	SIZE
			93	5/32
RADIAL LOAD	THRUST LOAD		MOMENT LOAD	
DYNAMIC: 1732 Lbs. STATIC: 3780 Lbs.	DYNAMIC: 2880 Lbs. STATIC: 9450 Lbs.		DYNAMIC: 6050 Lbs.-in. STATIC: 17,600 Lbs.-in.	
RADIAL PLAY	CONTACT ANGLE		LIMITING SPEED	
0.0024 0.0034	N/A		340 RPM	
LUBRICATION	SEAL		BEARING WEIGHT	
LIGHT OIL PRESERVATIVE	N/A		0.66 Lbs.	

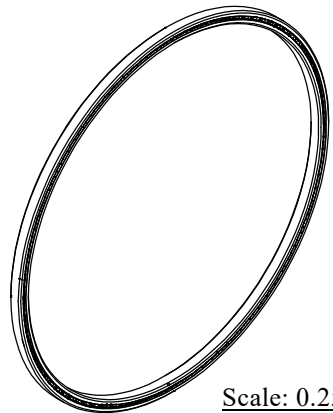

Scale: 0.25:1

**SSD** thin section bearings

Corporate Headquarters  
15151 Prater Drive  
Covington, GA 30014  
(800) 431-1980  
www.ritbearing.com

UNLESS OTHERWISE SPECIFIED ALL DIMENSIONS IN INCHES

Designed by ML	Checked by ML	This drawing and the information contained herein are proprietary and the property of Ritbearing Corporation.	
<b>RB090XP0</b>		Four Point Contact Thin Section Ball Bearing	
File name RB090XP0	Date February 24, 2020	REVISION A	Sheet 1 of 1