

Cage Code: 704Q7

RevNo	Revision note	Date	Signature	Checked
-------	---------------	------	-----------	---------

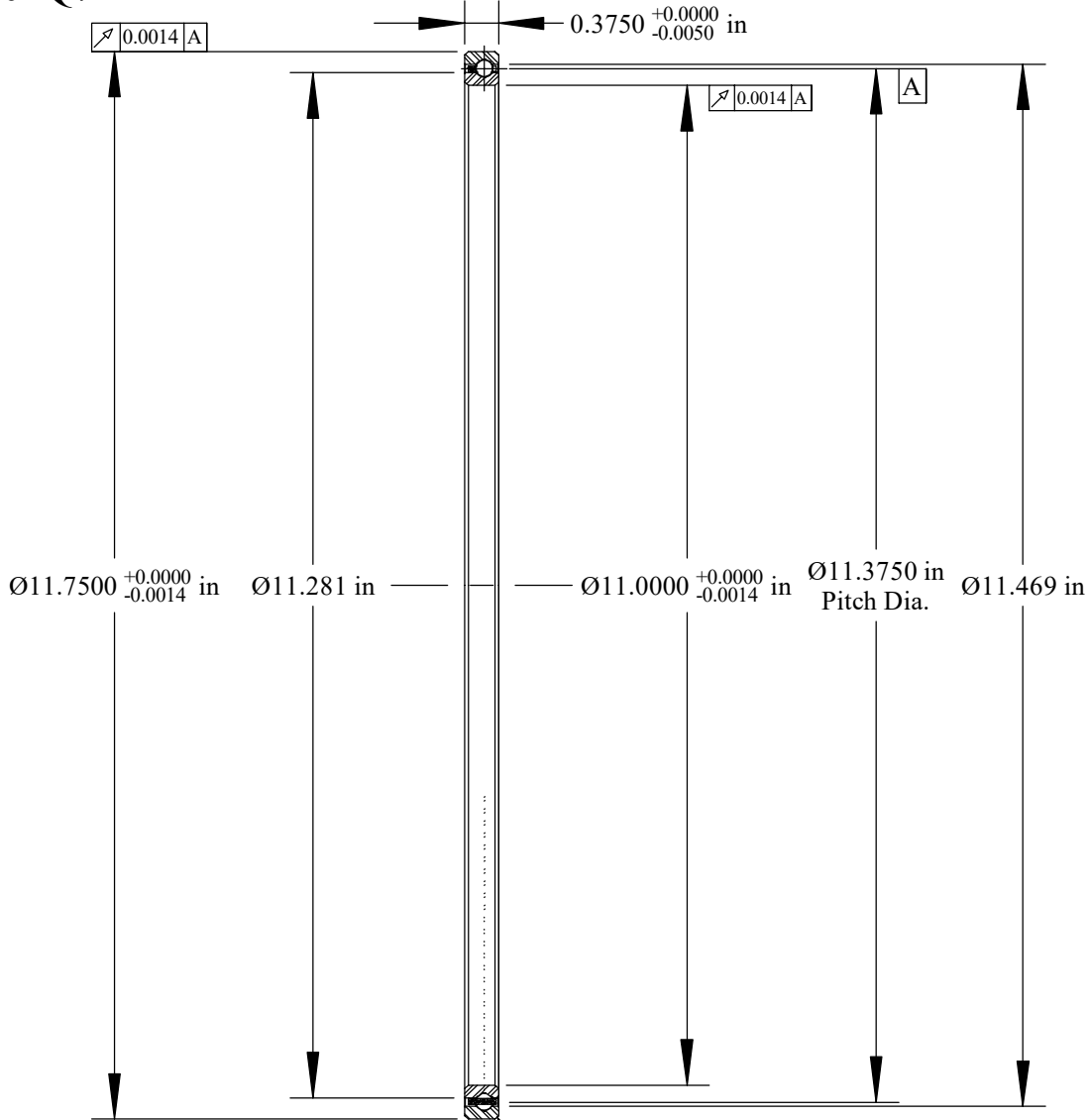

Will Clear 0.040  
Max. Fillet Radius  
4 Exterior Corners  
Scale: 0.5:1

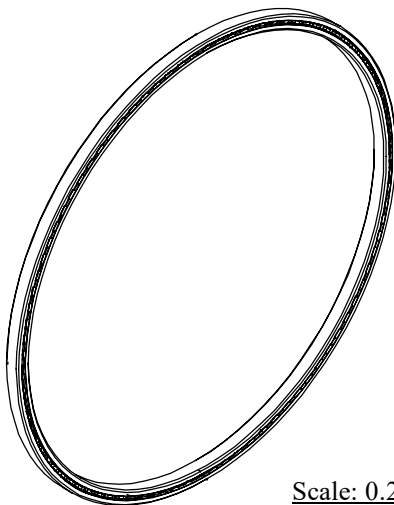

Scale: 0.25:1

	OUTER	INNER	SEPARATOR	BALL
MATERIAL	52100	52100	BRASS	52100
HARDNESS	Re 59-62	Re 59-62		
RACE RUN-OUT	OUTER	INNER		
ABEC RATING	PRELOAD		ROLLING ELEMENT	
1	N/A		QUANTITY 91	SIZE 3/16
RADIAL LOAD	THRUST LOAD		MOMENT LOAD	
DYNAMIC: 2496 Lbs. STATIC: 5470 Lbs.	DYNAMIC: 4180 Lbs. STATIC: 13,680 Lbs.		DYNAMIC: 10,651 Lbs. STATIC: 31,110 Lbs.	
RADIAL PLAY	CONTACT ANGLE		LIMITING SPEED	
0.0028 0.0038	N/A		272 RPM	
LUBRICATION	SEAL		BEARING WEIGHT	
LIGHT OIL PRESERVATIVE	N/A		1.16 Lbs.	

UNLESS OTHERWISE SPECIFIED ALL DIMENSIONS IN INCHES

Designed by ML	Checked by ML	This drawing and the information contained herein are proprietary and the property of Ritbearing Corporation.
-------------------	------------------	---

RC110XP0

4 Point Contact Thin  
Section Ball Bearing

File name RC110XP0	Date September 23, 2019	REVISION A	Sheet 1 of 1
-----------------------	----------------------------	---------------	-----------------

**SSB** BRAND  
thin section bearings

**Corporate Headquarters**  
15151 Prater Drive  
Covington, GA 30014  
(800) 431-1980  
www.ritbearing.com