

Cage Code: 704Q7

RevNo	Revision note	Date	Signature	Checked
-------	---------------	------	-----------	---------

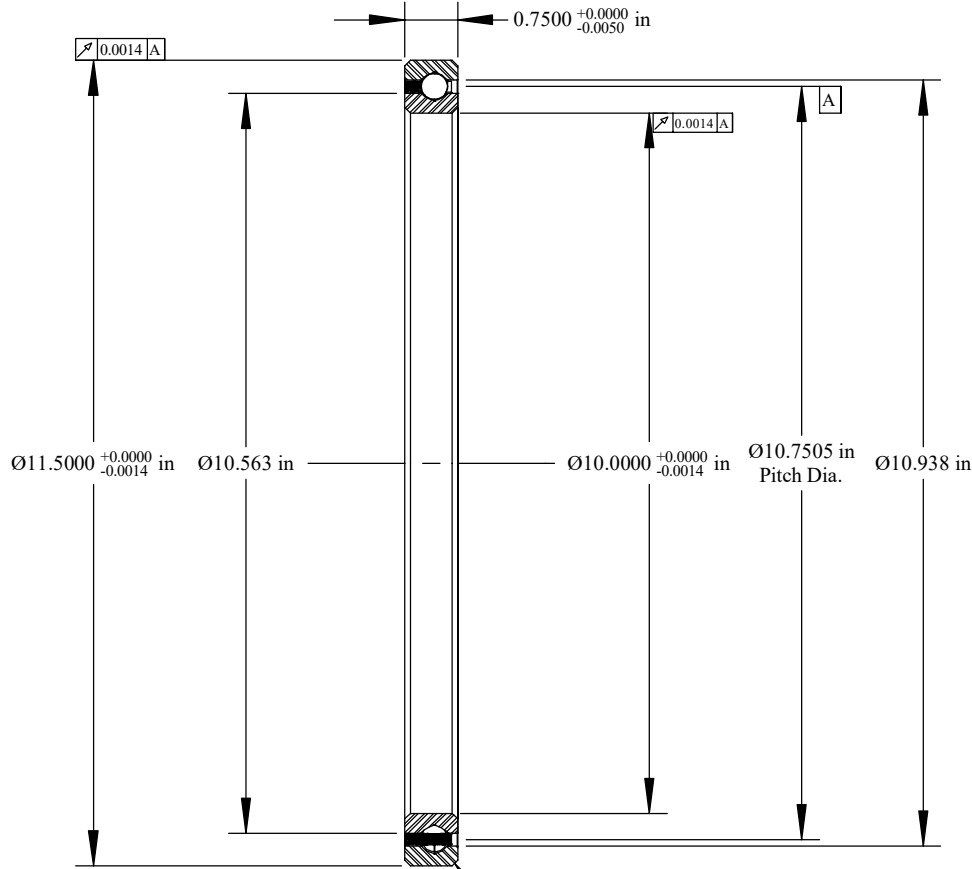

Scale: 0.5:1
 Will Clear 0.080
 Max. Fillet Radius
 4 Exterior Corners

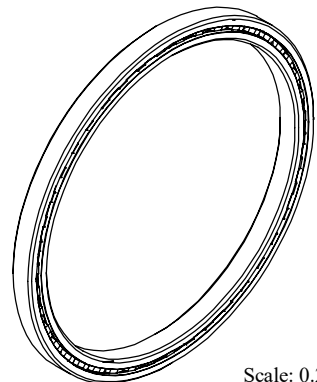

Scale: 0.25:1

	OUTER	INNER	SEPARATOR	BALL
MATERIAL	52100	52100	BRASS	52100
HARDNESS	Rc 59-62	Rc 59-62		
RACE RUN-OUT	OUTER	INNER		
ABEC RATING	PRELOAD		ROLLING ELEMENT	
1	N/A		QUANTITY	SIZE
			43	3/8
RADIAL LOAD	THRUST LOAD		MOMENT LOAD	
DYNAMIC: 7342 Lbs. STATIC: 12,130 Lbs.	DYNAMIC: 11,700 Lbs. STATIC: 30,330 Lbs.		DYNAMIC: 29,608 Lbs.-in STATIC: 65,210 Lbs.-in	
RADIAL PLAY	CONTACT ANGLE		LIMITING SPEED	
0.0028 0.0038	N/A		325 RPM	
LUBRICATION	SEAL		BEARING WEIGHT	
LIGHT OIL PRESERVATIVE	N/A		4.30 Lbs.	

UNLESS OTHERWISE SPECIFIED ALL DIMENSIONS IN INCHES

Designed by ML	Checked by ML	This drawing and the information contained herein are proprietary and the property of Rfbearing Corporation.
RF100XP0		Radial Thin Section Ball Bearing
File name RF100XP0	Date April 17, 2019	REVISION A Sheet 1 of 1

Corporate Headquarters
 18181 Prater Drive
 Covington, GA 30014
 (800) 431-1980
 www.rfbearing.com