

Cage Code: 704Q7

| | | | | |
|-------|---------------|------|-----------|---------|
| RevNo | Revision note | Date | Signature | Checked |
|-------|---------------|------|-----------|---------|

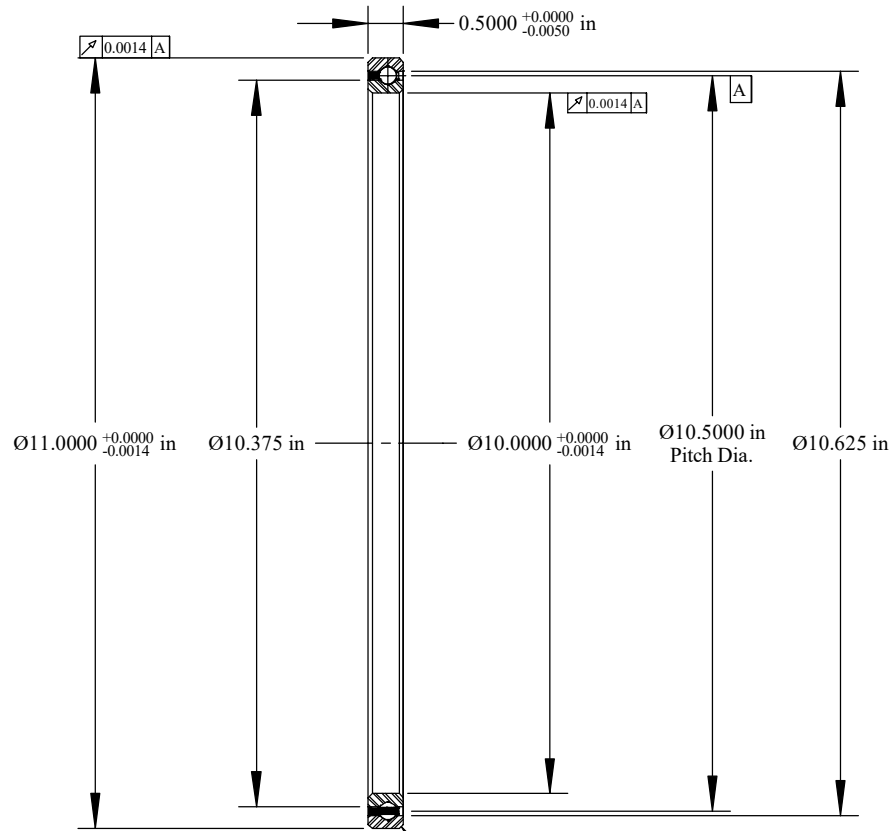

Scale: 0.5:1
 Will Clear 0.060
 Max. Fillet Radius
 4 Exterior Corners

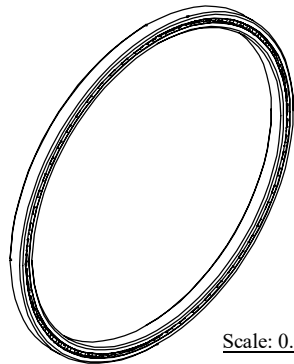

Scale: 0.25:1

| | | | | |
|---|---|----------|---|-------|
| | OUTER | INNER | SEPARATOR | BALL |
| MATERIAL | 52100 | 52100 | BRASS | 52100 |
| HARDNESS | Rc 59-62 | Rc 59-62 | | |
| RACE RUN-OUT | OUTER | INNER | | |
| ABEC RATING | PRELOAD | | ROLLING ELEMENT | |
| 1 | N/A | | QUANTITY | SIZE |
| | | | 63 | 1/4 |
| RADIAL LOAD | THRUST LOAD | | MOMENT LOAD | |
| DYNAMIC: 3776 Lbs. STATIC: 7180 Lbs. | DYNAMIC: 6190 Lbs. STATIC: 17,960 Lbs. | | DYNAMIC: 14,872 Lbs.-in. STATIC: 37,710 Lbs.-in. | |
| RADIAL PLAY | CONTACT ANGLE | | LIMITING SPEED | |
| 0.0028 0.0038 | N/A | | 360 RPM | |
| LUBRICATION | SEAL | | BEARING WEIGHT | |
| LIGHT OIL PRESERVATIVE | N/A | | 1.88 Lbs. | |

UNLESS OTHERWISE SPECIFIED ALL DIMENSIONS IN INCHES

| | | |
|-------------------|------------------|--|
| Designed by ML | Checked by ML | This drawing and the information contained herein are proprietary and the property of Ritzbearing Corporation. |
|-------------------|------------------|--|

RD100XP0

Radial Thin Section Ball Bearing

| | | | |
|-----------------------|-----------------------|---------------|-----------------|
| File name RD100XP0 | Date July 25, 2018 | REVISION A | Sheet 1 of 1 |
|-----------------------|-----------------------|---------------|-----------------|

Corporate Headquarters
 15151 Praire Drive
 Covington, GA 30014
 (800) 431-1980
 www.ritzbearing.com