

Cage Code: 704Q7

RevNo	Revision note	Date	Signature	Checked
-------	---------------	------	-----------	---------

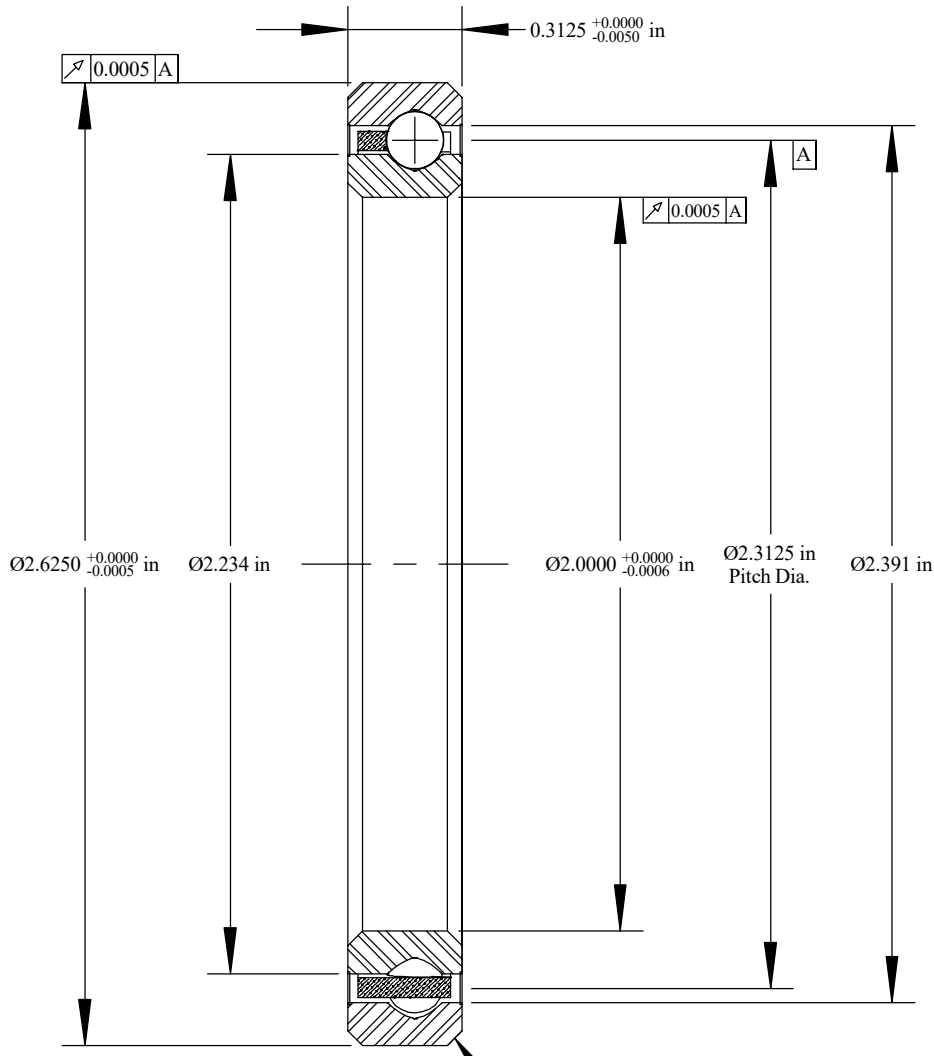

Scale: 2:1

Will Clear 0.040  
Max. Fillet Radius  
4 Exterior Corners

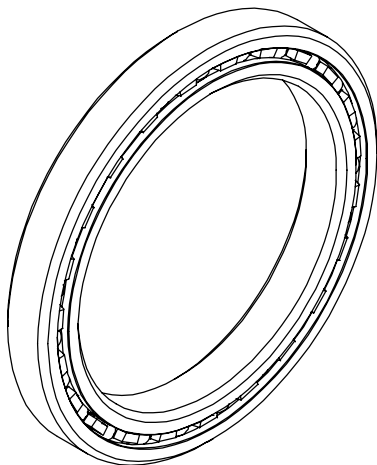

Scale: 1:1

	OUTER	INNER	SEPARATOR	BALL
MATERIAL	52100	52100	BRASS	52100
HARDNESS	Rc 59-62	Rc 59-62		
RACE RUN-OUT	OUTER	INNER		
ABEC RATING	PRELOAD		ROLLING ELEMENT	
1	N/A		QUANTITY	SIZE
			23	5/32
RADIAL LOAD	THRUST LOAD		MOMENT LOAD	
DYNAMIC: 758 Lbs. STATIC: 930 Lbs.	DYNAMIC: 1130 Lbs. STATIC: 2340 Lbs.		DYNAMIC: 658 Lbs.-in. STATIC: 1080 Lbs.-in.	
RADIAL PLAY	CONTACT ANGLE		LIMITING SPEED	
0.0012 0.0022	N/A		2,000 RPM	
LUBRICATION	SEAL		BEARING WEIGHT	
LIGHT OIL PRESERVATIVE	N/A		0.16 Lbs.	

UNLESS OTHERWISE SPECIFIED ALL DIMENSIONS IN INCHES

Designed by ML	Checked by ML	This drawing and the information contained herein are proprietary and the property of Ritbearing Corporation.
-------------------	------------------	---

**RB020XP0**

Four Point Contact  
Thin Section  
Ball Bearing

File name RB020XP0	Date July 3, 2018	REVISION A	Sheet 1 of 1
-----------------------	----------------------	---------------	-----------------



**Corporate Headquarters**  
15151 Prater Drive  
Covington, GA 30014  
(800) 431-1980  
www.ritbearing.com