

Cage Code: 704Q7

| | | | | |
|-------|---------------|------|-----------|---------|
| RevNo | Revision note | Date | Signature | Checked |
|-------|---------------|------|-----------|---------|

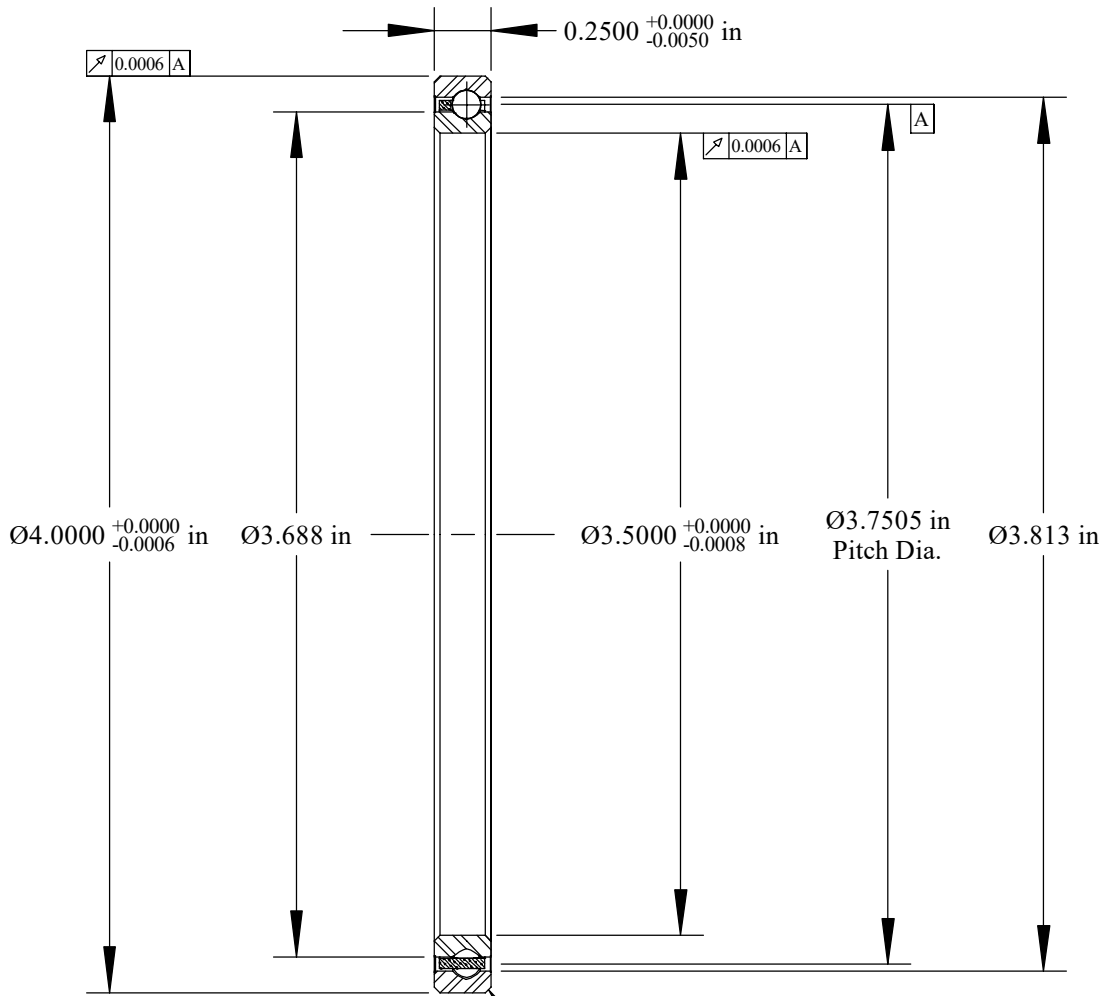

Scale: 1.25:1
 Will Clear 0.025
 Max. Fillet Radius
 4 Exterior Corners

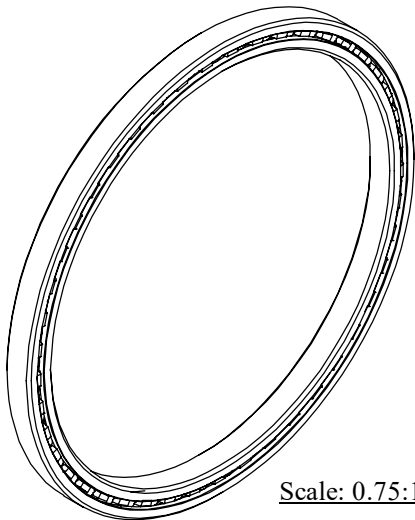

Scale: 0.75:1

| | | | | |
|--|---|----------|--|-------|
| | OUTER | INNER | SEPARATOR | BALL |
| MATERIAL | 52100 | 52100 | BRASS | 52100 |
| HARDNESS | Rc 59-62 | Rc 59-62 | | |
| RACE RUN-OUT | OUTER | INNER | | |
| ABEC RATING | PRELOAD | | ROLLING ELEMENT | |
| 1 | N/A | | QUANTITY | SIZE |
| | | | 45 | 1/8 |
| RADIAL LOAD | THRUST LOAD | | MOMENT LOAD | |
| DYNAMIC: 701 Lbs. STATIC: 1140 Lbs. | DYNAMIC: 1110 Lbs. STATIC: 2850 Lbs. | | DYNAMIC: 986 Lbs. STATIC: 2130 Lbs. | |
| RADIAL PLAY | CONTACT ANGLE | | LIMITING SPEED | |
| 0.0016 0.0026 | N/A | | 1,000 RPM | |
| LUBRICATION | SEAL | | BEARING WEIGHT | |
| LIGHT OIL PRESERVATIVE | N/A | | 0.18 Lbs. | |

UNLESS OTHERWISE SPECIFIED ALL DIMENSIONS IN INCHES

| | | |
|-------------------|------------------|---|
| Designed by ML | Checked by ML | This drawing and the information contained herein are proprietary and the property of Ritbearing Corporation. |
|-------------------|------------------|---|

RA035XP0

Radial Thin Section
Ball Bearing

| | | | |
|-----------------------|---------------------------|---------------|-----------------|
| File name RA035XP0 | Date February 28, 2017 | REVISION A | Sheet 1 of 1 |
|-----------------------|---------------------------|---------------|-----------------|



Corporate Headquarters
 15151 Prater Drive
 Covington, GA 30014
 (800) 431-1980
 www.ritbearing.com