

Cage Code: 704Q7

RevNo	Revision note	Date	Signature	Checked
-------	---------------	------	-----------	---------

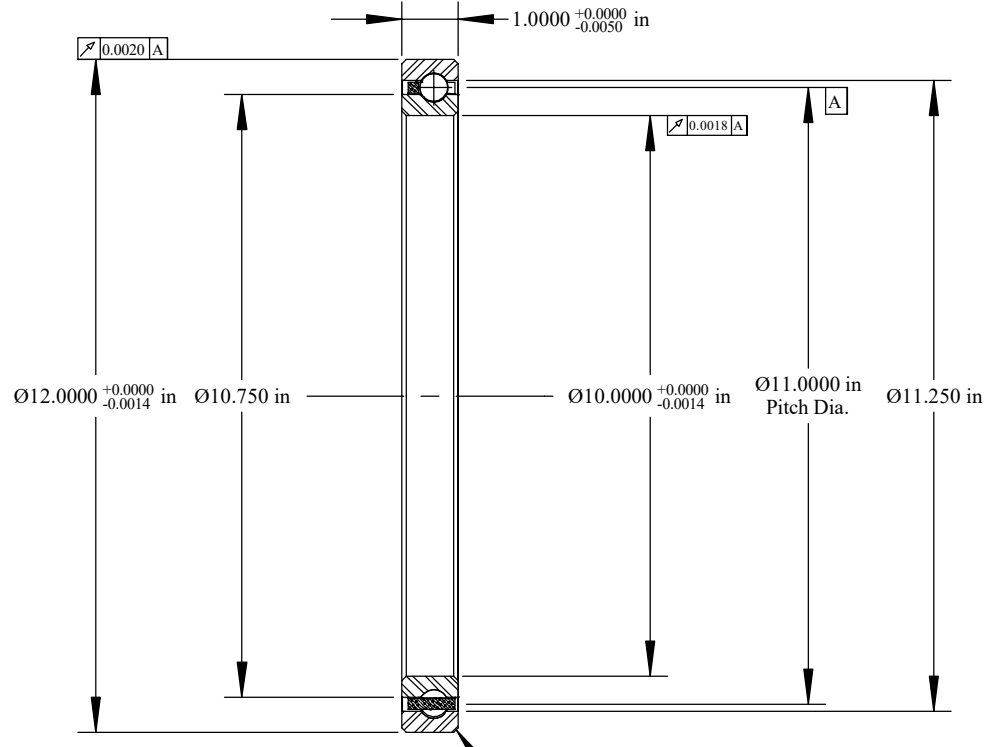

Scale: 0.4:1 Will Clear 0.080  
Max. Fillet Radius  
4 Exterior Corners

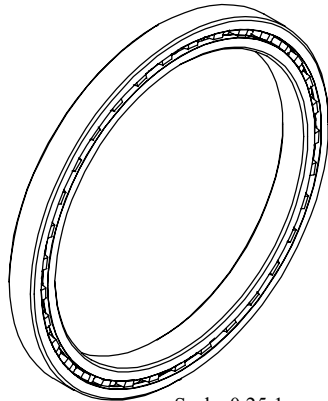

Scale: 0.25:1

	OUTER	INNER	SEPARATOR	BALL
MATERIAL	52100	52100	BRASS	52100
HARDNESS	Rc 59-62	Rc 59-62		
RACE RUN-OUT	OUTER	INNER		
ABEC RATING	PRELOAD		ROLLING ELEMENT QUANTITY	
1	N/A		33	1/2
RADIAL LOAD	THRUST LOAD		MOMENT LOAD	
DYNAMIC: 9204 Lbs. STATIC: 18,060 Lbs.	N/A		N/A	
RADIAL PLAY	CONTACT ANGLE		LIMITING SPEED	
0.0028 0.0048	N/A		1,800 RPM	
LUBRICATION	SEAL		BEARING WEIGHT	
LIGHT OIL PRESERVATIVE	N/A		7.90 Lbs.	

UNLESS OTHERWISE SPECIFIED ALL DIMENSIONS IN INCHES

Designed by ML	Checked by ML	This drawing and the information contained herein are proprietary and the property of Rfbearing Corporation.
<b>RG100CP0</b>		Radial Thin Section Ball Bearing
File name RG100CP0	Date September 8, 2017	REVISION A Sheet 1 of 1

**Corporate Headquarters**  
18181 Praire Drive  
Covington, GA 30014  
(800) 431-1980  
www.rfbearing.com