

Cage Code: 704Q7

RevNo	Revision note	Date	Signature	Checked
-------	---------------	------	-----------	---------

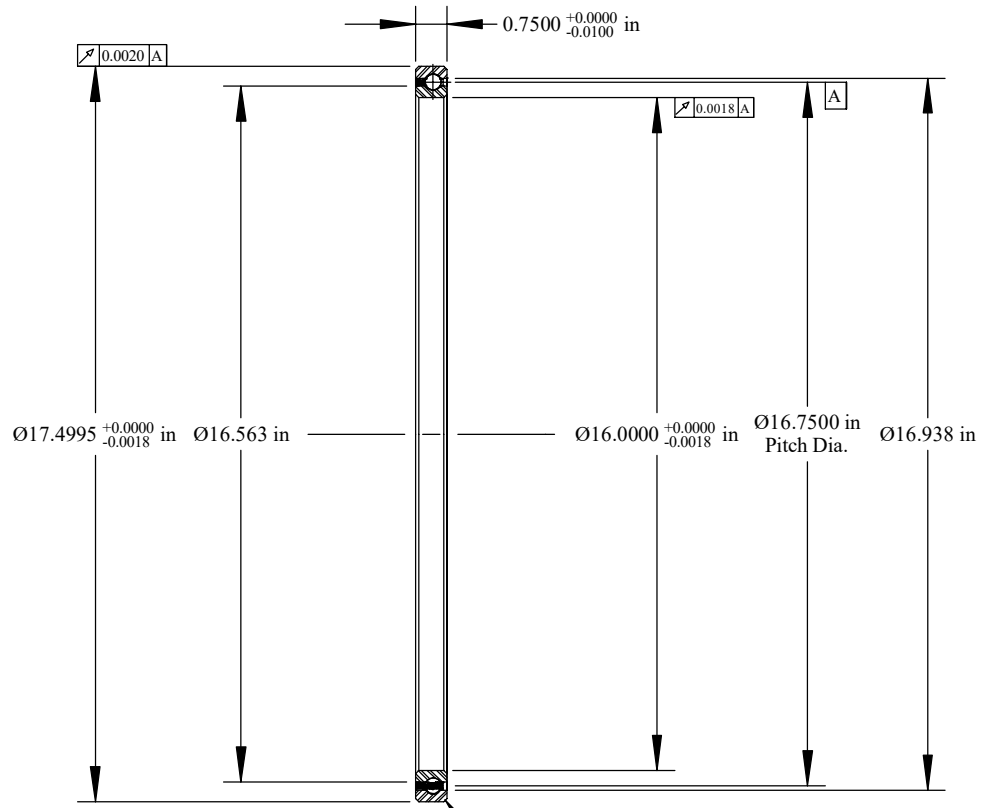

Will Clear 0.080
Max. Fillet Radius
4 Exterior Corners
Scale: 0.3:1

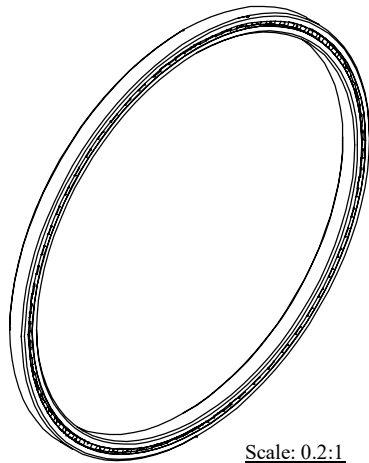

Scale: 0.2:1

	OUTER	INNER	SEPARATOR	BALL
MATERIAL	52100	52100	BRASS	52100
HARDNESS	Rc 59-62	Rc 59-62		
RACE RUN-OUT	OUTER	INNER		
ABEC RATING	PRELOAD		ROLLING ELEMENT QUANTITY	
1	N/A		67	3/8
RADIAL LOAD		THRUST LOAD		MOMENT LOAD
DYNAMIC: 7104 Lbs. STATIC: 18900 Lbs.		N/A		N/A
RADIAL PLAY		CONTACT ANGLE		LIMITING SPEED
0.0036 0.0056		N/A		937 RPM
LUBRICATION		SEAL		BEARING WEIGHT
LIGHT OIL PRESERVATIVE		N/A		7.10 Lbs.

UNLESS OTHERWISE SPECIFIED ALL DIMENSIONS IN INCHES

Designed by ML	Checked by ML	This drawing and the information contained herein are proprietary and the property of Rfbearing Corporation.
RF160CP0		
File name RF160CP0	Date September 7, 2017	REVISION A
		Sheet 1 of 1

Corporate Headquarters
18181 Praire Drive
Covington, GA 30014
(800) 431-1980
www.rfbearing.com