

Cage Code: 704Q7

RevNo	Revision note	Date	Signature	Checked
-------	---------------	------	-----------	---------

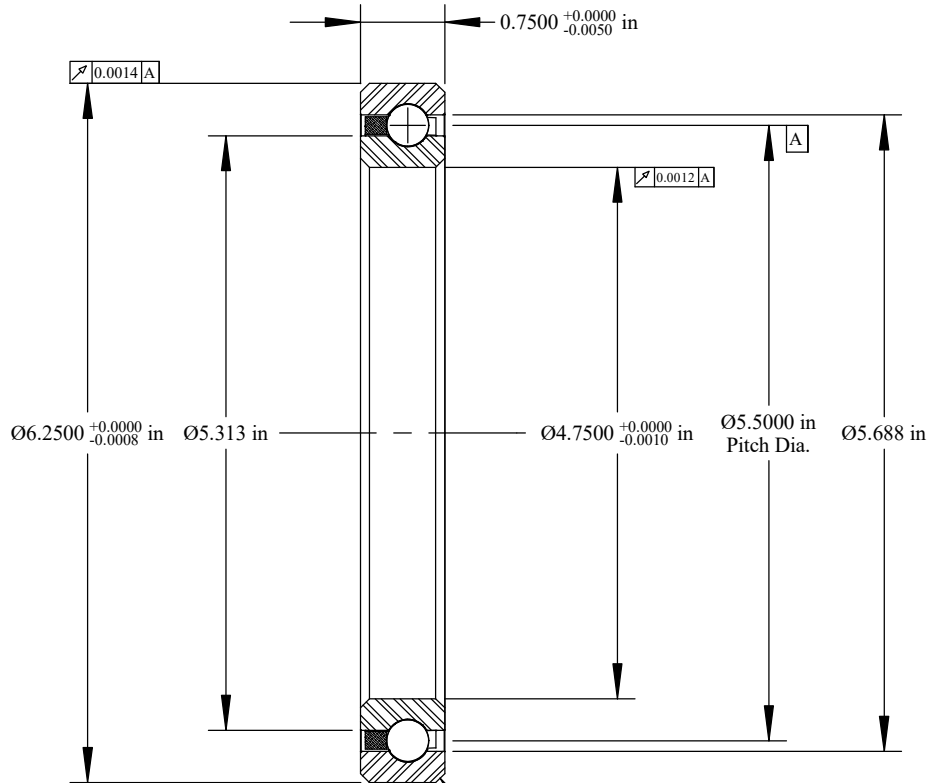

Scale: 0.8:1  
Will Clear 0.040  
Max. Fillet Radius  
4 Exterior Corners

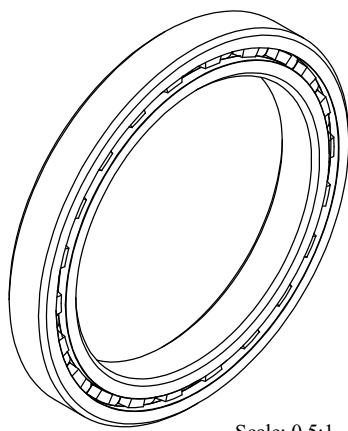

Scale: 0.5:1

	OUTER	INNER	SEPARATOR	BALL
MATERIAL	52100	52100	BRASS	52100
HARDNESS	Re 59-62	Re 59-62		
RACE RUN-OUT	OUTER	INNER		
ABEC RATING	PRELOAD		ROLLING ELEMENT	
1	N/A		QUANTITY	SIZE
			22	3/8
RADIAL LOAD	THRUST LOAD		MOMENT LOAD	
DYNAMIC: 3843 Lbs. STATIC: 6210 Lbs.	N/A		N/A	
RADIAL PLAY	CONTACT ANGLE		LIMITING SPEED	
0.0020 0.0034	N/A		4,400 RPM	
LUBRICATION	SEAL		BEARING WEIGHT	
LIGHT OIL PRESERVATIVE	N/A		2.20 Lbs.	

UNLESS OTHERWISE SPECIFIED ALL DIMENSIONS IN INCHES

Designed by ML	Checked by ML	This drawing and the information contained herein are proprietary and the property of Ritbearing Corporation.
-------------------	------------------	---

**RF047CP0** Radial Thin Section Ball Bearing

File name RF047CP0	Date August 3, 2017	REVISION A	Sheet 1 of 1
-----------------------	------------------------	---------------	-----------------

**SSD**  
thin section bearings

Corporate Headquarters  
15151 Prater Drive  
Covington, GA 30014  
(800) 431-1900  
www.ritbearing.com