

Cage Code: 704Q7

RevNo	Revision note	Date	Signature	Checked
-------	---------------	------	-----------	---------

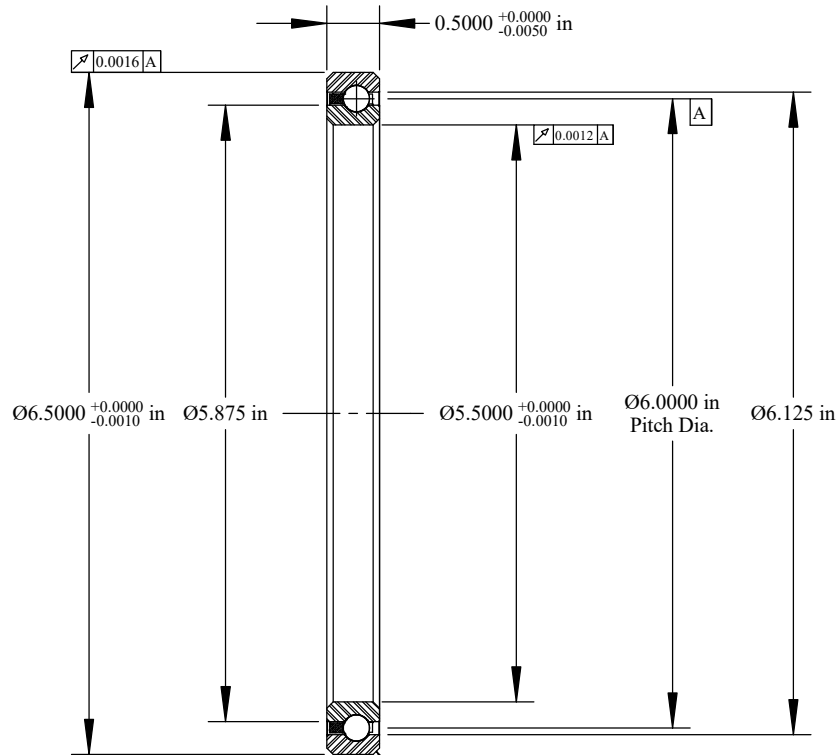

Scale: 0.75:1
 Will Clear 0.060
 Max. Fillet Radius
 4 Exterior Corners

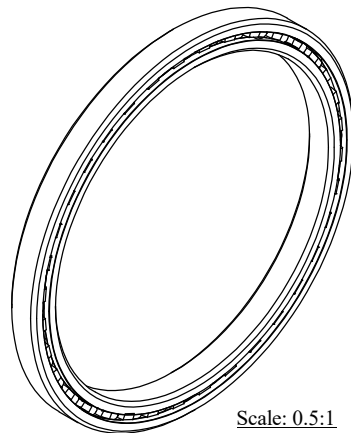

Scale: 0.5:1

	OUTER	INNER	SEPARATOR	BALL
MATERIAL	52100	52100	BRASS	52100
HARDNESS	Re 59-62	Re 59-62		
RACE RUN-OUT	OUTER	INNER		
ABEC RATING	PRELOAD		ROLLING ELEMENT QUANTITY	
1	N/A		36	1/4
RADIAL LOAD	THRUST LOAD		MOMENT LOAD	
DYNAMIC: 2063 Lbs. STATIC: 4100 Lbs.	N/A		N/A	
RADIAL PLAY	CONTACT ANGLE		LIMITING SPEED	
0.0020 0.0034	N/A		3,250 RPM	
LUBRICATION	SEAL		BEARING WEIGHT	
LIGHT OIL PRESERVATIVE	N/A		1.06 Lbs.	

UNLESS OTHERWISE SPECIFIED ALL DIMENSIONS IN INCHES

Designed by ML	Checked by ML	This drawing and the information contained herein are proprietary and the property of Ritbearing Corporation.
-------------------	------------------	---

RD055CP0

Radial Thin Section Ball Bearing

File name RD055CP0	Date July 21, 2017	REVISION A	Sheet 1 of 1
-----------------------	-----------------------	---------------	-----------------

SSD
thin section bearings

Corporate Headquarters
 15151 Prater Drive
 Covington, GA 30014
 (800) 431-1900
 www.ritbearing.com