

Cage Code: 704Q7

RevNo	Revision note	Date	Signature	Checked
-------	---------------	------	-----------	---------

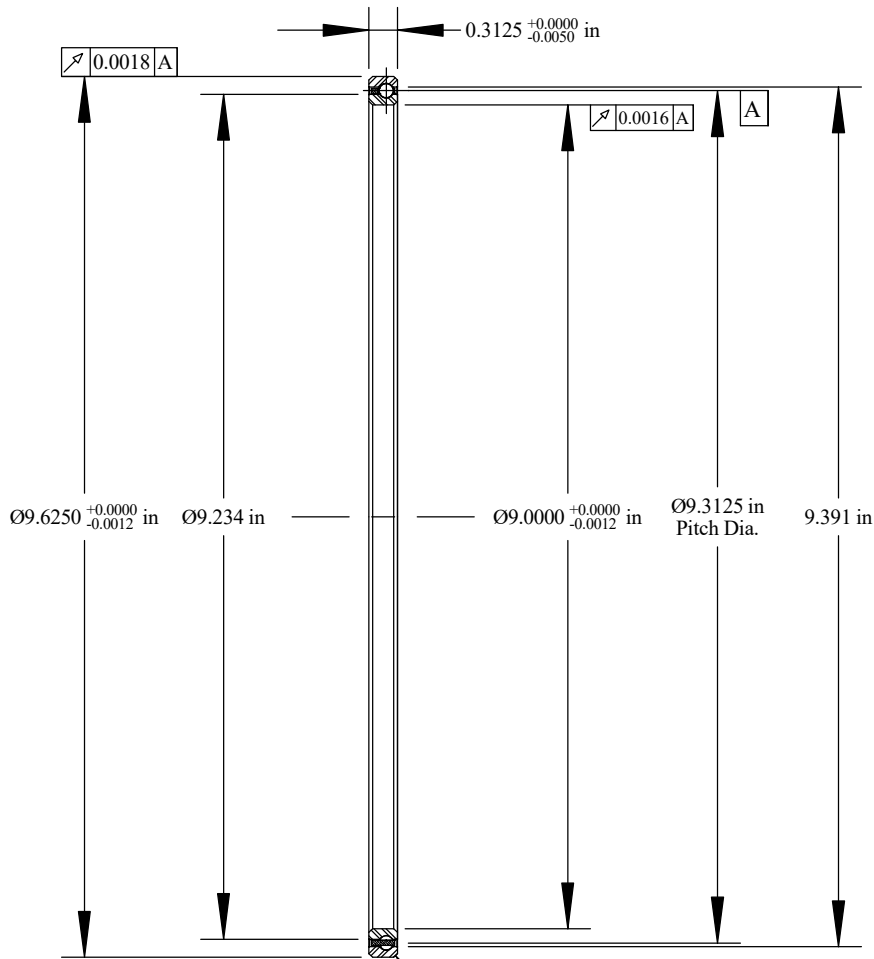

Scale: 0.5:1

Will Clear 0.040  
Max. Fillet Radius  
4 Exterior Corners

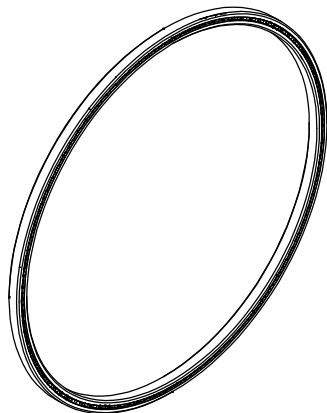

Scale: 0.25:1

	OUTER	INNER	SEPARATOR	BALL
MATERIAL	52100	52100	BRASS	52100
HARDNESS	Rc 59-62	Rc 59-62		
RACE RUN-OUT	OUTER	INNER		
ABEC RATING	PRELOAD		ROLLING ELEMENT	
1	N/A		QUANTITY	SIZE
			93	5/32
RADIAL LOAD	THRUST LOAD		MOMENT LOAD	
DYNAMIC: 1304 Lbs. STATIC: 3780 Lbs.	N/A		N/A	
RADIAL PLAY	CONTACT ANGLE		LIMITING SPEED	
0.0024 0.0042	N/A		1,725 RPM	
LUBRICATION	SEAL		BEARING WEIGHT	
LIGHT OIL PRESERVATIVE	N/A		0.66 Lbs.	

UNLESS OTHERWISE SPECIFIED ALL DIMENSIONS IN INCHES

Designed by  
ML

Checked by  
ML

This drawing and the information  
contained herein are proprietary and  
the property of Ritbearing Corporation.

**RB090CP0**

Radial Thin Section  
Ball Bearing

File name  
RB090CP0

Date  
June 15, 2017

REVISION  
A

Sheet  
1 of 1



**Corporate Headquarters**  
**15151 Prater Drive**  
**Covington, GA 30014**  
**(800) 431-1980**  
**www.ritbearing.com**