

Cage Code: 704Q7

RevNo	Revision note	Date	Signature	Checked
-------	---------------	------	-----------	---------

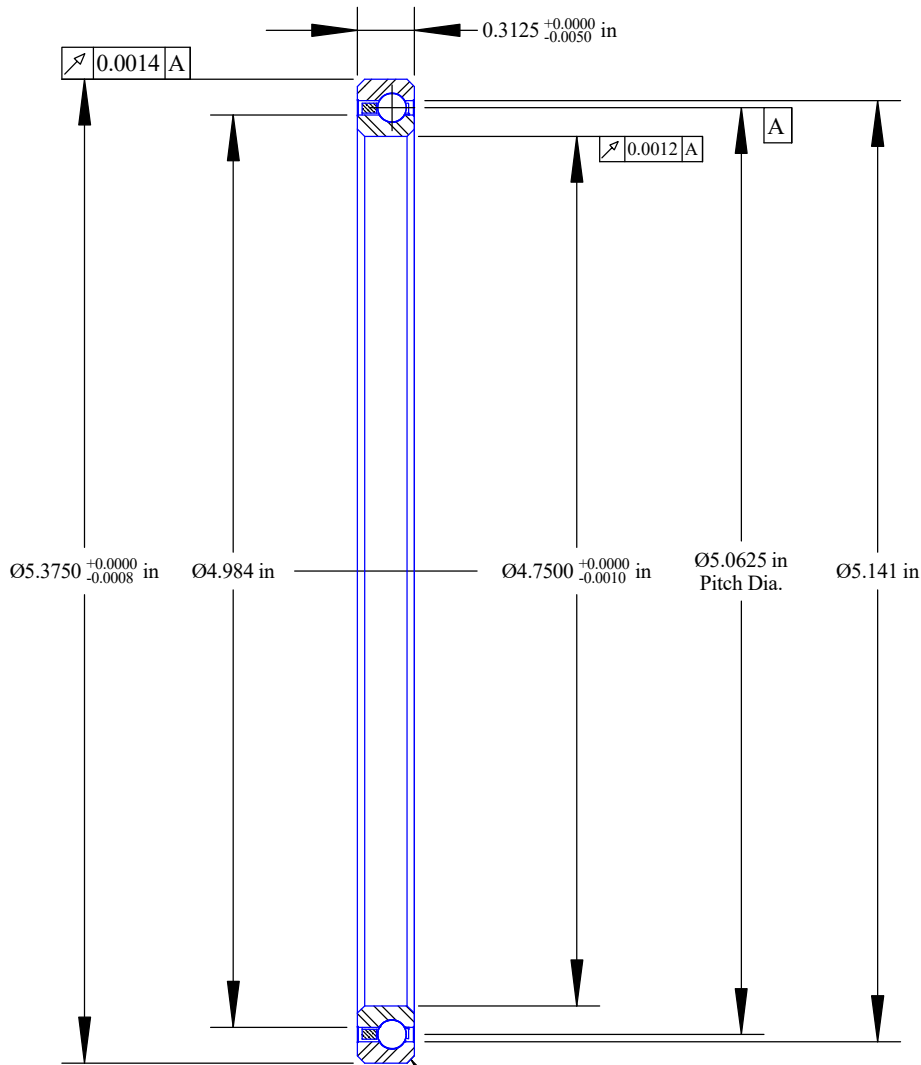

Scale: 1:1
 Will Clear 0.040
 Max. Fillet Radius
 4 Exterior Corners

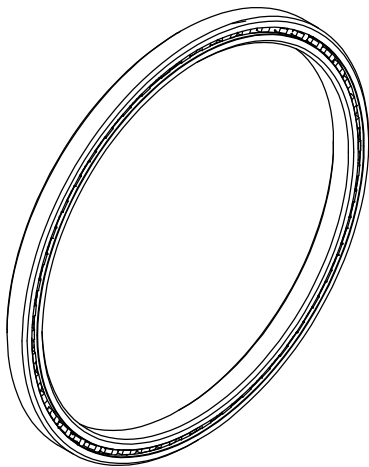

Scale: 0.5:1

	OUTER	INNER	SEPARATOR	BALL
MATERIAL	52100	52100	BRASS	52100
HARDNESS	Rc 59-62	Rc 59-62		
RACE RUN-OUT	OUTER	INNER		
ABEC RATING	PRELOAD		ROLLING ELEMENT	
1	N/A		QUANTITY	SIZE
			50	5/32
RADIAL LOAD	THRUST LOAD		MOMENT LOAD	
DYNAMIC: 901 Lbs. STATIC: 2030 Lbs.	N/A		N/A	
RADIAL PLAY	CONTACT ANGLE		LIMITING SPEED	
0.0020 0.0034	N/A		3,800 RPM	
LUBRICATION	SEAL		BEARING WEIGHT	
LIGHT OIL PRESERVATIVE	N/A		0.34 Lbs.	

UNLESS OTHERWISE SPECIFIED ALL DIMENSIONS IN INCHES



Corporate Headquarters
15151 Prater Drive
Covington, GA 30014
(800) 431-1980
www.ritbearing.com

Designed by ML	Checked by ML	This drawing and the information contained herein are proprietary and the property of Ritbearing Corporation.
-------------------	------------------	---

RB047CP0		Radial Thin Section Ball Bearing
-----------------	--	-------------------------------------

File name RB047CP0	Date May 12, 2017	REVISION A	Sheet 1 of 1
-----------------------	----------------------	---------------	-----------------