

Cage Code: 704Q7

RevNo	Revision note	Date	Signature	Checked
-------	---------------	------	-----------	---------

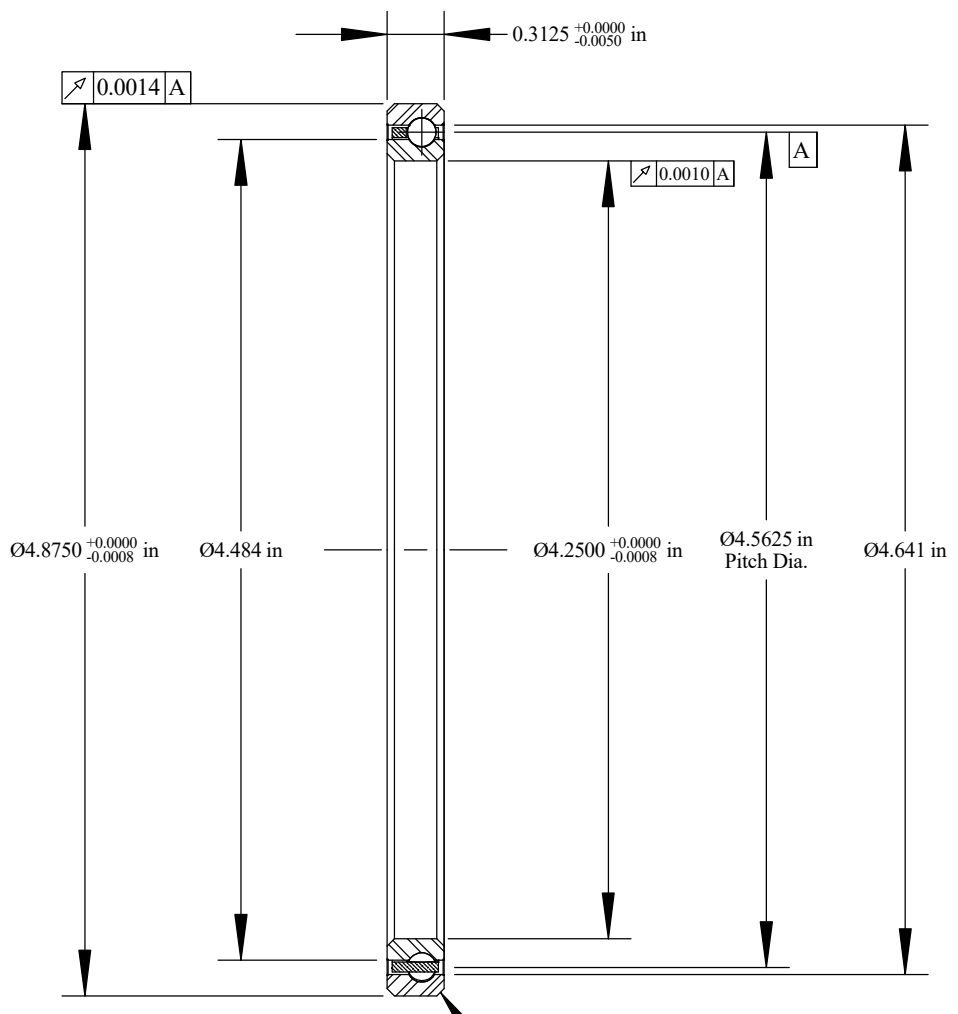

Scale: 1:1  
 Will Clear 0.040  
 Max. Fillet Radius  
 4 Exterior Corners

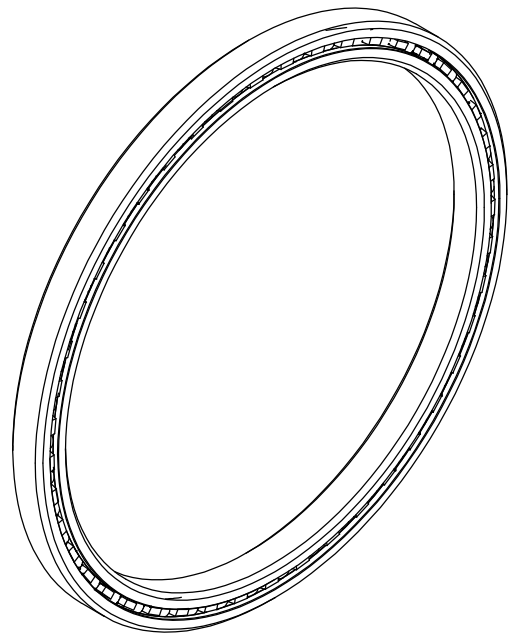

Scale: 0.75:1

	OUTER	INNER	SEPARATOR	BALL
MATERIAL	52100	52100	BRASS	52100
HARDNESS	Rc 59-62	Rc 59-62		
RACE RUN-OUT	OUTER	INNER		
ABEC RATING	PRELOAD		ROLLING ELEMENT	
1	N/A		QUANTITY	SIZE
			45	5/32
RADIAL LOAD	THRUST LOAD		MOMENT LOAD	
DYNAMIC: 846 Lbs. STATIC: 1830 Lbs.	N/A		N/A	
RADIAL PLAY	CONTACT ANGLE		LIMITING SPEED	
0.0016 0.0028	N/A		4,250 RPM	
LUBRICATION	SEAL		BEARING WEIGHT	
LIGHT OIL PRESERVATIVE	N/A		0.31 Lbs.	

UNLESS OTHERWISE SPECIFIED ALL DIMENSIONS IN INCHES

**Corporate Headquarters**  
**15151 Prater Drive**  
**Covington, GA 30014**  
**(800) 431-1980**  
**www.ritbearing.com**

Designed by ML	Checked by ML	This drawing and the information contained herein are proprietary and the property of Ritbearing Corporation.	
<b>RB042CP0</b>		Radial Thin Section Ball Bearing	
File name RB042CP0	Date May 12, 2017	REVISION A	Sheet 1 of 1