

Cage Code: 704Q7

| | | | | |
|-------|---------------|------|-----------|---------|
| RevNo | Revision note | Date | Signature | Checked |
|-------|---------------|------|-----------|---------|

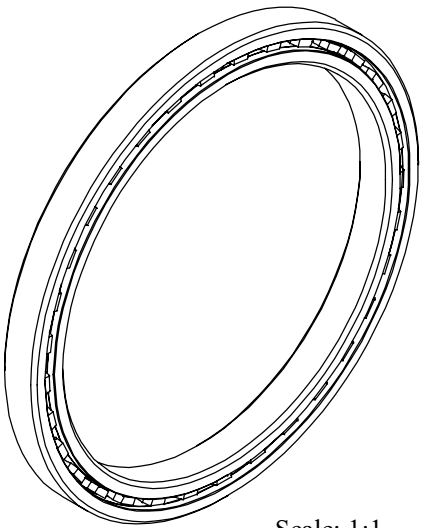
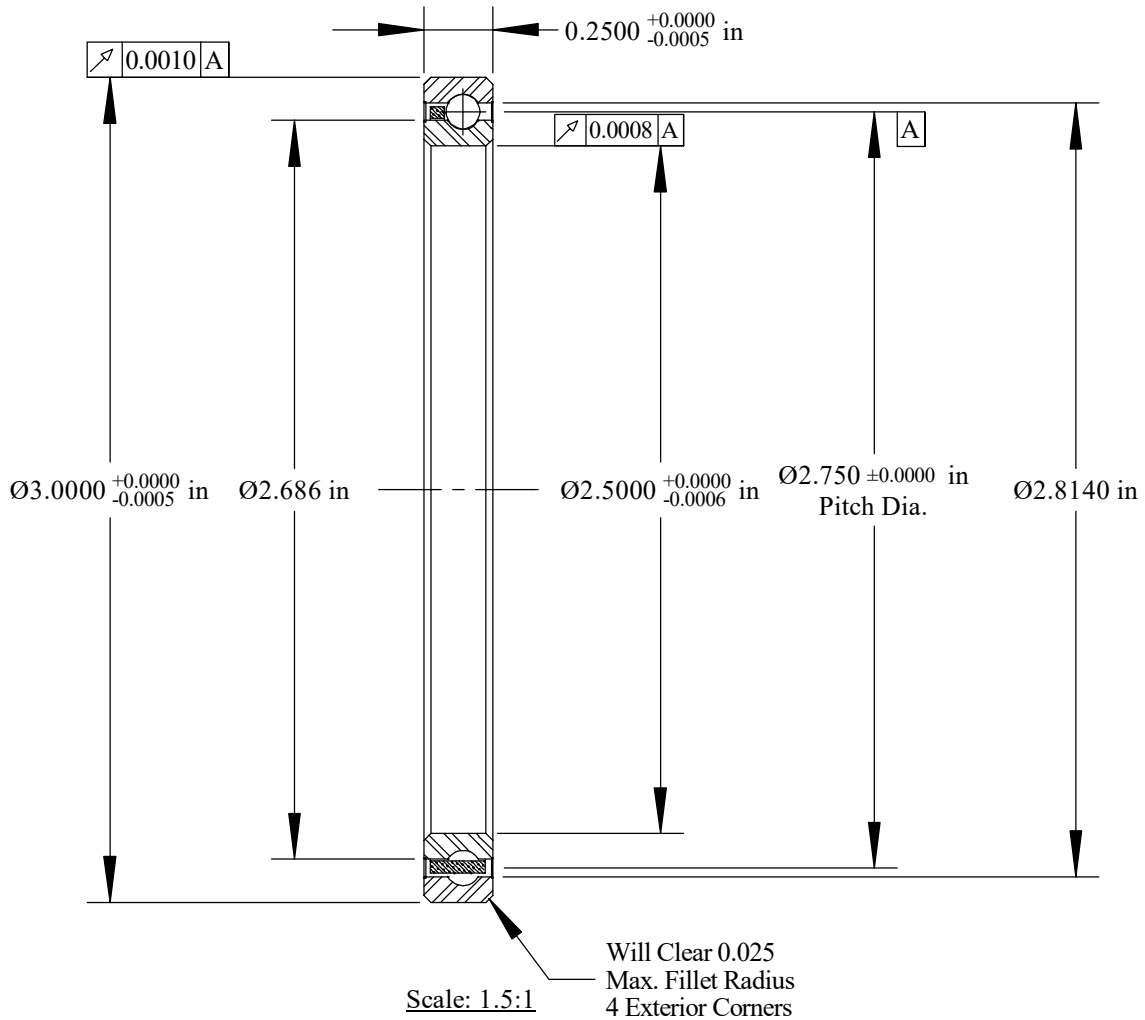

Scale: 1:1

| | | | | |
|---------------------------------------|---------------|----------|-----------------|-------|
| | OUTER | INNER | SEPARATOR | BALL |
| MATERIAL | 52100 | 52100 | BRASS | 52100 |
| HARDNESS | Rc 59-62 | Rc 59-62 | | |
| RACE RUN-OUT | OUTER | INNER | | |
| ABEC RATING | PRELOAD | | ROLLING ELEMENT | |
| 1 | N/A | | QUANTITY | SIZE |
| | | | 33 | 1/8 |
| RADIAL LOAD | THRUST LOAD | | MOMENT LOAD | |
| DYNAMIC: 830 Lbs. STATIC: 442 Lbs. | N/A | | N/A | |
| RADIAL PLAY | CONTACT ANGLE | | LIMITING SPEED | |
| 0.0012 0.0024 | N/A | | 8,400 RPM | |
| LUBRICATION | SEAL | | BEARING WEIGHT | |
| LIGHT OIL PRESERVATIVE | N/A | | 0.13 Lbs. | |

SSB BRAND
thin section bearings

Corporate Headquarters
15151 Prater Drive
Covington, GA 30014
(800) 431-1980
www.ritbearing.com

UNLESS OTHERWISE SPECIFIED ALL DIMENSIONS IN INCHES

| | | | |
|-----------------------|-----------------------|---|-----------------|
| Designed by ML | Checked by ML | This drawing and the information contained herein are proprietary and the property of Ritbearing Corporation. | |
| RA025CP0 | | Radial Thin Section Ball Bearing | |
| File name RA025CP0 | Date March 7, 2017 | REVISION A | Sheet 1 of 1 |